

6. Island Number One, or Boulder Island, whose dimensions are approximately 250 feet N-S and 110 feet E-W; said island rises 8 feet more or less above the water and contains 0.50 acre, more or less. Island Number One lies in the NW 1/4 of the SW 1/4 of Section 9, Township 39 North, Range 4 East, and near the western shore of Squaw Lake, Oneida County. (See attached Map No. 2.)
7. Island Number Two, or South Island, whose dimensions are approximately 120 feet N-S and 120 feet E-W; said island rises 4 feet more or less above the water and contains 0.30 acre, more or less. Island Number Two lies in the NW 1/4 of the NW 1/4 of Section 16, Township 39 North, Range 4 East, and near the western shore of Squaw Lake, Oneida County. (See attached Map No. 2.)
8. Island Number One, or Faun Island, whose dimensions are approximately 330 feet N-S and 300 feet E-W; said island rises 30 feet more or less above the water and contains 1.30 acres, more or less. Island Number One lies in the NE 1/4 of the SE 1/4 of Section 36, Township 39 North, Range 4 East, and near the eastern shore of Pine Lake, Oneida County. (See attached Map No. 3.)
9. Bulrush Island, whose dimensions are approximately 60 feet NW-SE and 190 feet NE-SW; said island rises 8 feet more or less above the water and contains 0.25 acre, more or less. Bulrush Island lies in the E 1/2 of the NW 1/4 of Section 14, Township 38 North, Range 4 East, and near the northeastern shore of Swamsauger Lake, Oneida County. (See attached Map No. 4.)
10. Three Pine Island, whose dimensions are approximately 135 feet N-S and 210 feet E-W; said island rises 8 feet more or less above the water and contains 0.55 acre, more or less. Three Pine Island lies in the NE 1/4 of the NW 1/4 of Section 14, Township 38 North, Range 4 East, and near the northeastern shore of Swamsauger Lake, Oneida County. (See attached Map No. 4.)
11. Island Number One, or Scotty's Island, whose dimensions are approximately 665 feet N-S and 680 feet E-W; said island rises 25 feet more or less above the water and contains 6.40 acres, more or less. Island Number One lies partly in the SW 1/4 of the SW 1/4 of Section 2, Township 39 North, Range 5 East, partly in the SE 1/4 of the SE 1/4 of Section 3, Township 39 North, Range 5 East, and in the southwest one-quarter of Shisebogama Lake, Oneida County. (See attached Map No. 5.)
12. Ivy Island, whose dimensions are approximately 50 feet N-S and 100 feet E-W; said island rises 3 feet more or less above the water and contains 0.10 acre, more or less. Ivy Island lies in the SE 1/4 of the NW 1/4 of Section 8, Township 39 North, Range 5 East, and near the western shore of Squirrel Lake, Oneida County. (See attached Map No. 6.)
13. Lone Rock Island, whose dimensions are approximately 15 feet N-S and 10 feet E-W; said island rises 3 feet more or less above the water and contains 0.003 acre, more or less. Lone Rock Island lies in the NE 1/4 of the NW 1/4 of Section 8, Township 39 North, Range 5 East, and near the eastern shore of Squirrel Lake, Oneida County. (See attached Map No. 6.)

14. North Island, whose dimensions are approximately 185 feet N-S and 230 feet E-W; said island rises 10 feet more or less above the water and contains 0.75 acre, more or less. North Island lies in the NE 1/4 of the SW 1/4 of Section 5, Township 39 North, Range 5 East, and in the northernmost part of Squirrel Lake, Oneida County. (See attached Map No. 6.)
15. Island Number One, or Pine Island, whose dimensions are approximately 460 feet N-S and 300 feet E-W; said island rises 25 feet more or less above the water and contains 1.75 acres, more or less. Island Number One lies in the SW 1/4 of the NW 1/4 of Section 13, Township 39 North, Range 5 East, and near the western shore of Mercer Lake, Oneida County. (See attached Map No. 8.)
16. Island Number Two, or Poplar Island, whose dimensions are approximately 300 feet N-S and 365 feet E-W; said island rises 15 feet more or less above the water and contains 1.70 acres, more or less. Island Number Two lies partly in the SE 1/4 of the NW 1/4 of Section 13, Township 39 North, Range 5 East, partly in the NE 1/4 of the SW 1/4 of Section 13, Township 39 North, Range 5 East, and near the southern shore of Mercer Lake, Oneida County. (See attached Map No. 8.)
17. Bear Island, whose dimensions are approximately 560 feet NW-SE and 325 feet NE-SW; said island rises 10 feet more or less above the water and contains 2.60 acres, more or less. Bear Island lies in the SW 1/4 of the NE 1/4 of Section 16, Township 39 North, Range 5 East, and near the northwestern shore of Franklin Lake, Oneida County. (See attached Map No. 9.)
18. Spruce Island, whose dimensions are approximately 100 feet N-S and 80 feet E-W; said island rises 2 feet more or less above the water and contains 0.20 acre, more or less. Spruce Island lies in the NW 1/4 of the NE 1/4 of Section 16, Township 39 North, Range 5 East, and near the northwestern shore of Franklin Lake, Oneida County. (See attached Map No. 9.)
19. Cub Island, whose dimensions are approximately 180 feet N-S and 160 feet E-W; said island rises 6 feet more or less above the water and contains 0.40 acre, more or less. Cub Island lies in the SE 1/4 of the NE 1/4 of Section 24, Township 38 North, Range 5 East, and near the northeastern shore of Bear Lake, Oneida County. (See attached Map No. 10.)
20. McDonald Island, whose dimensions are approximately 150 feet N-S and 200 feet E-W; said island rises 15 feet more or less above the water and contains 0.50 acre, more or less. McDonald Island lies in the NW 1/4 of the SW 1/4 of Section 3, Township 36 North, Range 5 East, and near the southeastern shore of Burrows Lake, Oneida County. (See attached Map No. 11.)
21. Norway Island, whose dimensions are approximately 200 feet NW-SE and 160 feet NE-SW; said island rises 10 feet more or less above the water and contains 0.45 acre, more or less. Norway Island lies in the E 1/2 of the SE 1/4 of Section 16, Township 39 North, Range 6 East, and in the southern one-half of Kawaguesaga Lake, Oneida County. (See attached Map No. 13.)

22. 6 Pine Island, whose dimensions are approximately 75 feet N-S and 60 feet E-W; said island lies 3 feet more or less above the water and contains 0.10 acre, more or less. 6 Pine Island lies in the NE 1/4 of the NW 1/4 of Section 11, Township 38 North, Range 6 East, and in the eastern one-half of Lake Katherine, Oneida County. (See attached Map No. 14.)
23. Muskeg Island, whose dimensions are approximately 30 feet N-S and 30 feet E-W; said island rises 1 foot more or less above the water and contains 0.02 acre, more or less. Muskeg Island lies in the SW 1/4 of the NE 1/4 of Section 17, Township 38 North, Range 6 East, and near the eastern shore of Lake Seventeen, Oneida County. (See attached Map No. 15.)
24. Island Number One, whose dimensions are approximately 35 feet NW-SE and 130 feet NE-SW; said island rises 5 feet more or less above the water and contains 0.15 acre, more or less. Island Number One lies in the NE 1/4 of the SW 1/4 of Section 17, Township 38 North, Range 6 East, and in the southeastern one-quarter of Lake Seventeen, Oneida County. (See attached Map No. 15.)
25. Island Number Two, whose dimensions are approximately 130 feet NW-SE and 100 feet NE-SW; said island rises 6 feet more or less above the water and contains 0.35 acre, more or less. Island Number Two lies in the NE 1/4 of the SW 1/4 of Section 17, Township 38 North, Range 6 East, and in the southeastern one-quarter of Lake Seventeen, Oneida County. (See attached Map No. 15.)
26. Island Number One, whose dimensions are approximately 240 feet N-S and 475 feet E-W; said island rises 17 feet more or less above the water and contains 1.35 acres, more or less. Island Number One lies partly in the SE 1/4 of the NE 1/4 of Section 11, Township 37 North, Range 6 East, partly in the NE 1/4 of the SE 1/4 of Section 11, Township 37 North, Range 6 East, and in the eastern one-half of Little Bearskin Lake, Oneida County. (See attached Map No. 16.)
27. Island Number Two, whose dimensions are approximately 400 feet NW-SE and 100 feet NE-SW; said island rises 10 feet more or less above the water and contains 0.70 acre, more or less. Island Number Two lies in the NE 1/4 of the SE 1/4 of Section 11, Township 37 North, Range 6 East, and in the eastern one-half of Little Bearskin Lake, Oneida County. (See attached Map No. 16.)
28. Island Number Three, whose dimensions are approximately 150 feet N-S and 340 feet E-W; said island rises 9 feet more or less above the water and contains 0.85 acre, more or less. Island Number Three lies in the NW 1/4 of the SE 1/4 of Section 11, Township 37 North, Range 6 East, and in the southwestern one-quarter of Little Bearskin Lake, Oneida County. (See attached Map No. 16.)
29. Spruce Island, or Island Number One, whose dimensions are approximately 120 feet N-S and 120 feet E-W; said island rises 8 feet more or less above the water and contains 0.25 acre, more or less. Spruce Island lies partly in the SE 1/4 of the NE 1/4 of Section 14, Township 37 North, Range 6 East, partly in the NE 1/4 of the SE 1/4 of Section 14, Township 37 North, Range 6 East, and near the eastern shore of Currie Lake, Oneida County. (See attached Map No. 17.)

30. Pine Island, or Island Number Two, whose dimensions are approximately 265 feet N-S and 100 feet E-W; said island rises 9 feet more or less above the water and contains 0.50 acre, more or less. Pine Island lies in the NE 1/4 of the SE 1/4 of Section 14, Township 37 North, Range 6 East, and in the southern one-half of Currie Lake, Oneida County. (See attached Map No. 17.)
31. Balsam Island, whose dimensions are approximately 150 feet NW-SE and 265 feet NE-SW; said island rises 7 feet more or less above the water and contains 0.80 acre, more or less. Balsam Island lies partly in the SE 1/4 of the SE 1/4 of Section 5, Township 39 North, Range 7 East, partly in the NE 1/4 of the NE 1/4 of Section 8, Township 39 North, Range 7 East, and in the southwestern one-quarter of Carrol Lake, Oneida County. (See attached Map No. 18.)
32. West Island, whose dimensions are approximately 340 feet NW-SE and 400 feet NE-SW; said island rises 10 feet more or less above the water and contains 1.85 acres, more or less. West Island lies partly in the SE 1/4 of the SE 1/4 of Section 5, Township 39 North, Range 7 East, partly in the NE 1/4 of the NE 1/4 of Section 8, Township 39 North, Range 7 East, and in the southwest one-quarter of Carrol Lake, Oneida County. (See attached Map No. 18.)
33. Oak Island, whose dimensions are approximately 275 feet N-S and 175 feet E-W; said island rises 10 feet more or less above the water and contains 1.00 acre, more or less. Oak Island lies partly in the SW 1/4 of the SW 1/4 of Section 4, Township 39 North, Range 7 East, partly in the SE 1/4 of the SE 1/4 of Section 5, Township 39 North, Range 7 East, and in the western one-half of Carrol Lake, Oneida County. (See attached Map No. 18.)
34. Turtle Island, whose dimensions are approximately 725 feet N-S and 265 feet E-W; said island rises 30 feet more or less above the water and contains 3.00 acres, more or less. Turtle Island lies in the NW 1/4 of the SE 1/4 of Section 4, Township 39 North, Range 7 East, and in the eastern one-half of Carrol Lake, Oneida County. (See attached Map No. 18.)
35. Farm Island, whose dimensions are approximately 475 feet NW-SE and 265 feet E-W; said island rises 25 feet more or less above the water and contains 2.70 acres, more or less. Farm Island lies in the NE 1/4 of the SW 1/4 of Section 5, Township 39 North, Range 7 East, and near the western shore of Madeline Lake, Oneida County. (See attached Map No. 19.)
36. Spruce Island, or Jacobs Island, whose dimensions are approximately 120 feet N-S and 90 feet E-W; said island rises 15 feet more or less above the water and contains 0.20 acre, more or less. Spruce Island lies in the NE 1/4 of the SE 1/4 of Section 11, Township 39 North, Range 7 East, and in the northwestern one-quarter of Buffalo Lake, Oneida County. (See attached Map No. 20.)

37. Cabin Island, or White Birch Island, whose dimensions are approximately 265 feet NW-SE and 430 feet NE-SW; said island rises 8 feet more or less above the water and contains 2.30 acres, more or less. Cabin Island lies in the SE 1/4 of the SE 1/4 of Section 15, Township 39 North, Range 7 East, and near the middle of Sweeney Lake, Oneida County. (See attached Map No. 21.)
38. Knob Island, whose dimensions are approximately 175 feet N-S and 175 feet E-W; said island rises 9 feet more or less above the water and contains 0.45 acre, more or less. Knob Island lies in the SE 1/4 of the NW 1/4 of Section 24, Township 39 North, Range 7 East, and near the western shore of Gilmore Lake, Oneida County. (See attached Map No. 22.)
39. Balsam Island, whose dimensions are approximately 65 feet NW-SE and 40 feet NE-SW; said island rises 6 feet more or less above the water and contains 0.06 acre, more or less. Balsam Island lies in the SE 1/4 of the NW 1/4 of Section 5, Township 38 North, Range 7 East, and in the southeastern one-quarter of Tomahawk Lake, Oneida County. (See attached Map No. 24.)
40. Crescent Island, whose dimensions are approximately 35 feet NW-SE and 725 feet NE-SW; said island rises 5 feet more or less above the water and contains 0.25 acre, more or less. Crescent Island lies in the SW 1/4 of the NE 1/4 of Section 5, Township 38 North, Range 7 East, and in the southeastern one-quarter of Tomahawk Lake, Oneida County. (See attached Map No. 24.)
41. Dead Pine Island, whose dimensions are approximately 40 feet N-S and 20 feet E-W; said island rises 2 feet more or less above the water and contains 0.02 acre, more or less. Dead Pine Island lies in the NW 1/4 of the NW 1/4 of Section 5, Township 38 North, Range 7 East, and in the southeastern one-quarter of Tomahawk Lake, Oneida County. (See attached Map No. 24.)
42. High Island, whose dimensions are approximately 330 feet N-S and 550 feet E-W; said island rises 30 feet more or less above the water and contains 2.50 acres, more or less. High Island lies in the NE 1/4 of the NW 1/4 of Section 5, Township 38 North, Range 7 East, and in the southeastern one-quarter of Tomahawk Lake, Oneida County. (See attached Map No. 24.)
43. Hughston Island, whose dimensions are approximately 300 feet N-S and 165 feet E-W; said island rises 6 feet more or less above the water and contains 0.80 acre, more or less. Hughston Island lies in the E 1/2 of the NW 1/4 of Section 5, Township 38 North, Range 7 East, and in the southeastern one-quarter of Tomahawk Lake, Oneida County. (See attached Map No. 24.)
44. Island Number Two, or South Island, whose dimensions are approximately 115 feet NW-SE and 100 feet NE-SW; said island rises 4 feet more or less above the water and contains 0.25 acre, more or less. Island Number Two lies in the SE 1/4 of the SW 1/4 of Section 16, Township 38 North, Range 7 East, and near the western shore of South Two Lake, Oneida County. (See attached Map No. 26.)

45. Seed Island, whose dimensions are approximately 85 feet N-S and 100 feet E-W; said island rises 4 feet more or less above the water and contains 0.07 acre, more or less. Seed Island lies in the SW 1/4 of the SW 1/4 of Section 32, Township 38 North, Range 7 East, and in the northeastern one-quarter of Seed Lake, Oneida County. (See attached Map No. 29.)
46. Lone Island, whose dimensions are approximately 130 feet N-S and 100 feet E-W; said island rises 7 feet more or less above the water and contains 0.25 acre, more or less. Lone Island lies partly in the SW 1/4 of the NE 1/4 of Section 33, Township 38 North, Range 7 East; partly in the NW 1/4 of the SE 1/4 of Section 33, Township 38 North, Range 7 East; and in the northern one-half of Lumen Lake, Oneida County. (See attached Map No. 30.)
47. White Birch Island, whose dimensions are approximately 100 feet N-S and 140 feet E-W; said island rises 2 feet more or less above the water and contains 0.20 acre, more or less. White Birch Island lies in the NE 1/4 of the SW 1/4 of Section 10, Township 37 North, Range 7 East, and near the western shore of Alva Lake, Oneida County. (See attached Map No. 31.)
48. Squirrel Island, whose dimensions are approximately 140 feet N-S and 135 feet E-W; said island rises 9 feet more or less above the water and contains 0.50 acre, more or less. Squirrel Island lies partly in the SE 1/4 of the SW 1/4 of Section 13, Township 37 North, Range 7 East; partly in the NE 1/4 of the NW 1/4 of Section 24, Township 37 North, Range 7 East; and in the eastern one-half of Maud Lake, Oneida County. (See attached Map No. 32.)
49. Muskrat Island, whose dimensions are approximately 200 feet N-S and 200 feet E-W; said island rises 6 feet more or less above the water and contains 0.65 acre, more or less. Muskrat Island lies in the NW 1/4 of the NW 1/4 of Section 24, Township 37 North, Range 7 East, and in the western one-half of Maud Lake, Oneida County. (See attached Map No. 32.)
50. Three Stumps Island, whose dimensions are approximately 40 feet N-S and 50 feet E-W; said island rises 4 feet more or less above the water and contains 0.07 acre, more or less. Three Stumps Island lies in the SW 1/4 of the SW 1/4 of Section 4, Township 36 North, Range 7 East, and in the eastern one-half of Oneida Lake, Oneida County. (See attached Map No. 33.)
51. Fournier's Island, whose dimensions are approximately 475 feet NW-SE and 265 feet NE-SW; said island rises 25 feet more or less above the water and contains 1.85 acres, more or less. Fournier's Island lies partly in the SW 1/4 of the SW 1/4 of Section 4, Township 36 North, Range 7 East; partly in the SE 1/4 of the SE 1/4 of Section 5, Township 36 North, Range 7 East; partly in the NE 1/4 of the NE 1/4 of Section 8, Township 36 North, Range 7 East; and near the southwestern shore of Oneida Lake, Oneida County. (See attached Map No. 33.)

52. Tamarack Island, whose dimensions are approximately 65 feet NW-SE and 50 feet NE-SW; said island rises 3 feet more or less above the water and contains 0.05 acre, more or less. Tamarack Island lies in the NW 1/4 of the SW 1/4 of Section 7, Township 36 North, Range 7 East, and in the southern one-half of Oscar Jenny Lake, Oneida County. (See attached Map No. 34.)
53. Spruce Island, whose dimensions are approximately 300 feet NW-SE and 120 feet NE-SW; said island rises 3 feet more or less above the water and contains 0.60 acre, more or less. Spruce Island lies in the NW 1/4 of the SW 1/4 of Section 7, Township 36 North, Range 7 East, and near the western shore of Oscar Jenny Lake, Oneida County. (See attached Map No. 34.)
54. South Island, whose dimensions are approximately 275 feet N-S and 220 feet E-W; said island rises 3 feet more or less above the water and contains 1.00 acre, more or less. South Island lies in the W 1/2 of the SW 1/4 of Section 7, Township 36 North, Range 7 East, and in the southernmost part of Oscar Jenny Lake, Oneida County. (See attached Map No. 34.)
55. Low Island, whose dimensions are approximately 40 feet N-S and 40 feet E-W; said island rises 3 feet more or less above the water and contains 0.02 acre, more or less. Low Island lies in the NE 1/4 of the SE 1/4 of Section 16, Township 38 North, Range 8 East, and in the northwestern one-half of Brown Lake, Oneida County. (See attached Map No. 37.)
56. Pine Island, whose dimensions are approximately 100 feet NW-SE and 225 feet NE-SW; said island rises 10 feet more or less above the water and contains 0.55 acre, more or less. Pine Island lies in the NE 1/4 of the SE 1/4 of Section 16, Township 38 North, Range 8 East, and in the northwestern one-half of Brown Lake, Oneida County. (See attached Map No. 37.)
57. South Island, whose dimensions are approximately 135 feet NW-SE and 225 feet NE-SW; said island rises 5 feet more or less above the water and contains 0.65 acre, more or less. South Island lies in the NE 1/4 of the SE 1/4 of Section 16, Township 38 North, Range 8 East, and near the southwestern shore of Brown Lake, Oneida County. (See attached Map No. 37.)
58. Ellis Island, whose dimensions are approximately 725 feet N-S and 400 feet E-W; said island rises 11 feet more or less above the water and contains 4.75 acres, more or less. Ellis Island lies in the NW 1/4 of the NE 1/4 of Section 19, Township 38 North, Range 8 East, and near the northern shore of the western body of Two Sisters Lake, Oneida County. (See attached Map No. 38.)
59. Coon Island, whose dimensions are approximately 120 feet N-S and 75 feet E-W; said island rises 5 feet more or less above the water and contains 0.15 acre, more or less. Coon Island lies in the NE 1/4 of the NE 1/4 of Section 19, Township 37 North, Range 8 East, and near the northeastern shore of Coon Lake, Oneida County. (See attached Map No. 40.)

60. Shack Island, whose dimensions are approximately 125 feet N-S and 100 feet E-W; said island rises 15 feet more or less above the water and contains 0.30 acre, more or less. Shack Island lies in the N 1/2 of the SE 1/4 of Section 28, Township 37 North, Range 8 East, and in the northern one-quarter of Flannery Lake, Oneida County. (See attached Map No. 42.)
61. Lone Pine Island, whose dimensions are approximately 50 feet N-S and 15 feet E-W; said island rises 2 feet more or less above the water and contains 0.02 acre, more or less. Lone Pine Island lies in the SW 1/4 of the SE 1/4 of Section 28, Township 37 North, Range 8 East, and near the western shore of Flannery Lake, Oneida County. (See attached Map No. 42.)
62. Brush Island, whose dimensions are approximately 65 feet N-S and 30 feet E-W; said island rises 3 feet more or less above the water and contains 0.03 acre, more or less. Brush Island lies in the NW 1/4 of the NE 1/4 of Section 33, Township 37 North, Range 8 East, and near the western shore of Flannery Lake, Oneida County. (See attached Map No. 42.)
63. Campfire Island, whose dimensions are approximately 100 feet NW-SE and 200 feet NE-SW; said island rises 3 feet more or less above the water and contains 0.35 acre, more or less. Campfire Island lies in the N 1/2 of the NW 1/4 of Section 17, Township 36 North, Range 8 East, and in the northwestern one-quarter of Crescent Lake, Oneida County. (See attached Map No. 44.)
64. Pine Island, whose dimensions are approximately 140 feet NW-SE and 275 feet NE-SW; said island rises 6 feet more or less above the water and contains 0.80 acre, more or less. Pine Island lies in the SE 1/4 of the SW 1/4 of Section 21, Township 36 North, Range 8 East, and in the southwestern one-quarter of Emma Lake, Oneida County. (See attached Map No. 45.)
65. Pine Island, whose dimensions are approximately 230 feet N-S and 125 feet E-W; said island rises 10 feet more or less above the water and contains 0.65 acre, more or less. Pine Island lies in the NE 1/4 of the SE 1/4 of Section 12, Township 36 North, Range 8 East, and in the northern one-quarter of Lake Julia, Oneida County. (See attached Map No. 46.)
66. Tamarack Island, whose dimensions are approximately 100 feet N-S and 40 feet E-W; said island rises 3 feet more or less above the water and contains 0.08 acre, more or less. Tamarack Island lies in the SE 1/4 of the SE 1/4 of Section 12, Township 36 North, Range 8 East, and near the western shore of Lake Julia, Oneida County. (See attached Map No. 46.)
67. Squash Island, whose dimensions are approximately 560 feet N-S and 500 feet E-W; said island rises 10 feet more or less above the water and contains 3.20 acres, more or less. Squash Island lies partly in the SE 1/4 of the NW 1/4 of Section 1, Township 38 North, Range 9 East; partly in the W 1/2 of the NE 1/4 of Section 1, Township 38 North, Range 9 East; and in the western one-quarter of Indian Lake, Oneida County. (See attached Map No. 47.)

68. Balsam Island, whose dimensions are approximately 185 feet N-S and 200 feet E-W; said island rises 6 feet more or less above the water and contains 0.50 acre, more or less. Balsam Island lies in the SW 1/4 of the NE 1/4 of Section 1, Township 38 North, Range 9 East, and in the western one-quarter of Indian Lake, Oneida County. (See attached Map No. 47.)
69. Point Island, whose dimensions are approximately 300 feet N-S and 230 feet E-W; said island rises 12 feet more or less above the water and contains 1.10 acres, more or less. Point Island lies in the SE 1/4 of the NE 1/4 of Section 1, Township 38 North, Range 9 East, and near a peninsula of the southern shore of Indian Lake, Oneida County. (See attached Map No. 47.)
70. Swamp Island, whose dimensions are approximately 200 feet N-S and 160 feet E-W; said island rises 3 feet more or less above the water and contains 0.50 acre, more or less. Swamp Island lies in the NE 1/4 of the SE 1/4 of Section 3, Township 36 North, Range 9 East, and near the western shore of Thompson Lake, Oneida County. (See attached Map No. 48.)
71. Squirrel Island, whose dimensions are approximately 90 feet N-S and 230 feet E-W; said island rises 7 feet more or less above the water and contains 0.40 acre, more or less. Squirrel Island lies in the NW 1/4 of the SW 1/4 of Section 2, Township 36 North, Range 9 East, and near the northern shore of Thompson Lake, Oneida County. (See attached Map No. 48.)
72. Camp Island, whose dimensions are approximately 150 feet N-S and 300 feet E-W; said island rises 11 feet more or less above the water and contains 1.00 acre, more or less. Camp Island lies in the NE 1/4 of the SW 1/4 of Section 2, Township 36 North, Range 9 East, and in the western one-half of Thompson Lake, Oneida County. (See attached Map No. 48.)
73. Long Island, whose dimensions are approximately 560 feet N-S and 250 feet E-W; said island rises 15 feet more or less above the water and contains 1.50 acres, more or less. Long Island lies in the W 1/2 of the SW 1/4 of Section 14, Township 36 North, Range 9 East, and in the southwestern one-quarter of Lake George, Oneida County. (See attached Map No. 49.)
74. Spring Island, whose dimensions are approximately 80 feet N-S and 45 feet E-W; said island rises 4 feet more or less above the water and contains 0.10 acre, more or less. Spring Island lies in the SW 1/4 of the SW 1/4 of Section 14, Township 36 North, Range 9 East, and in the southwestern one-quarter of Lake George, Oneida County. (See attached Map No. 49.)
75. Kuney's Island, or Island Number Five, whose dimensions are approximately 400 feet N-S and 465 feet E-W; said island rises 12 feet more or less above the water and contains 1.75 acres, more or less. Kuney's Island lies in the NW 1/4 of the NE 1/4 of Section 15, Township 38 North, Range 10 East, and in the southwestern one-quarter of Thunder Lake, Oneida County. (See attached Map No. 50.)

76. Island Number One, or Squash Island, whose dimensions are approximately 200 feet N-S and 75 feet E-W; said island rises 8 feet more or less above the water and contains 0.35 acre, more or less. Island Number One lies in the SE 1/4 of the NW 1/4 of Section 15, Township 38 North, Range 10 East, and in the southwestern one-quarter of Thunder Lake, Oneida County. (See attached Map No. 50.)
77. Island Number Two, or Beaver Island, whose dimensions are approximately 100 feet N-S and 175 feet E-W; said island rises 10 feet more or less above the water and contains 0.35 acre, more or less. Island Number Two lies in the NW 1/4 of the SW 1/4 of Section 15, Township 38 North, Range 10 East, and near the southwestern shore of Thunder Lake, Oneida County. (See attached Map No. 50.)
78. Island Number Three, or Rock Island, whose dimensions are approximately 100 feet N-S and 100 feet E-W; said island rises 7 feet more or less above the water and contains 0.25 acre, more or less. Island Number Three lies in the SW 1/4 of the SW 1/4 of Section 14, Township 38 North, Range 10 East, and in the southeastern one-quarter of Thunder Lake, Oneida County. (See attached Map No. 50.)
79. Brush Island, whose dimensions are approximately 65 feet N-S and 75 feet E-W; said island rises 1 foot more or less above the water and contains 0.10 acre, more or less. Brush Island lies in the SW 1/4 of the SW 1/4 of Section 14, Township 38 North, Range 10 East, and in the southeastern one-quarter of Thunder Lake, Oneida County. (See attached Map No. 50.)
80. Stella Island, whose dimensions are approximately 220 feet NW-SE and 60 feet NE-SW; said island rises 2 feet more or less above the water and contains 0.20 acre, more or less. Stella Island lies in the E 1/2 of the SW 1/4 of Section 1, Township 37 North, Range 10 East, and near the northern shore of Stella Lake, Oneida County. (See attached Map No. 51.)
81. Pelican Island, whose dimensions are approximately 625 feet N-S and 625 feet E-W; said island rises 20 feet more or less above the water and contains 5.20 acres, more or less. Pelican Island lies partly in the SE 1/4 of the SW 1/4 of Section 33, Township 37 North, Range 10 East; partly in the NE 1/4 of the NW 1/4 of Section 4, Township 36 North, Range 10 East; and near the northern shore of Fifth Lake, Oneida County. (See attached Map No. 52.)
82. Pine Island, whose dimensions are approximately 500 feet N-S and 300 feet E-W; said island rises 7 feet more or less above the water and contains 2.50 acres, more or less. Pine Island lies in the NW 1/4 of the NW 1/4 of Section 14, Township 38 North, Range 11 East, and in the southern one-third of Virgin Lake, Oneida County. (See attached Map No. 56.)
83. Seven Pine Island, whose dimensions are approximately 75 feet N-S and 330 feet E-W; said island rises 4 feet more or less above the water and contains 0.40 acre, more or less. Seven Pine Island lies in the NE 1/4 of the SE 1/4 of Section 27, Township 38 North, Range 11 East, and near the western shore of Crooked Lake, Oneida County. (See attached Map No. 57.)

84. Bear Island, whose dimensions are approximately 235 feet N-S and 180 feet E-W; said island rises 3 feet more or less above the water and contains 0.65 acre, more or less. Bear Island lies partly in the NW 1/4 of the SW 1/4 of Section 3, Township 37 North, Range 11 East; partly in the NE 1/4 of the SE 1/4 of Section 4, Township 37 North, Range 11 East; and near the western shore of Margaret Lake, Oneida County. (See attached Map No. 58.)
85. Long Island, whose dimensions are approximately 50 feet N-S and 175 feet E-W; said island rises 3 feet more or less above the water and contains 0.20 acre, more or less. Long Island lies in the NW 1/4 of the SW 1/4 of Section 19, Township 37 North, Range 11 East, and in the northern one-third of Ginty Lake, Oneida County. (See attached Map No. 59.)
86. East Island, whose dimensions are approximately 30 feet N-S and 30 feet E-W; said island rises 1 foot more or less above the water and contains 0.02 acre, more or less. East Island lies in the NW 1/4 of the SW 1/4 of Section 19, Township 37 North, Range 11 East, and in the northern one-third of Ginty Lake, Oneida County. (See attached Map No. 59.)
87. Alder Island, whose dimensions are approximately 135 feet NW-SE and 70 feet NE-SW; said island rises 3 feet more or less above the water and contains 0.20 acre, more or less. Alder Island lies partly in the SE 1/4 of the NW 1/4 of Section 19, Township 36 North, Range 11 East; partly in the NE 1/4 of the SW 1/4 of Section 19, Township 36 North, Range 11 East; and near the eastern shore of Neptune Lake, Oneida County. (See attached Map No. 60.)
88. Loomis Island, whose dimensions are approximately 800 feet N-S and 400 feet E-W; said island rises 40 feet more or less above the water and contains 4.85 acres, more or less. Loomis Island lies in the NE 1/4 of the SE 1/4 of Section 8, Township 37 North, Range 7 East, and near the southern shore of Hancock Lake, Oneida County. (See attached Map No. 62.)
89. Loon's Nest Island, whose dimensions are approximately 175 feet NW-SE and 100 feet NE-SW; said island rises 7 feet more or less above the water and contains 0.30 acre, more or less. Loon's Nest Island lies in the SW 1/4 of the SW 1/4 of Section 33, Township 36 North, Range 7 East, and near the southern shore of Manson Lake, Oneida County. (See attached Map No. 64.)
90. Marshall Island, whose dimensions are approximately 500 feet N-S and 140 feet E-W; said island rises 12 feet more or less above the water and contains 1.10 acres more or less. Marshall Island lies in the SE 1/4 of the SE 1/4 of Section 13, Township 36 North, Range 7 East, and in the northern one-quarter of Squash Lake, Oneida County. (See attached Map No. 63.)
91. Scrub Oak Island, whose dimensions are approximately 125 feet NW-SE and 60 feet NE-SW; said island rises 5 feet more or less above the water and contains 0.15 acre, more or less. Scrub Oak Island lies in the SE 1/4 of the NW 1/4 of Section 24, Township 36 North, Range 7 East, and near the southwestern shore of Squash Lake, Oneida County. (See attached Map No. 63.)

That the purpose of this affidavit is to identify the ninety-one above-described islands as islands which were granted to the State of Wisconsin by the United States Government on August 22, 1912, by 37 Stat. 324, which in part provides:

"That the unsurveyed and unattached islands in inland lakes north of the township line between townships thirty-three and thirty-four north, in the State of Wisconsin, be, and the same are hereby granted to the State of Wisconsin as additions to that state's forest reserves."

That therefore the State of Wisconsin is the owner in fee simple of the above-described islands.

The omission of any island descriptions of other islands in the lakes stated in this affidavit is in no way to be construed as a relinquishment of any rights or interest the State of Wisconsin may have in islands not described in this affidavit.

In witness whereof, said affiant has hereunto set his hand and seal this 5th day of JUNE, 1975.

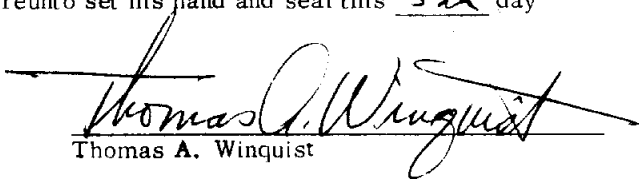
Thomas A. Winqvist

Subscribed and sworn to before me this 5th day of JUNE, 1975.

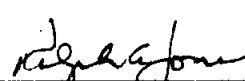
Ralph A. Jones, Notary Public
Oneida County, State of Wisconsin
My commission expires October 15, 1978.

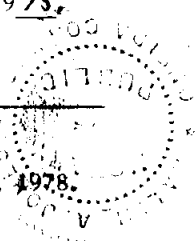

Index of Lakes and Islands, Oneida County,
 Contained in Affidavit of Ownership
 Dated JUNE 5, 1975

<u>Lake</u>	<u>Island</u>	<u>Location</u>			<u>Paragraph Number</u>	<u>Map No.</u>
		<u>Sec.</u>	<u>T</u>	<u>R</u>		
Alva	White Birch	10	37N	7E	47	31
Bear	Cub	24	38N	5E	19	10
Brown	Low	16	38N	8E	55	37
	Pine	16	38N	8E	56	37
	South	16	38N	8E	57	37
Buckskin	No. 1	2	39N	4E	1	1
	No. 2	1	39N	4E	2	1
	No. 3	1	39N	4E	3	1
	No. 4	1	39N	4E	4	1
	No. 5	12	39N	4E	5	1
Buffalo	Spruce	11	39N	7E	36	20
Burrows	McDonald	3	36N	5E	20	11
Carrol	Balsam	5,8	39N	7E	31	18
	West	5,8	39N	7E	32	18
	Oak	4,5	39N	7E	33	18
	Turtle	4	39N	7E	34	18
Coon	Coon	19	37N	8E	59	40
Crescent	Campfire	17	36N	8E	63	44
Crooked	Seven Pine	27	38N	11E	83	57
Currie	Spruce	14	37N	6E	29	17
	Pine	14	37N	6E	30	17
Emma	Pine	21	36N	8E	64	45
Fifth	Pelican	(4	36N	10E	81	52
		(33	37N	10E		
Flannery	Shack	28	37N	8E	60	42
	Lone Pine	28	37N	8E	61	42
	Brush	33	37N	8E	62	42

Index of Lakes and Islands, Oneida County

2.

<u>Lake</u>	<u>Island</u>	<u>Location</u>			<u>Paragraph Number</u>	<u>Map No.</u>
		<u>Sec.</u>	<u>T</u>	<u>R</u>		
Franklin	Bear	16	39N	5E	17	9
	Spruce	16	39N	5E	18	9
George	Long	14	36N	9E	73	49
	Spring	14	36N	9E	74	49
Gilmore	Knob	24	39N	7E	38	22
Ginty	Long	19	37N	11E	85	59
	East	19	37N	11E	86	59
Hancock	Loomis	8	37N	7E	88	62
Indian	Squash	1	38N	9E	67	47
	Balsam	1	38N	9E	68	47
	Point	1	38N	9E	69	47
Julia	Pine	12	36N	8E	65	46
	Tamarack	12	36N	8E	66	46
Katherine	6 Pine	11	38N	6E	22	14
Kawaguesaga	Norway	16	39N	6E	21	13
Little Bearskin	No. 1	11	37N	6E	26	16
	No. 2	11	37N	6E	27	16
	No. 3	11	37N	6E	28	16
Lumen	Lone	33	38N	7E	46	30
Madeline	Farm	5	39N	7E	35	19
Manson	Loon's Nest	33	36N	7E	89	64
Margaret	Bear	3,4	37N	11E	84	58
Maud	Squirrel	13,24	37N	7E	48	32
	Muskrat	24	37N	7E	49	32
Mercer	No. 1	13	39N	5E	15	8
	No. 2	13	39N	5E	16	8
Neptune	Alder	19	36N	11E	87	60

Index of Lakes and Islands, Oneida County

Lake	Island	Location			Paragraph Number	Map No.
		Sec.	T	R		
Oneida	Three Stumps	4	36N	7E	50	33
	Fournier's	7,8	36N	7E	51	33
Oscar Jenny	Tamarack	7	36N	7E	52	34
	Spruce	7	36N	7E	53	34
	South	7	36N	7E	54	34
Pine	No. 1	36	39N	4E	8	3
Seed	Seed	32	38N	7E	45	29
Seventeen	Muskeg	17	38N	6E	23	15
	No. 1	17	38N	6E	24	15
	No. 2	17	38N	6E	25	15
Shisebogama	No. 1	2,3	39N	5E	11	5
South Two	No. 2	16	38N	7E	44	26
Squash	Marshall	13	36N	7E	90	63
	Scrub Oak	24	36N	7E	91	63
Squaw	No. 1	9	39N	4E	6	2
	No. 2	16	39N	4E	7	2
Squirrel	Ivy	8	39N	5E	12	6
	Lone Rock	8	39N	5E	13	6
	North	5	39N	5E	14	6
Stella	Stella	1	37N	10E	80	51
Swamsauger	Bulrush	14	38N	4E	9	4
	Three Pine	14	38N	4E	10	4
Sweeney	Cabin	15	39N	7E	37	21
Thompson	Swamp	3	36N	9E	70	48
	Squirrel	2	36N	9E	71	48
	Camp	2	36N	9E	72	48
Thunder	Kuney's	15	38N	10E	75	50
	No. 1	15	38N	10E	76	50
	No. 2	15	38N	10E	77	50
	No. 3	14	38N	10E	78	50
	Brush	14	38N	10E	79	50

Index of Lakes and Islands, Oneida County

4.

<u>Lake</u>	<u>Island</u>	<u>Location</u>			<u>Paragraph Number</u>	<u>Map No.</u>
		<u>Sec.</u>	<u>T</u>	<u>R</u>		
Tomahawk	Balsam	5	38N	7E	39	24
	Crescent	5	38N	7E	40	24
	Dead Pine	5	38N	7E	41	24
	High	5	38N	7E	42	24
	Hughston	5	38N	7E	43	24
Two Sisters	Ellis	19	38N	8E	58	38
Virgin	Pine	14	38N	11E	82	56

~~VOL. 74-1000~~

BUCKSKIN LAKE

ONEIDA COUNTY

SECS. 1, 2, 11, 12
SECS. 35, 36

T 39N - R 4E
T 40N - R 4E

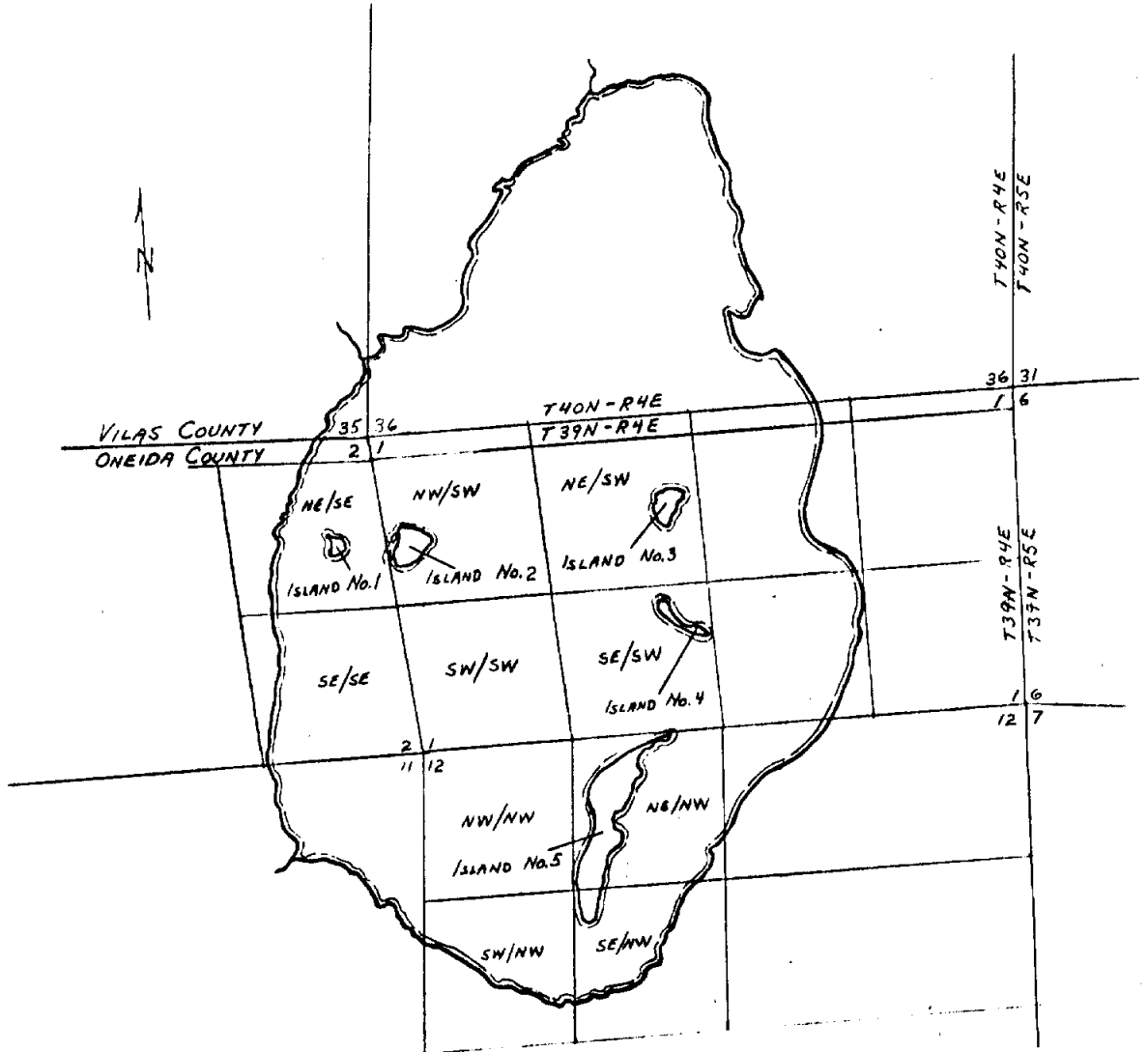

Csm 8-74

FROM AERIAL PHOTOS TAKEN IN 1972.

MAP No. 1

SQUAW LAKE

ONEIDA COUNTY

SECS. 4, 8, 9, 16, 17
SEC. 33

T39N-R4E
T40N-R4E

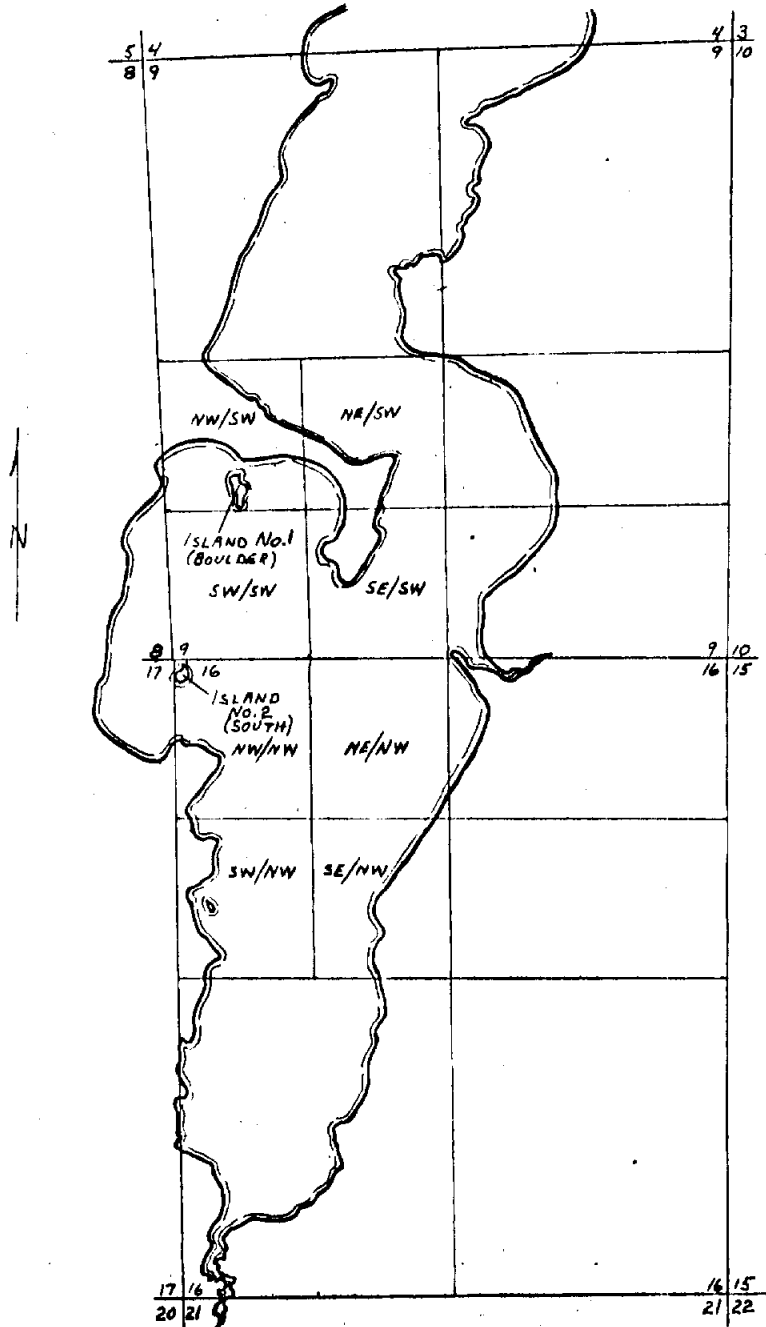

VOL 363 PAGE 619

Conn 8-74

FROM AERIAL PHOTOS TAKEN IN 1972.

MAP No. 2

VOL. 20, PAGE 100

PINE LAKE

ONEIDA COUNTY

SEC. 36 T39N-R4E
SEC. 31 T39N-R5E

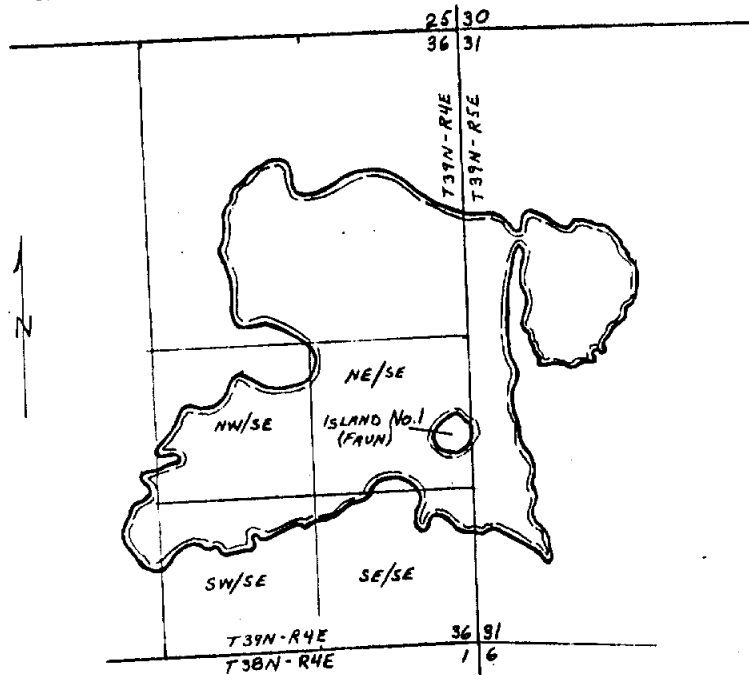

Csm 8-74

FROM AERIAL PHOTOS TAKEN IN 1972.

MAP No. 3

SWAMSAUGER LAKE

ONEIDA COUNTY

SECS. 10, 11, 14

T38N-R4E

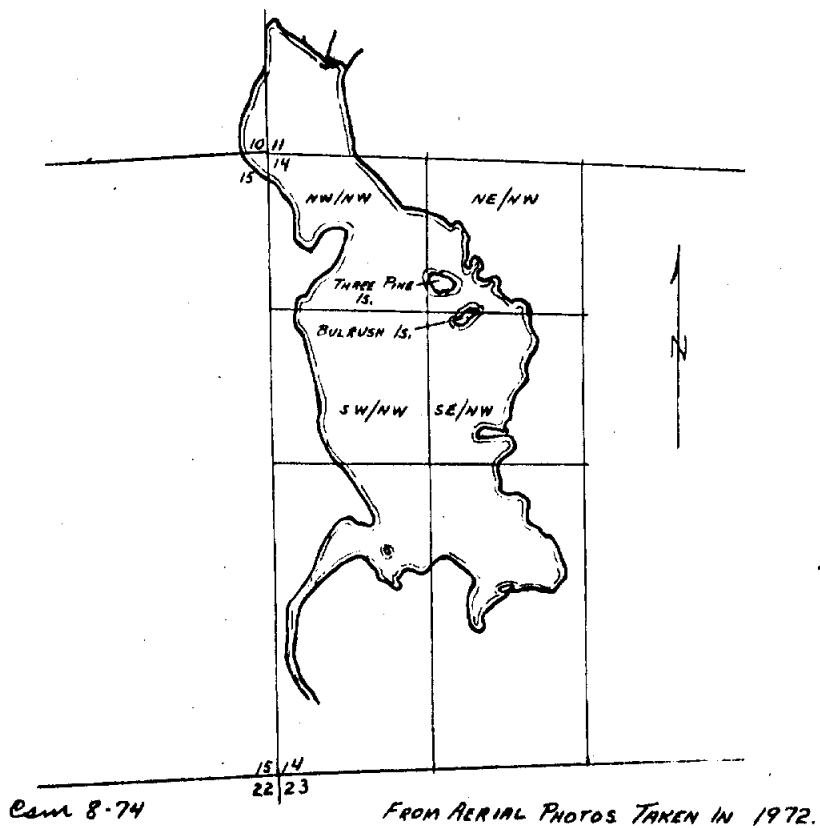

Cam 8-74

FROM AERIAL PHOTOS TAKEN IN 1972.

VOL 363 PAGE 621

AM. A. B. V. 1/1/83

ONEIDA - VILAS COUNTIES

SHISEBOGAMA LAKE

SECS. 1, 2, 3, 10, 11
SECS. 35, 36

T39N-R5E
T40N-R5E

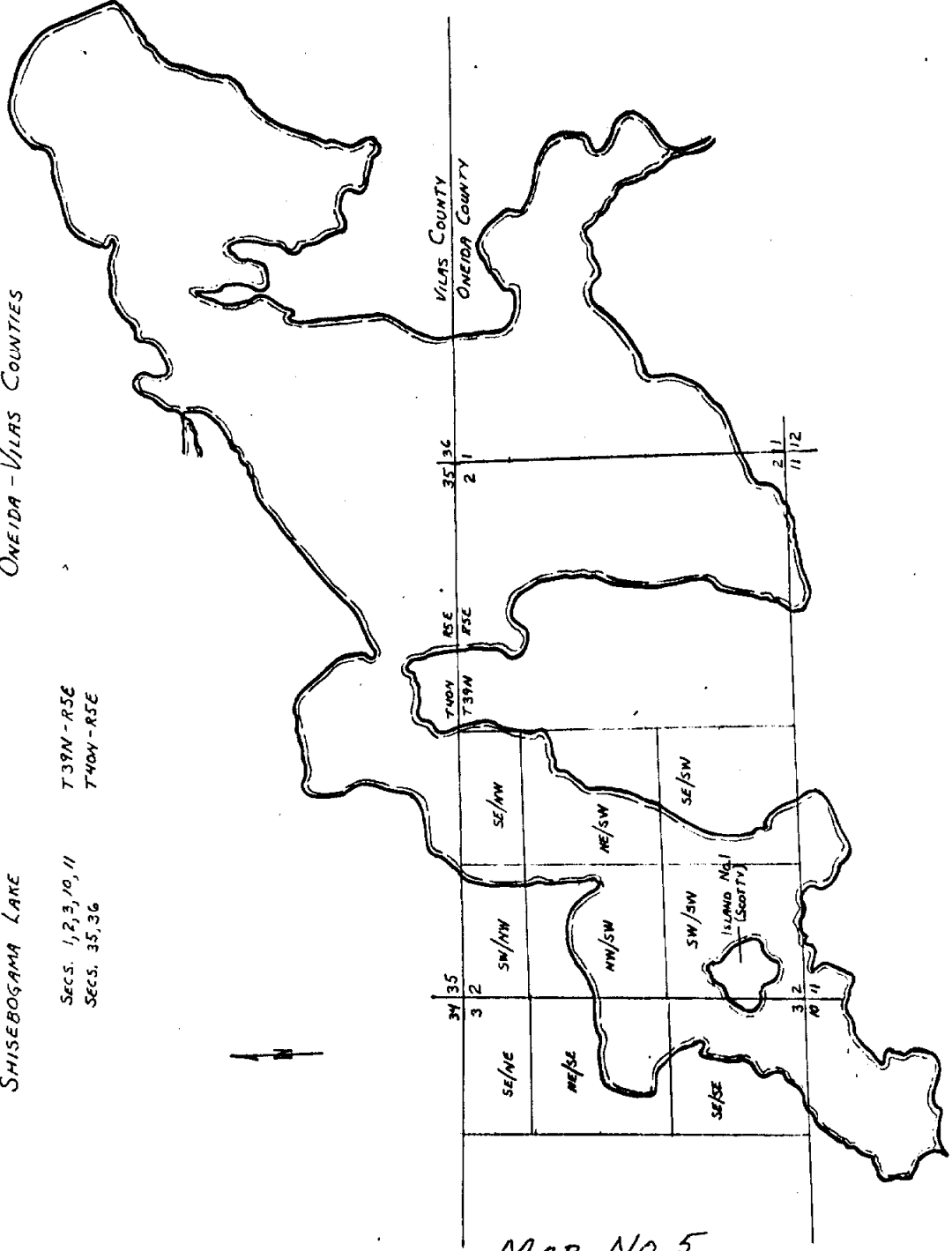

MAP No. 5

FROM AERIAL PHOTOS TAKEN IN 1972

COM 9-74

SQUIRREL LAKE

ONEIDA AND VILAS COUNTIES

SECS. 5, 8, 9, 16, 17, 18, 20, 30 T39N-R5E
SEC. 32 T40N-R5E

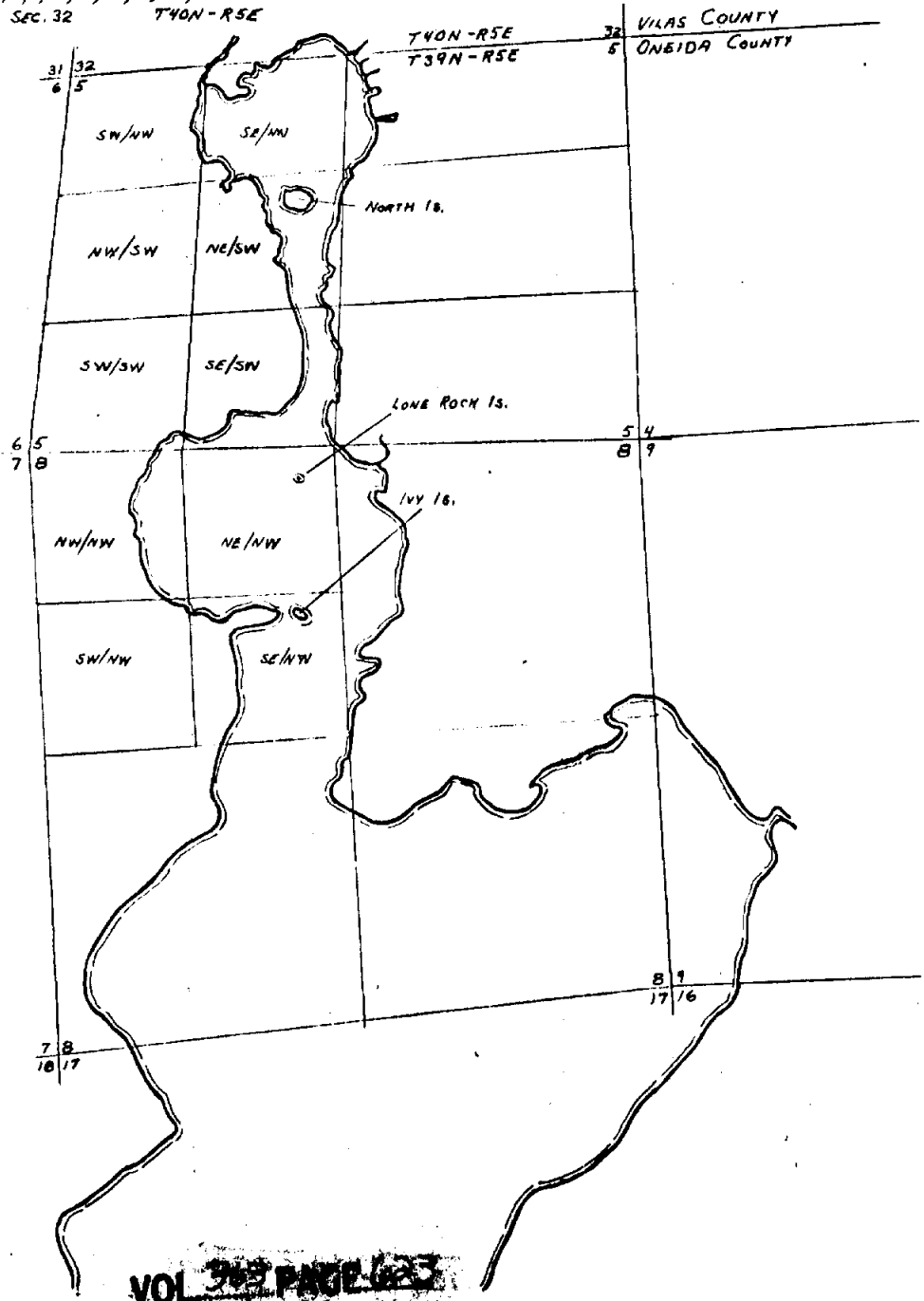

VOL 302 PAGE 623

Cam B-74. Aerial Photos Taken in 1972

VOLUME 100-224

MERCER LAKE

ONEIDA COUNTY

SECS. 13, 14 T39N-R5E

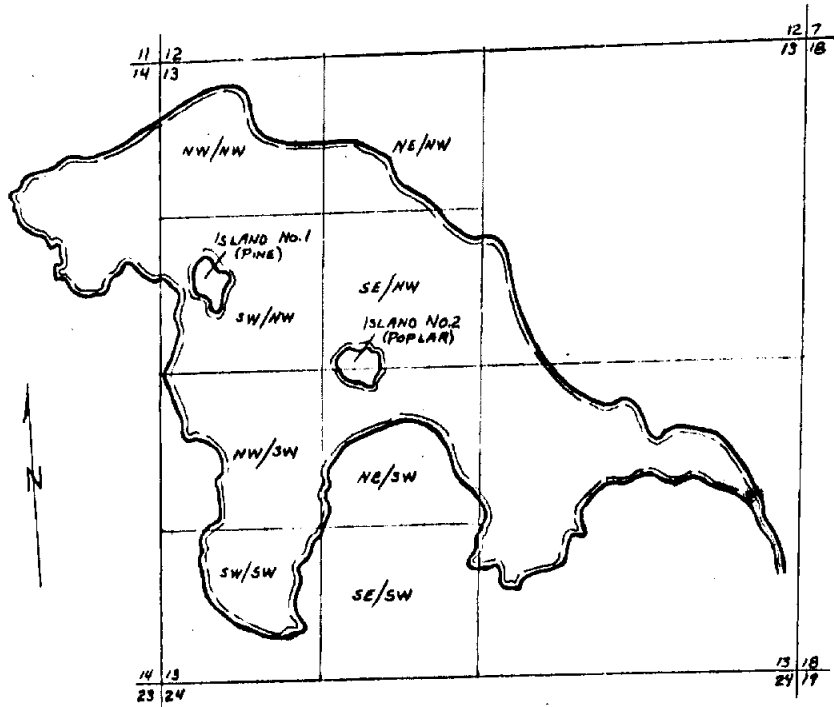

CSM 8-74

FROM AERIAL PHOTOS TAKEN IN 1972

MAP No. 8

FRANKLIN LAKE

ONEIDA COUNTY

Secs. 15, 16 T39N-R5E

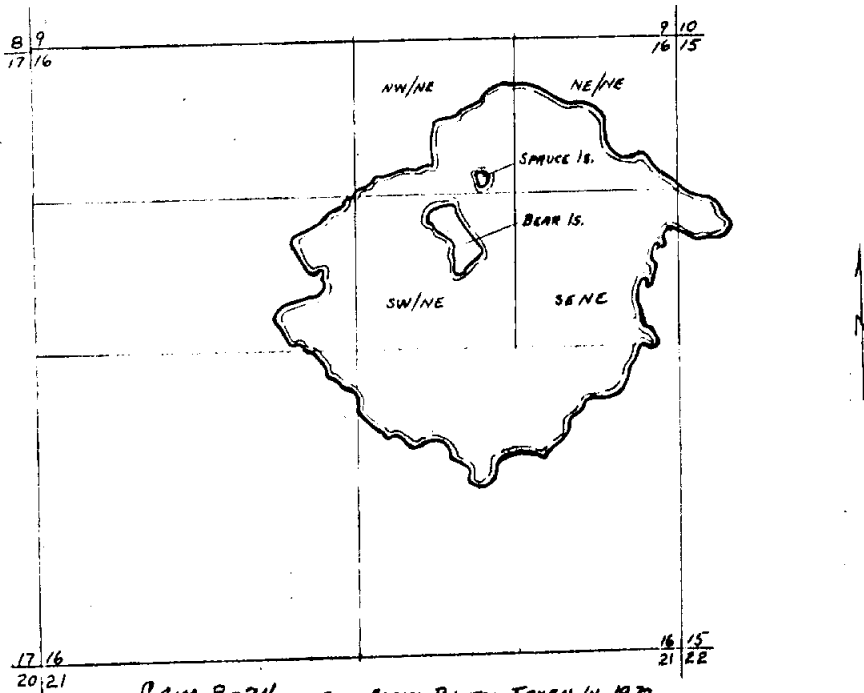

VOL 363 PAGE 625

MAP No. 9

BEAR LAKE ONEIDA COUNTY

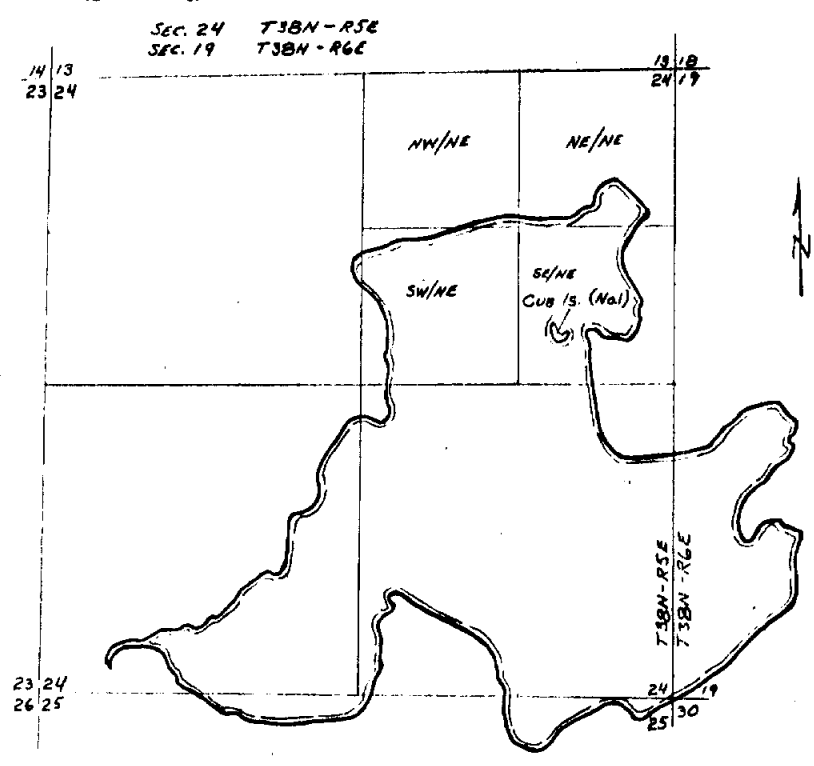

Cam 9-74

FROM AERIAL PHOTOS TAKEN IN 1972.

MAP No. 10

BURROWS LAKE

ONEIDA COUNTY

SECS. 3, 4 T36N-R5E

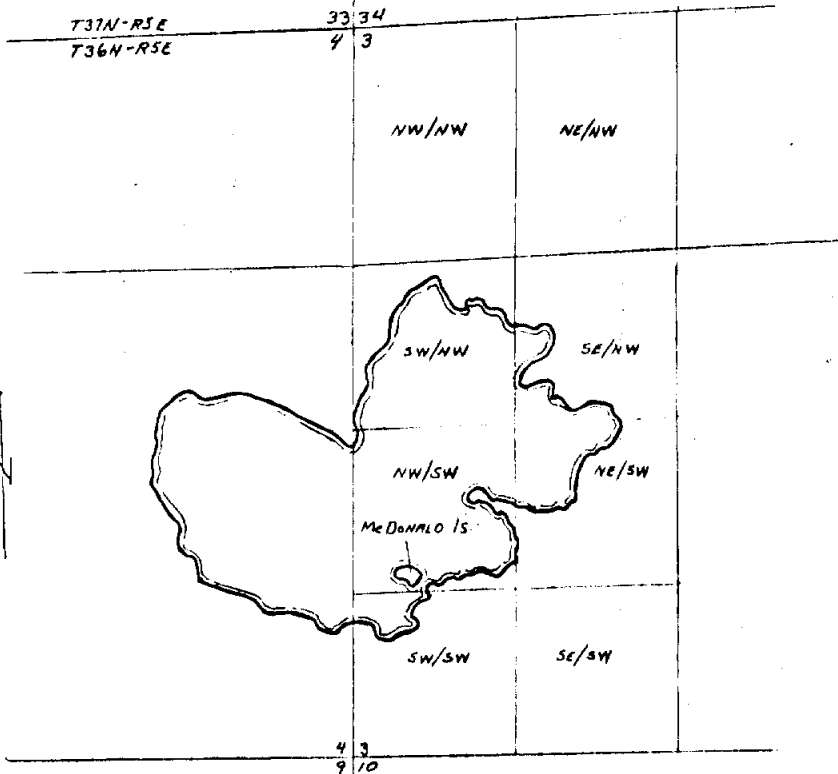

Cont 9-74

FROM AERIAL PHOTOS TAKEN IN 1972

VOL 363 PAGE 627

MAP No. 11

KAWAGUESAGA (KENASOKOGAN) LAKE

ONEIDA COUNTY

SECS. 9, 10, 15, 16, 21, 22

T39N - R6E

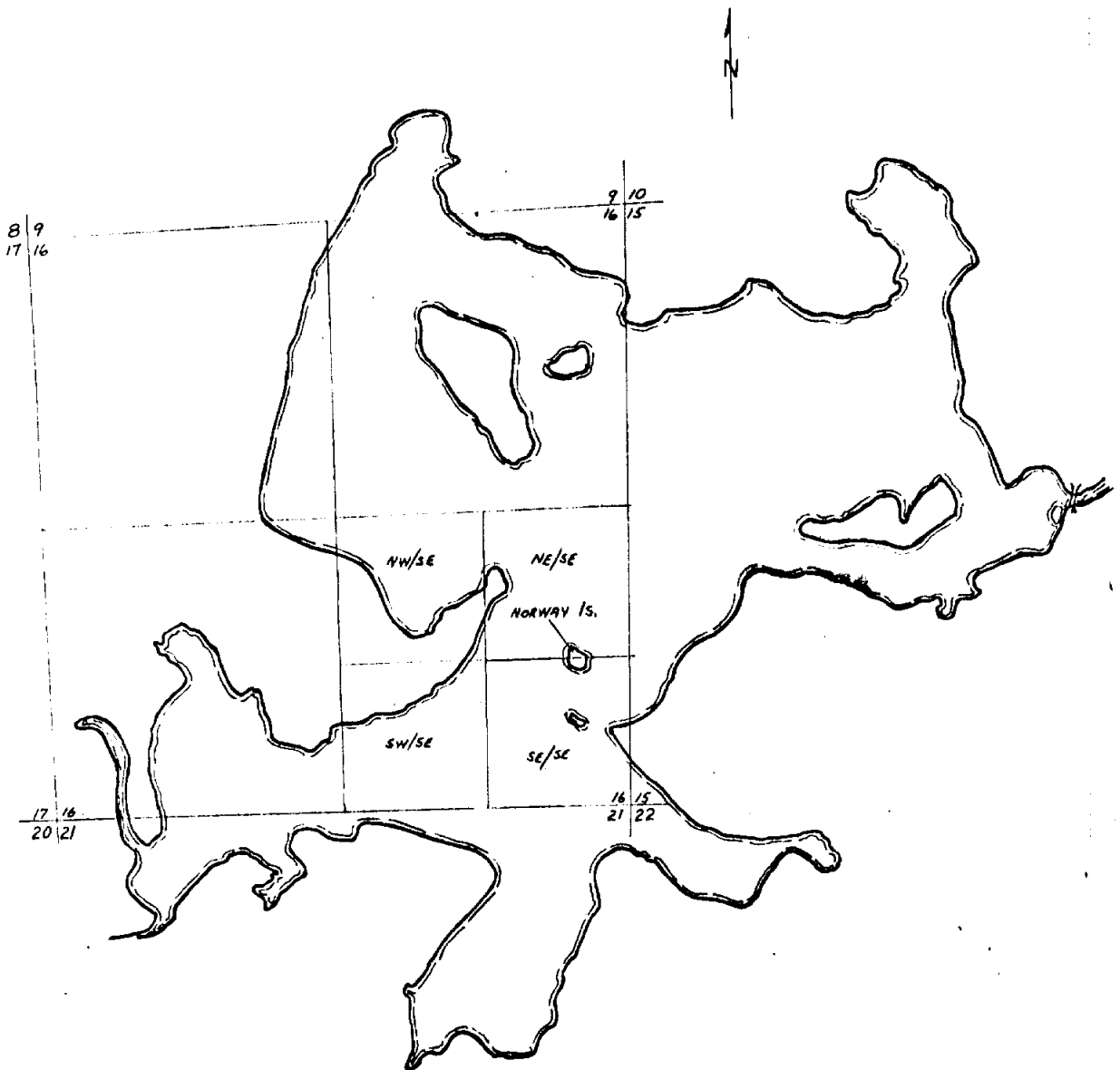

Csm 9-74

FROM AERIAL PHOTOS TAKEN IN 1972

MAP No. 13

LAKE KATHERINE

ONEIDA COUNTY

SECS. 2, 3, 10, 11, 14, 15 T38N-R6E

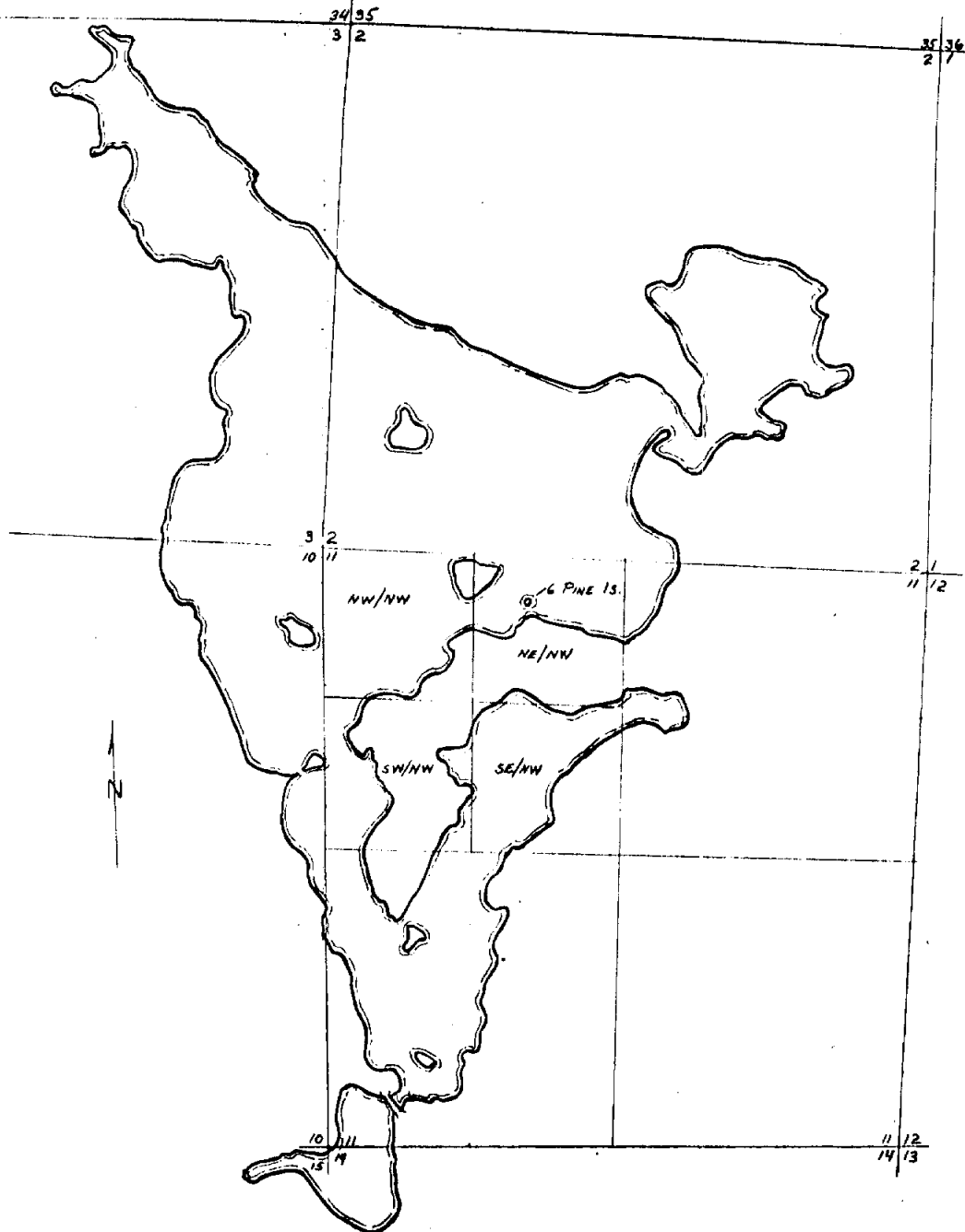

Csm 9-74

FROM AERIAL PHOTOS TAKEN IN 1972

MAP NO. 14 VOL 363 PAGE 629

LAKE SEVENTEEN

ONEIDA COUNTY

SECS. 8, 17, 18 T38N-R6E

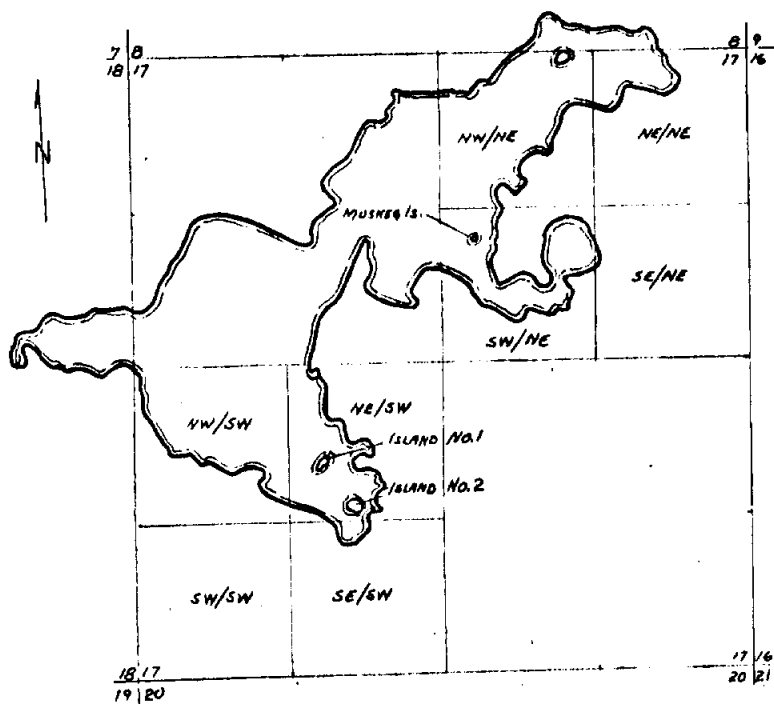

Cam 9-24

FROM AERIAL PHOTOS TAKEN IN 1972

MAP No. 15

LITTLE BEARSKIN LAKE
SECS. 11, 12 T37N-R6E

ONEIDA COUNTY

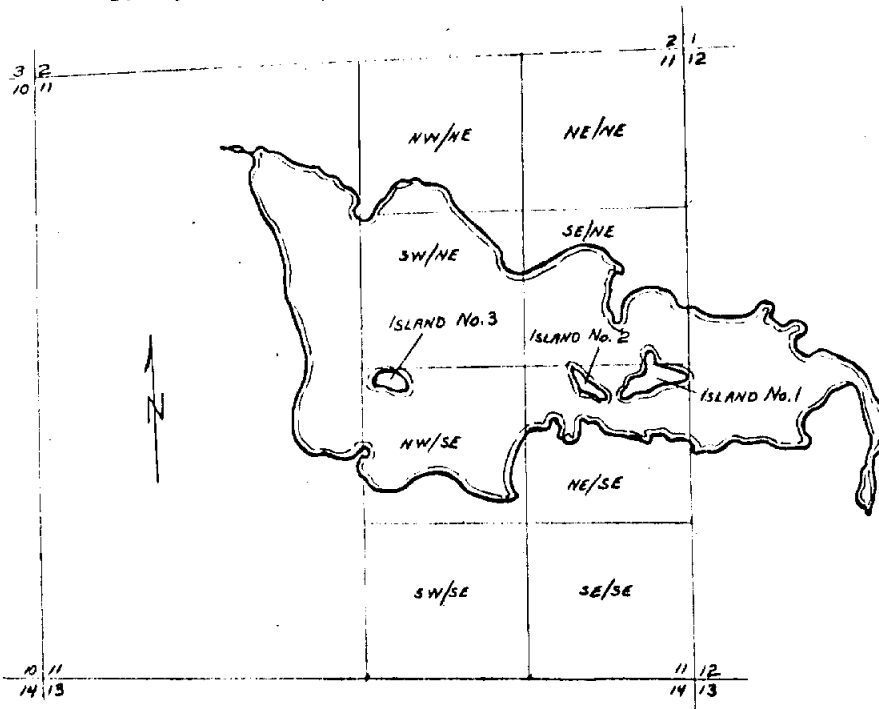

Cam 9-74

FROM AERIAL PHOTOS TAKEN IN 1972.

~~VOL 363 PAGE 631~~

MAP No. 16

CURRIE LAKE

ONEIDA COUNTY

SECS. 13, 14 T37N-R6E

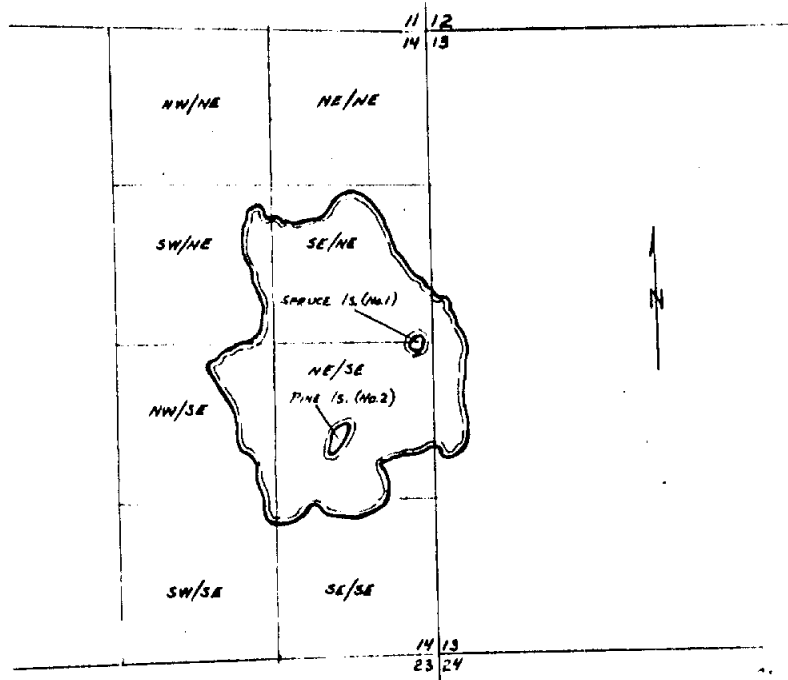

Conn 9-74

FROM AERIAL PHOTOS TAKEN IN 1972

MAP. No. 17

CARROL LAKE

ONEIDA & VILAS COUNTIES

SECS. 4, 5, 8, 9 T39N-R7E
SECS. 33, 34 T40N-R7E

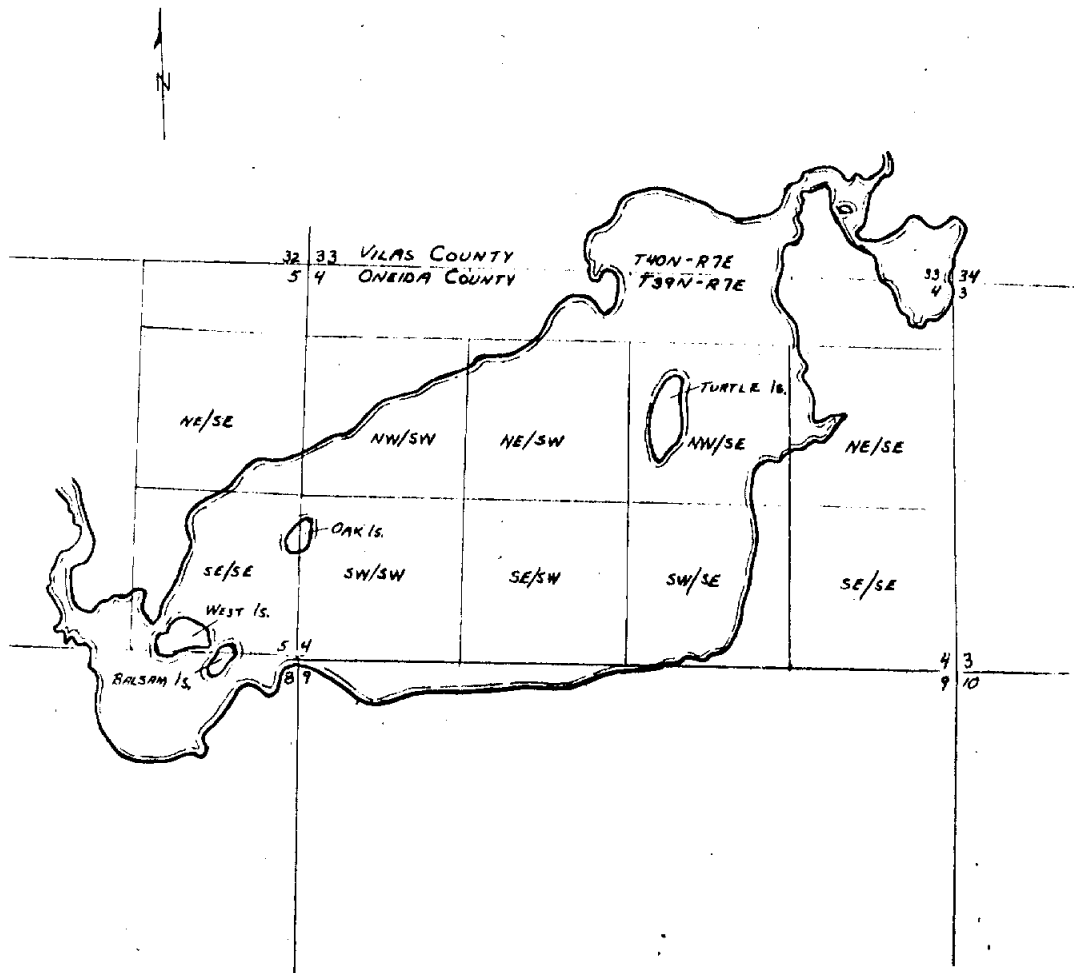

VOL 363 PAGE 633

Cam 9-74

FROM AERIAL PHOTOS TAKEN IN 1972.

Map No. 15

MADLINE LAKE

ONEIDA AND VILAS COUNTIES

SECS. 5 & 32 T40N-R7E
SECS. 32 T40N-R7E

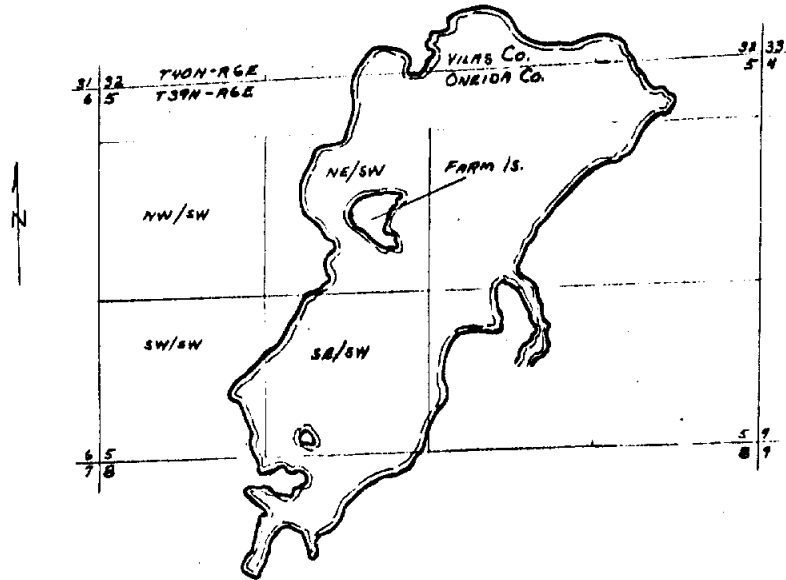

CAM 9-74

FROM AERIAL PHOTOS TAKEN IN 1972

MAP No. 19

BUFFALO LAKE

ONEIDA COUNTY

SECS. 11, 12, 13, 14 T39N-R7E

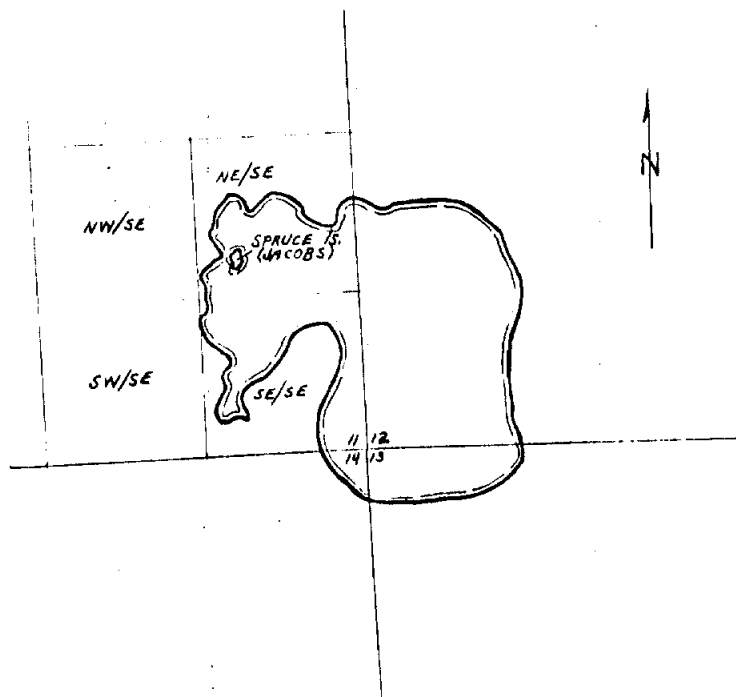

CAM 10-74

FROM AERIAL PHOTOS TAKEN IN 1972

VOL 363 PAGE 635

MAP No. 20

SWEENEY LAKE

ONEIDA COUNTY

SECS. 14, 15, 22, 23

T39N-R7E

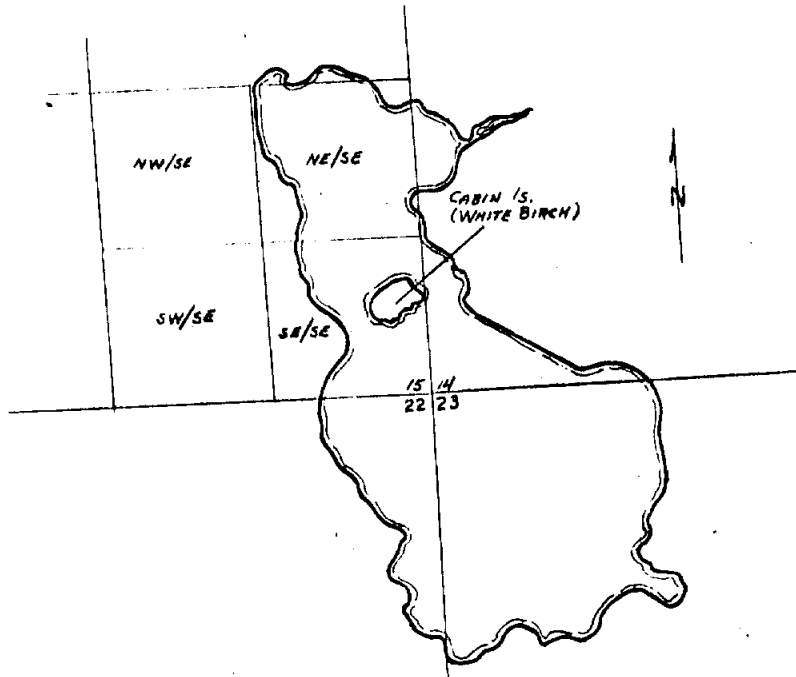

CSM 10-74

FROM AERIAL PHOTOS TAKEN IN 1972.

MAP NO. 21

GILMORE LAKE

ONEIDA COUNTY

SECS. 13, 24 T39N-R7E

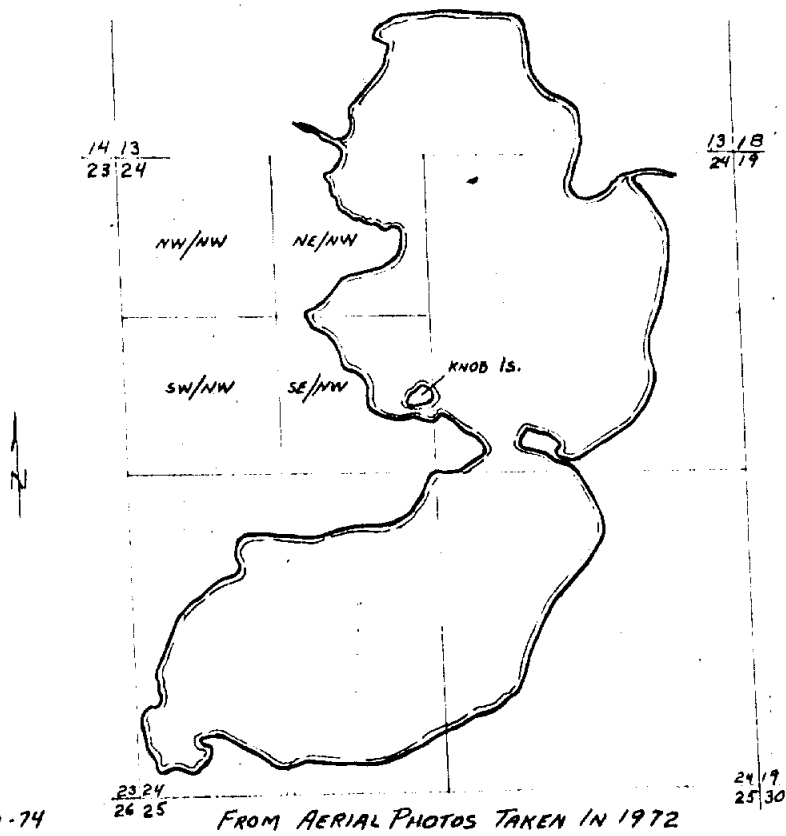

Cam 10-74

FROM AERIAL PHOTOS TAKEN IN 1972

VOL 363 PAGE 637
MAP No. 22

TOMAHAWK LAKE

ONEIDA COUNTY

SECS. 24, 25, 34 T39N-R6E
 SEC. 1 T38N-R6E
 SECS. 29, 30, 31, 32, 33, 34 T39N-R7E
 SECS. 3, 4, 5, 6, 8, 9 T38N-R7E

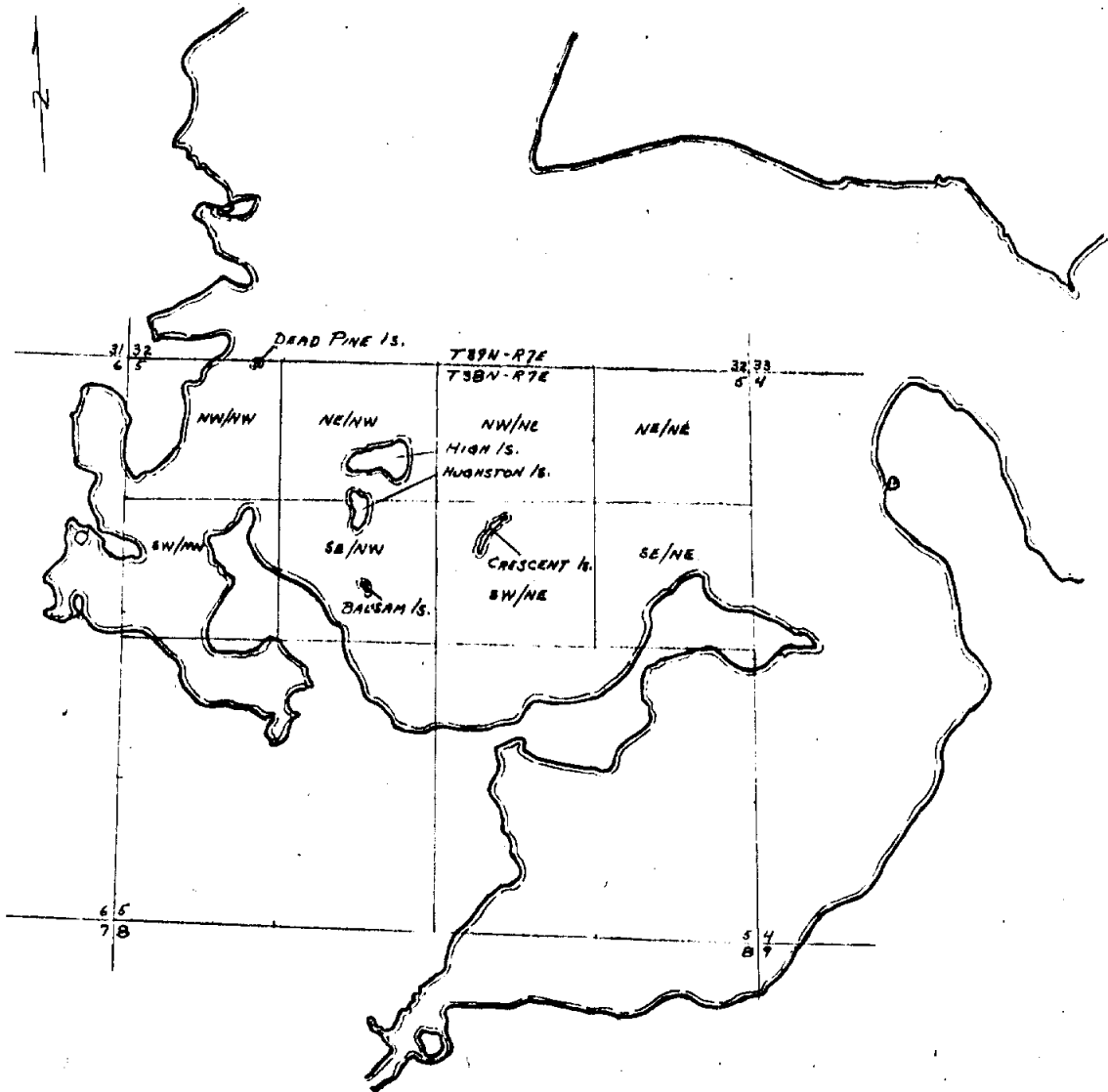

Csm 10-74

FROM AERIAL PHOTOS TAKEN IN 1972

MAP No. 24

SOUTH TWO LAKE

ONEIDA COUNTY

SECS. 15, 16, 21, 22 T30N-R7E

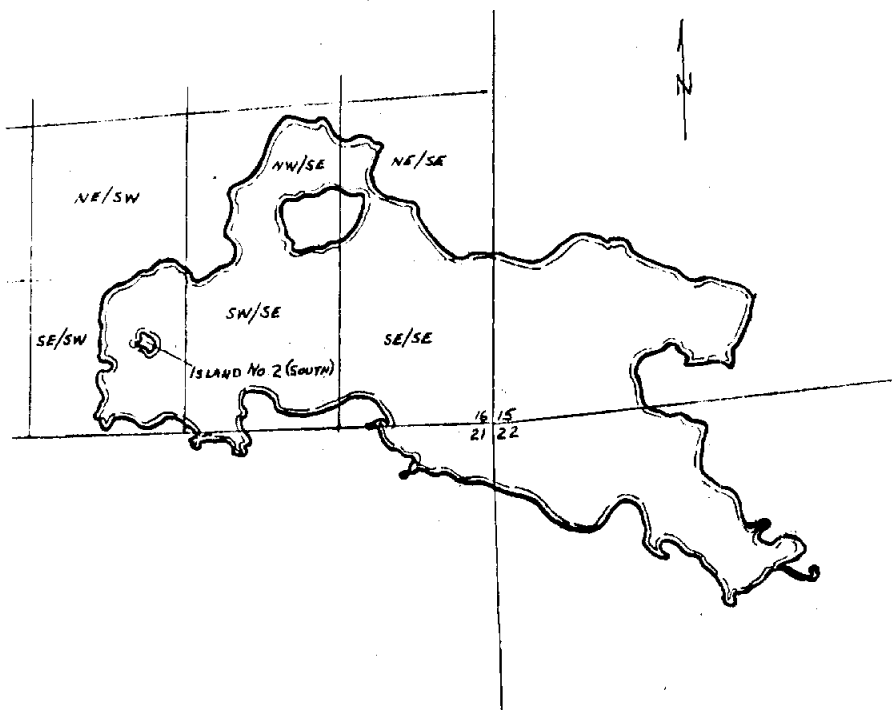

CAM 10-74

FROM AERIAL PHOTOS TAKEN IN 1972

VOLUME 3 PAGE 459

No. 10

SEED LAKE

ONEIDA COUNTY

SECS. 31, 32
SECS. 5, 6

T30N-R7E
T37N-R7E

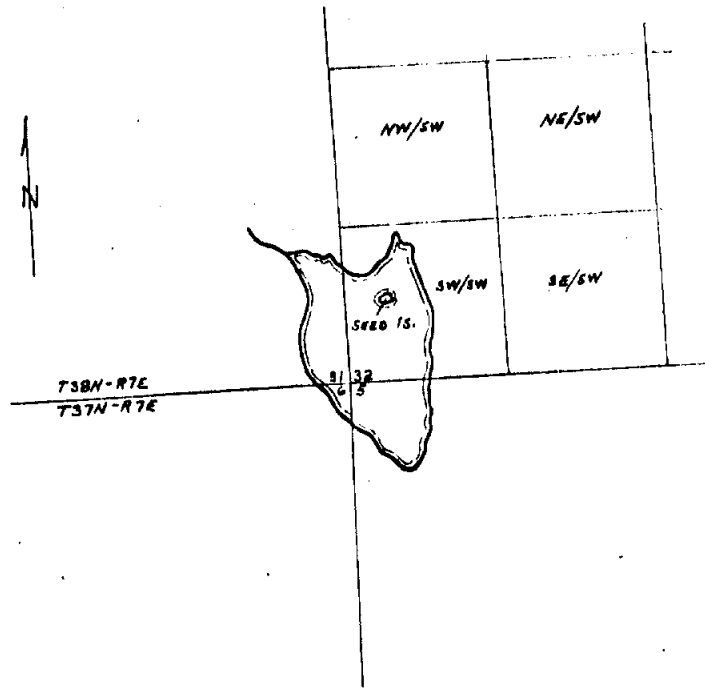

Cam 10-74

FROM AERIAL PHOTOS TAKEN IN 1972

MAP No. 29

LUMEN LAKE ONEIDA COUNTY
SEC. 33 T38N-R7E

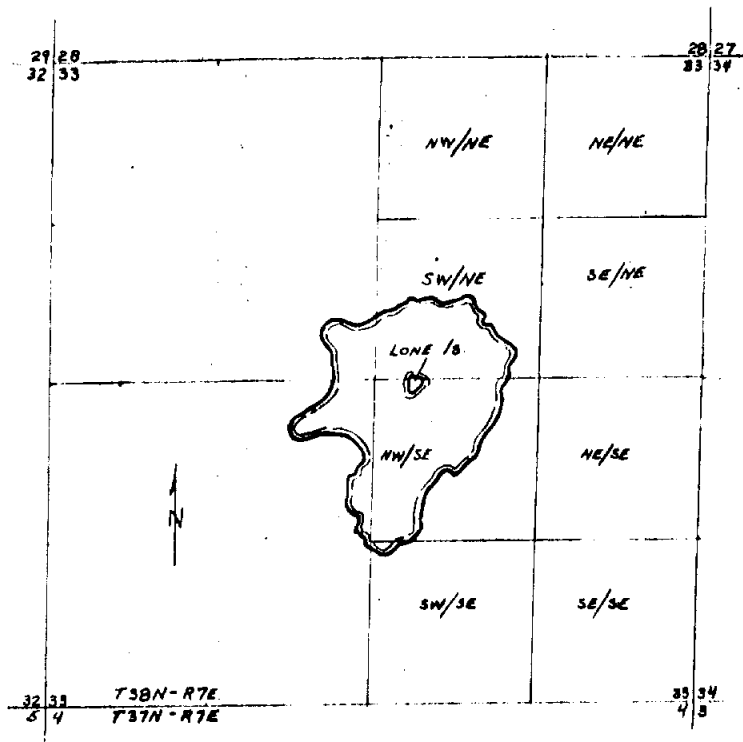

CAM 10-74

FROM AERIAL PHOTOS TAKEN IN 1972.

~~VOL 363 PAGE 1511~~

MAP No. 30

ALVA LAKE
SECS. 10, 11 T37N-R7E

ONEIDA COUNTY

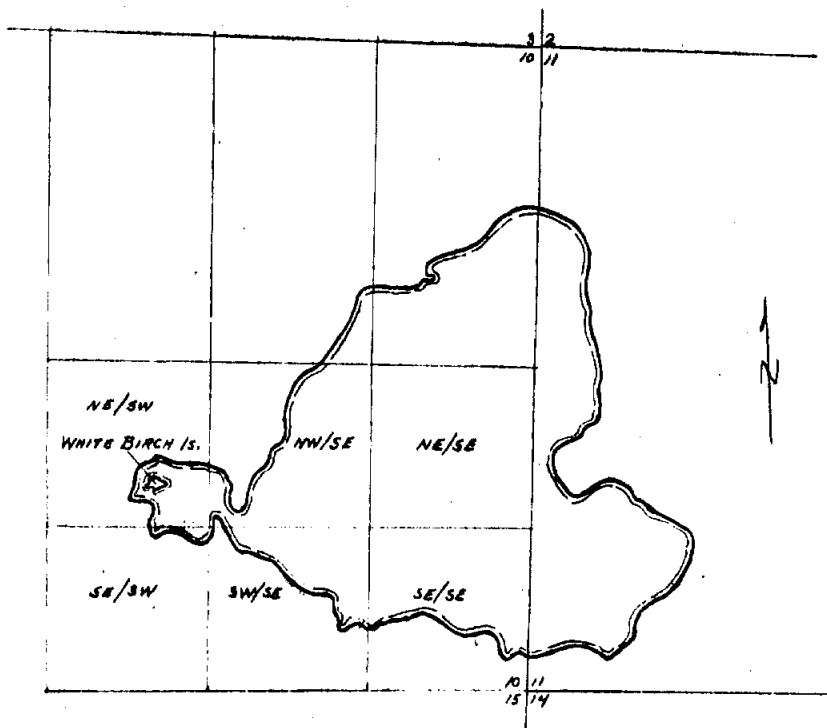

Cont 11-74

FROM AERIAL PHOTOS TAKEN IN 1972

MAP No. 31

MAUD LAKE
SECS. 13, 23, 24 T37N-R7E

ONEIDA COUNTY

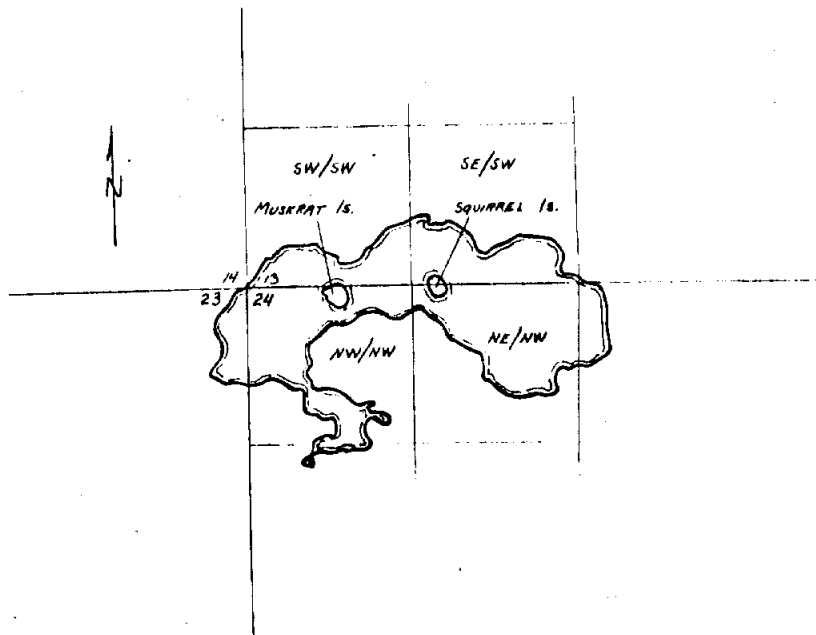

Cam 11-74

FROM AERIAL PHOTOS TAKEN IN 1972.

VOL 363 PAGE 643

MAP No. 32

ONEIDA LAKE

ONEIDA COUNTY

SECS. 4, 5, 8, 9 T36N-R7E

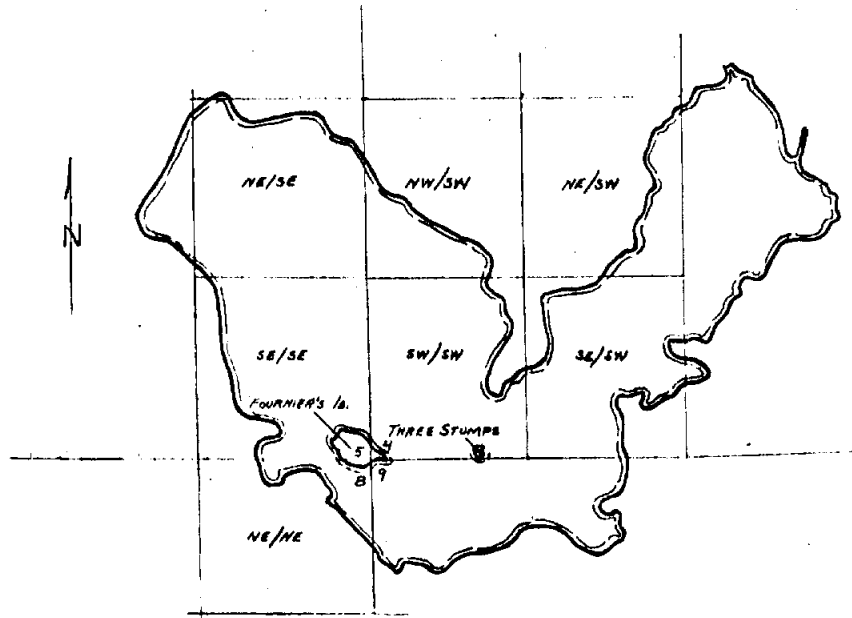

COM 11-74

FROM AERIAL PHOTOS TAKEN IN 1972

MAP No. 33

OSCAR-JENNY LAKE

ONEIDA COUNTY

SEC. 12 T36N-R6E
SEC. 7 T36N-R7E

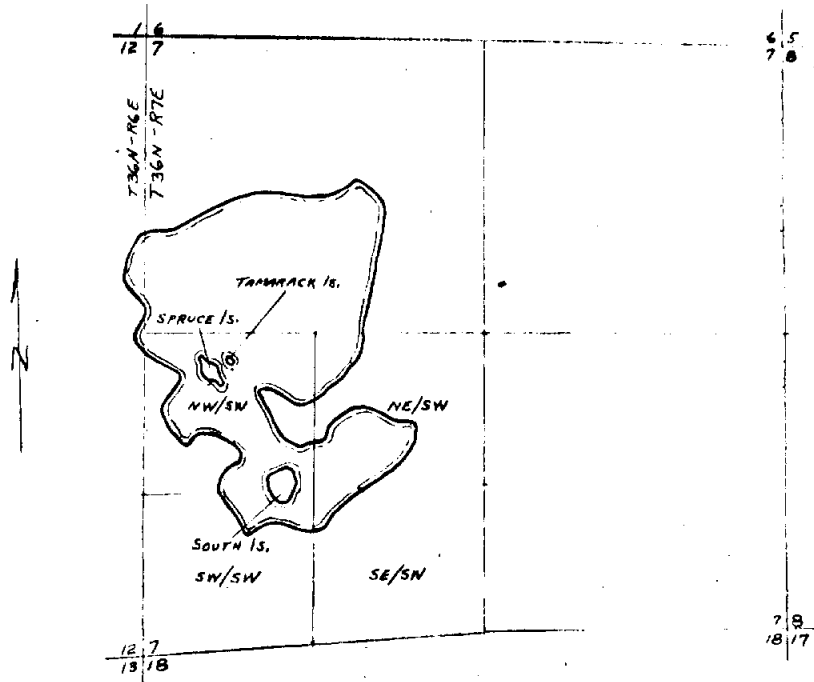

CSM 11-74

FROM AERIAL PHOTOS TAKEN IN 1972

VOL 363 PAGE 645

MAP No. 34

BROWN LAKE
SECS. 15, 16 T38N-R6E

ONEIDA COUNTY

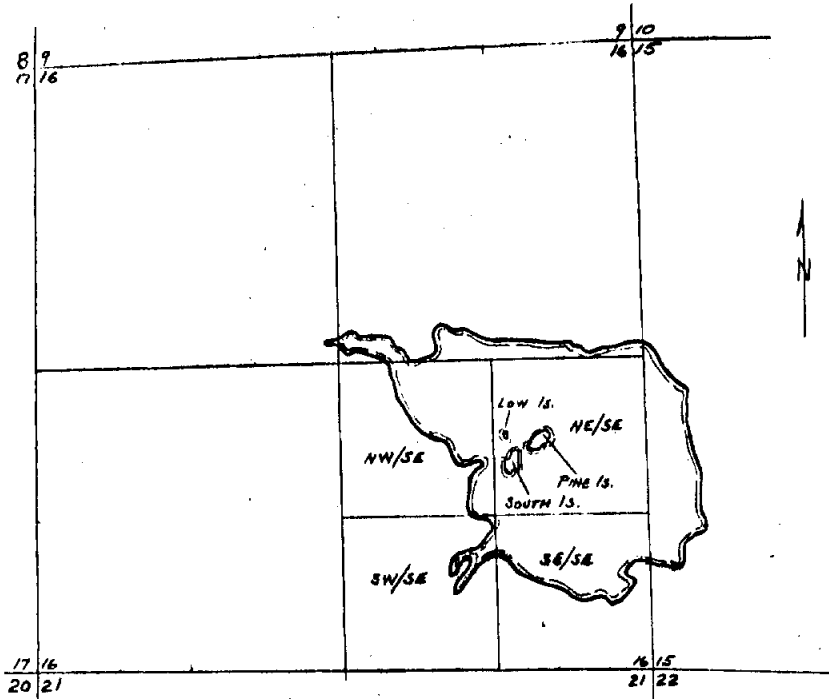

CSM 12-74

FROM AERIAL PHOTOS TAKEN IN 1972

MAP No. 37

COON LAKE

ONEIDA COUNTY

SECS. 18, 19 T37N-R8E

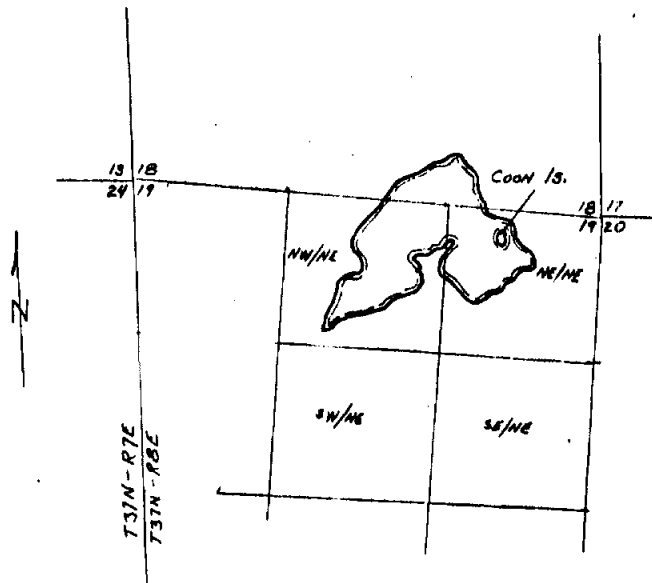

Cont 12-74

FROM AERIAL PHOTOS TAKEN IN 1972

MAP No. 40

FLANNERY LAKE

ONEIDA COUNTY

SECS. 28, 33 T 97N - R 6E

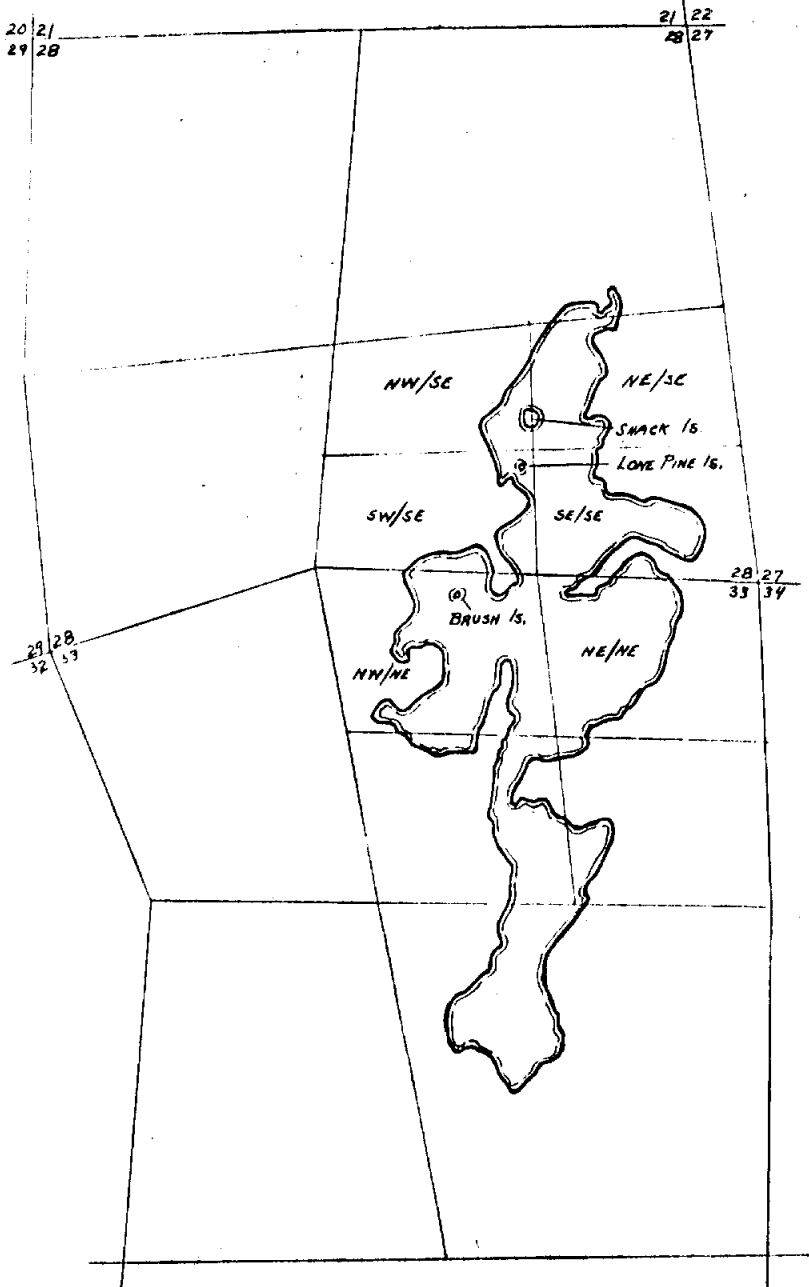

VOL 363 PAGE 649

Cam 12-74

AERIAL PHOTOS TAKEN IN 1972

Map No. 118

CRESCENT LAKE

ONEIDA COUNTY

SECS. 7, 8, 16, 17, 18, 20, 21 T36N-R2E

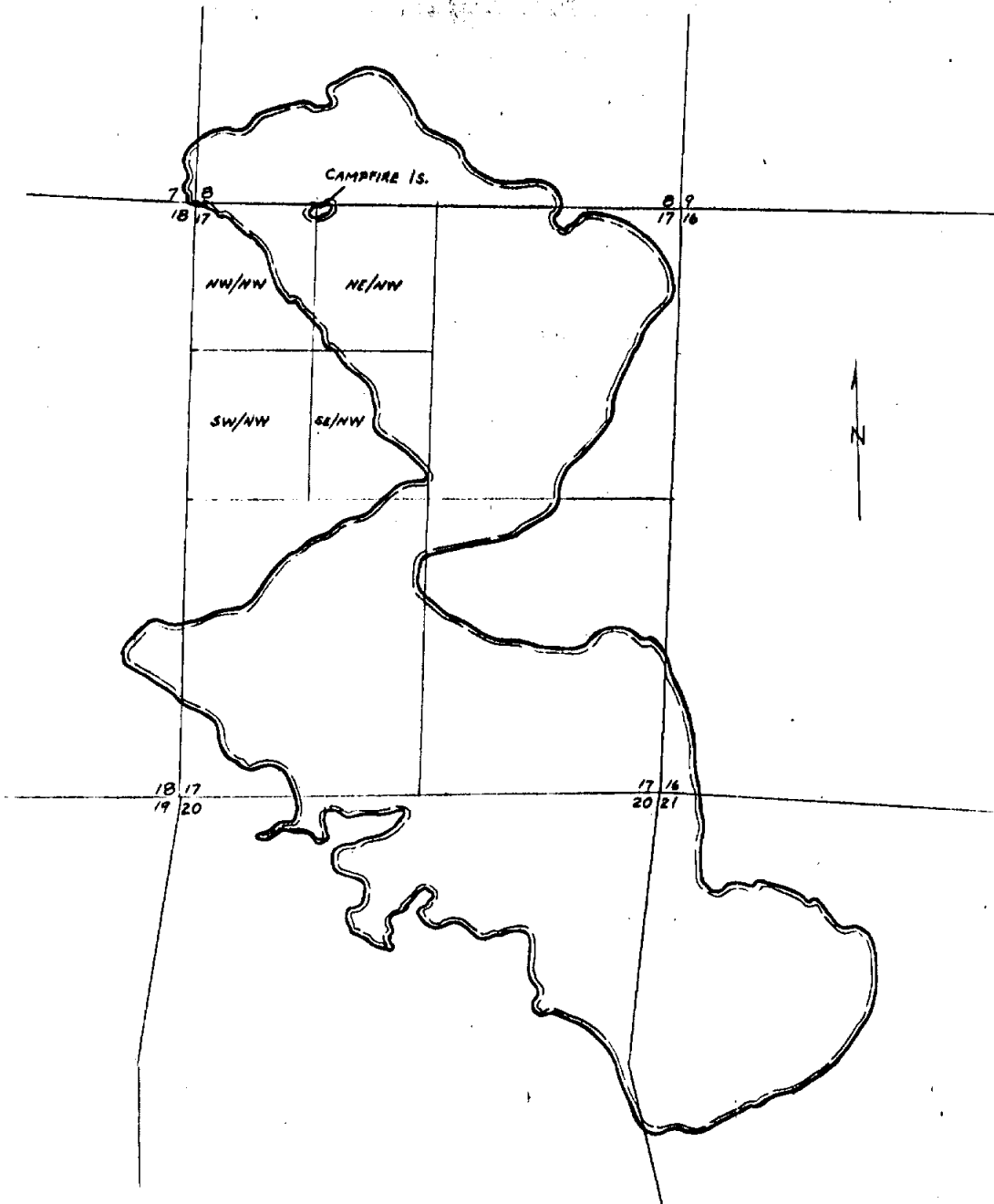

Csm 12-74

FROM AERIAL PHOTOS TAKEN IN 1972.

MAP No. 44

EMMA LAKE

ONEIDA COUNTY

SECS. 21, 28 T36N-R8E

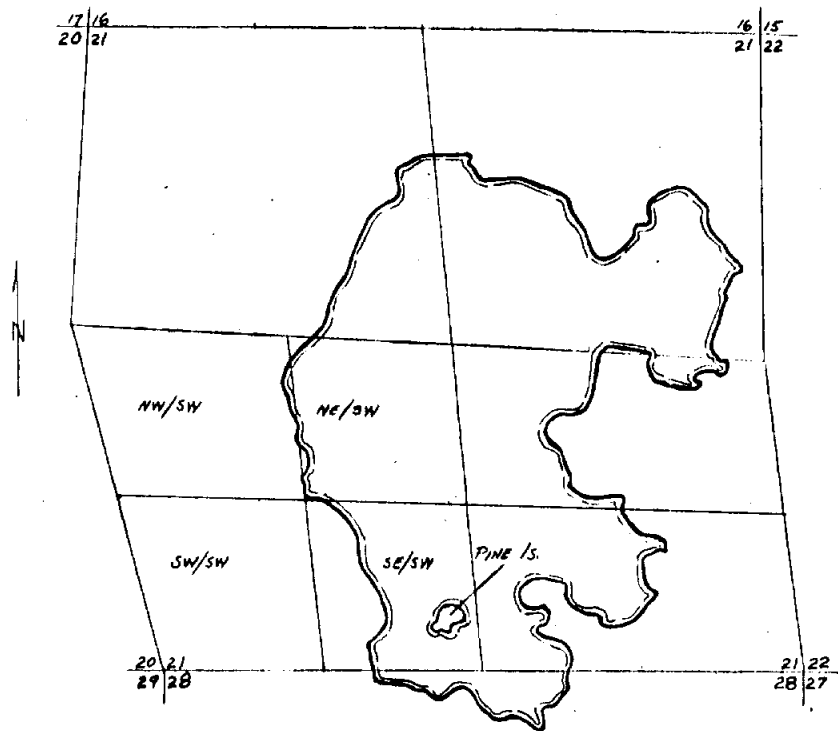

Cont 12-74

FROM AERIAL PHOTOS TAKEN IN 1972

~~VOL 368 PAGE 651~~

MAP No. 45

LAKE JULIA

SECS. 12, 13 T36N-R8E

SECS. 7, 18 T36N-R9E

ONEIDA COUNTY

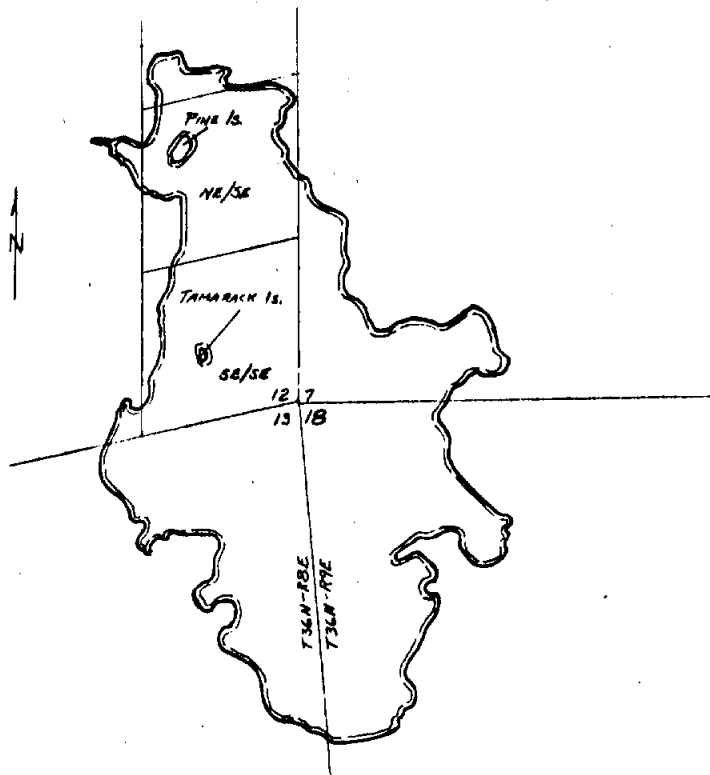

Cam 12-74

FROM AERIAL PHOTOS TAKEN IN 1972

MAP No. 46

INDIAN LAKE

ONEIDA COUNTY

SEC. 1 T38N-R9E
SEC. 6 T38N-R10E
SEC. 36 T39N-R9E
SEC. 31 T39N-R10E

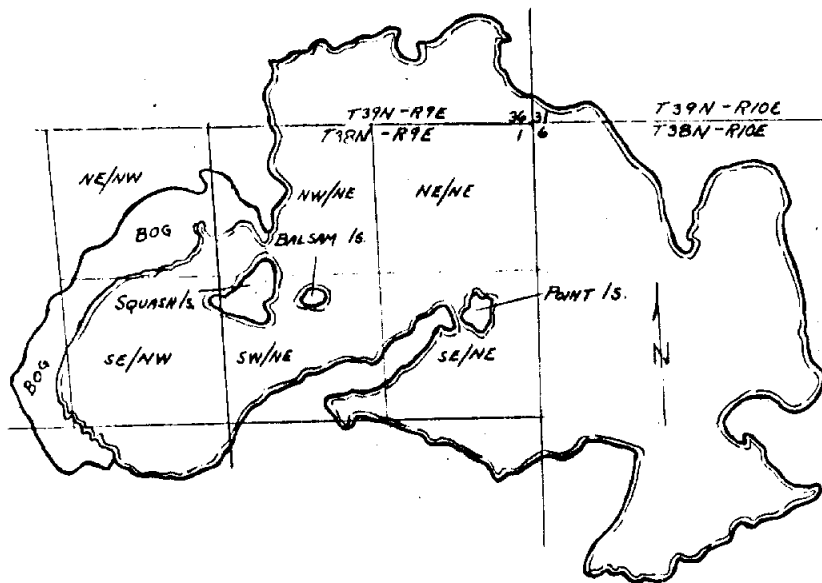

CSM 1-75

FROM AERIAL PHOTOS TAKEN IN 1972

VOL 363 PAGE 653

T38N-R9E

THOMPSON LAKE

ONEIDA COUNTY

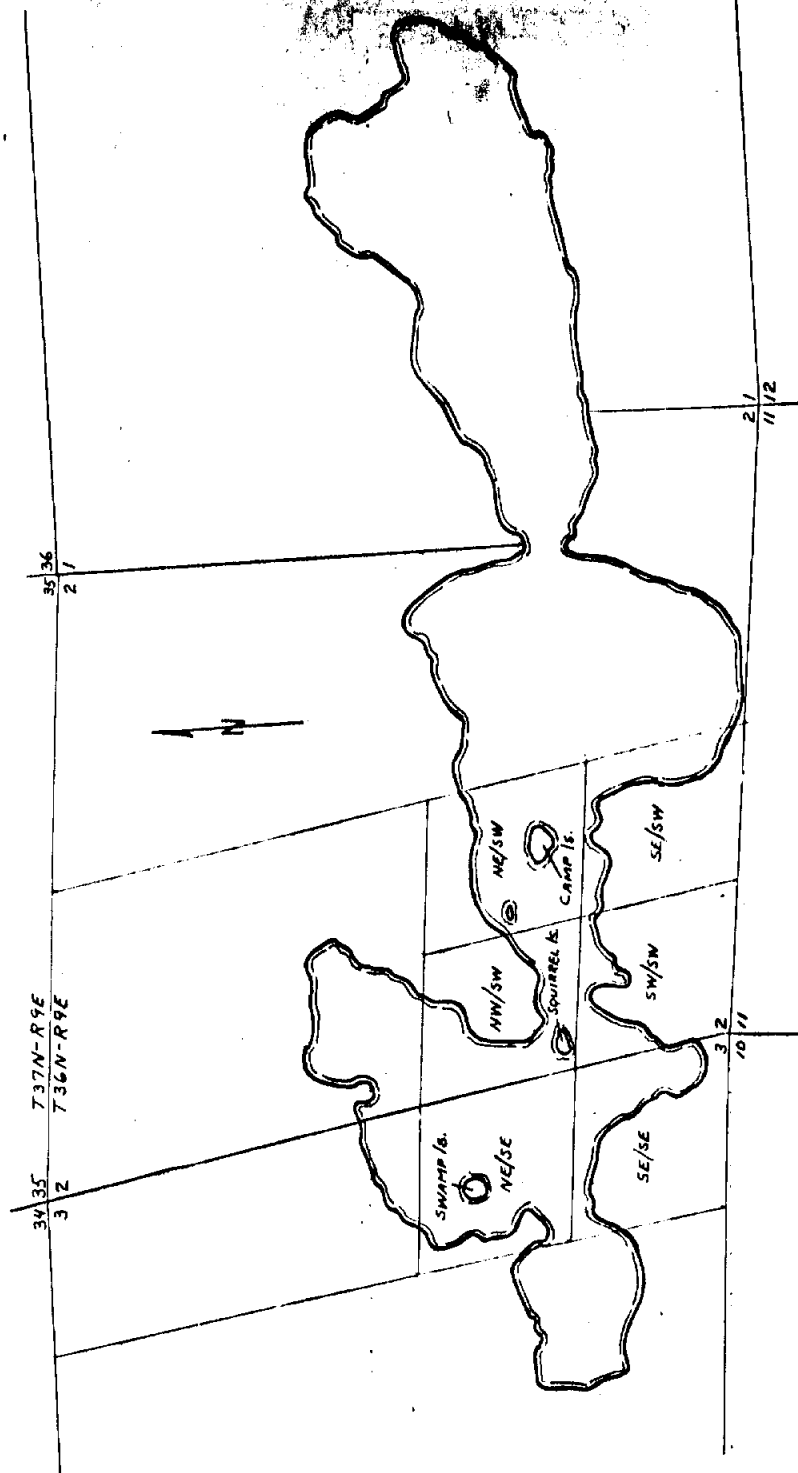

MAP No. 48

Cam 1-75

FROM AERIAL PHOTOS TAKEN IN 1972

GEORGE LAKE

ONEIDA COUNTY

SECS. 11, 13, 14, 15 T36N-R9E

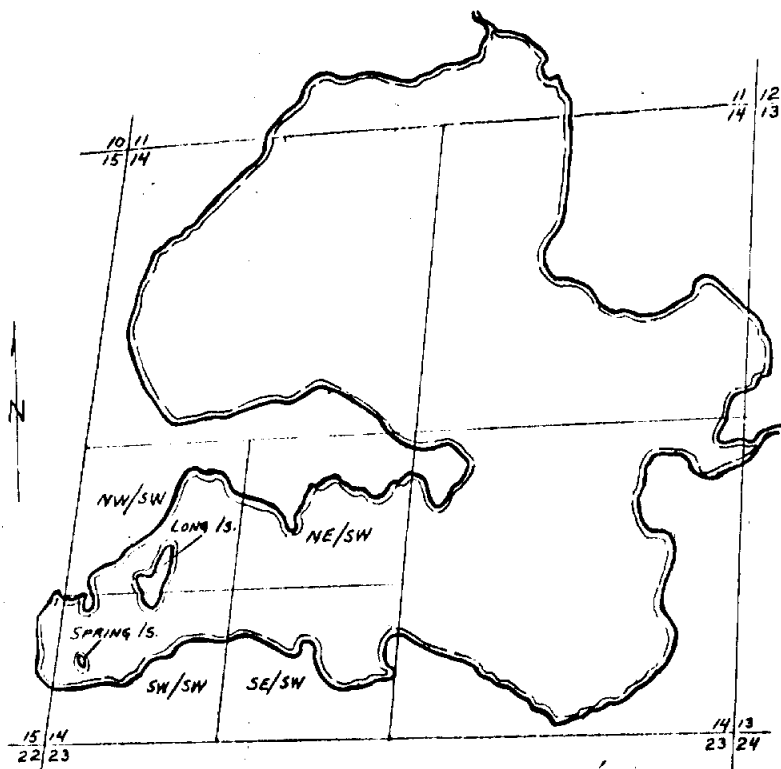

C&M 1-75

FROM AERIAL PHOTOS TAKEN IN 1972.

THUNDER LAKE

SECS. 2, 3, 9, 10, 11, 12, 14, 15, 16
T38N, R10E

ONEIDA COUNTY

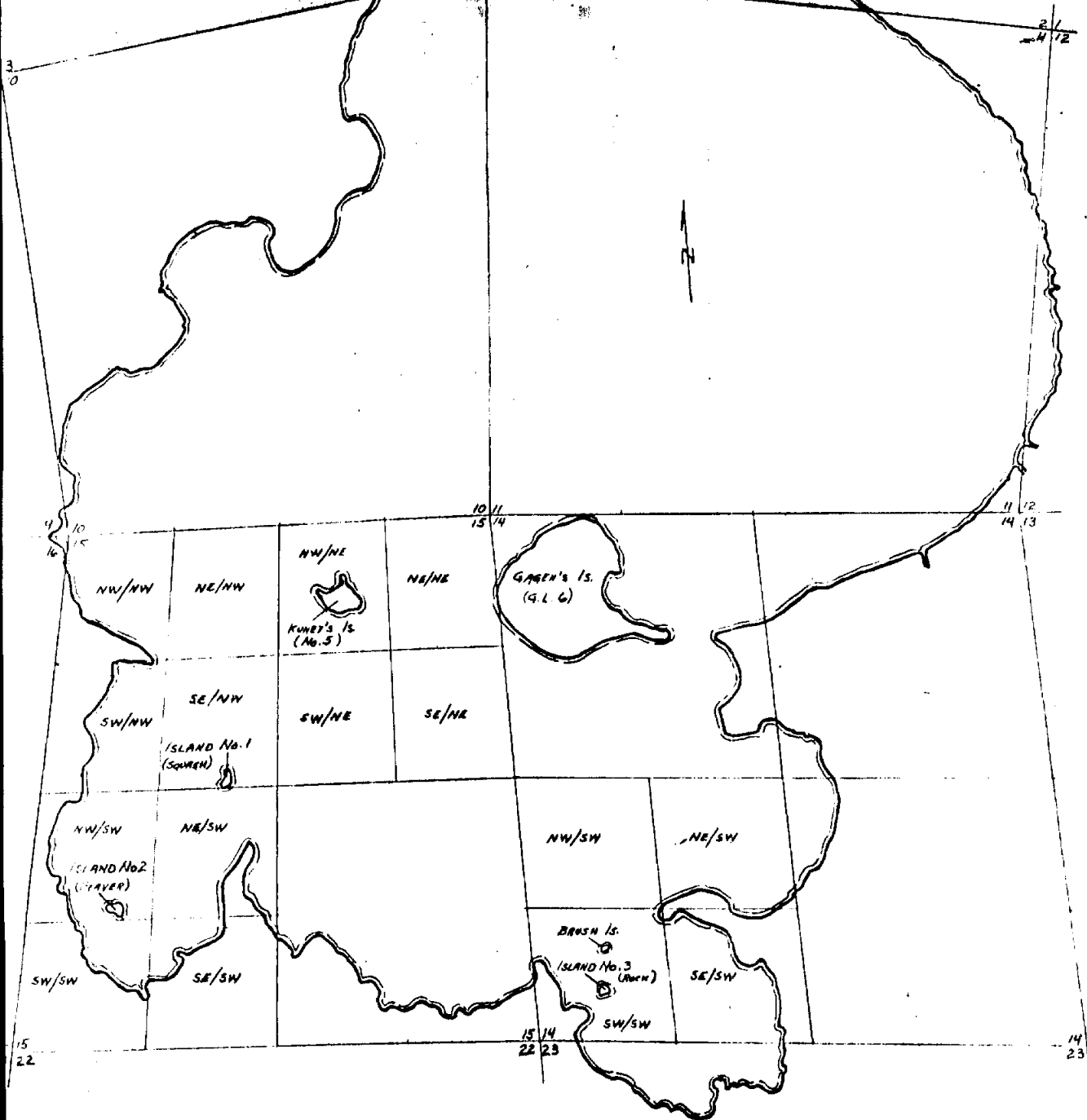

CS 111 1-75

MAP No. 50
FROM AERIAL PHOTOS TAKEN IN 1972

STELLA LAKE

ONEIDA COUNTY

SECS. 1, 2, 11, 12 T33N-R10E

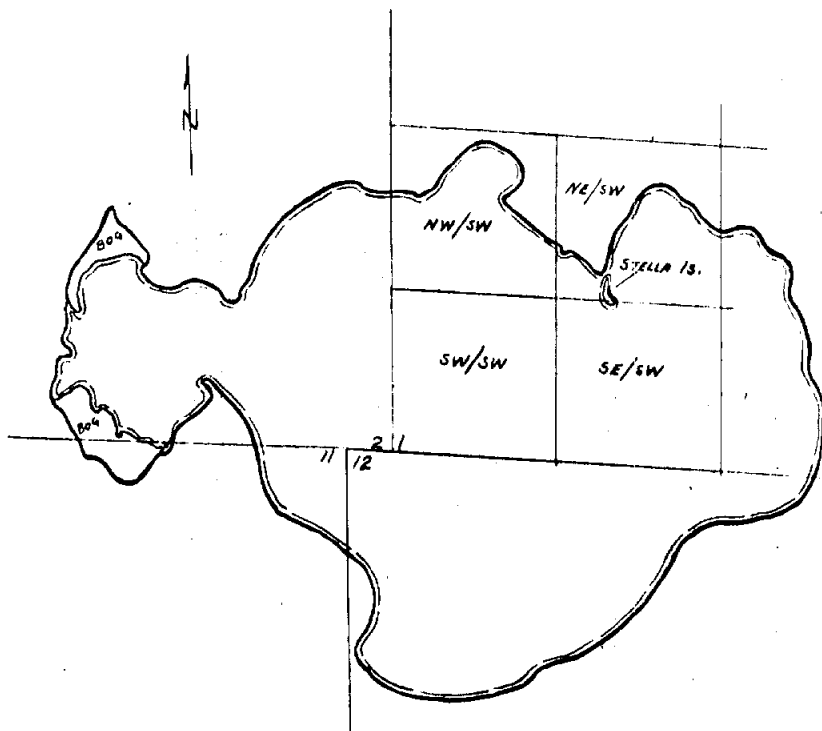

CSM 1-75

FROM AERIAL PHOTOS TAKEN IN 1972

VOL 363 PAGE 657

Map No. 65

FIFTH LAKE

ONEIDA COUNTY

SECS. 4, 5 T36N-R10E
SEC. 33 T37N-R10E

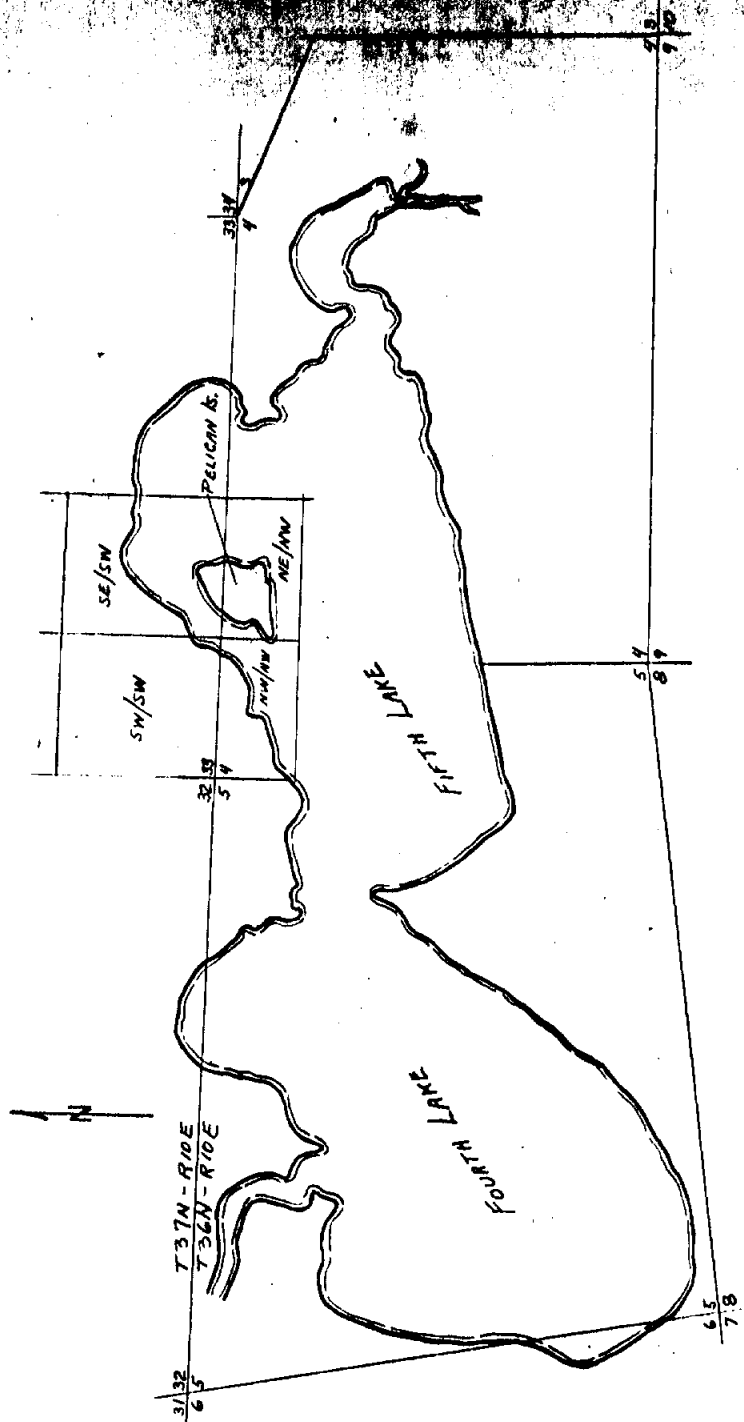

MAP No. 52

Cam 1-75

FROM AERIAL PHOTOS TAKEN IN 1972

VIRGIN LAKE ONEIDA COUNTY
SECS. 10, 11, 14, 15 T38N-R11E

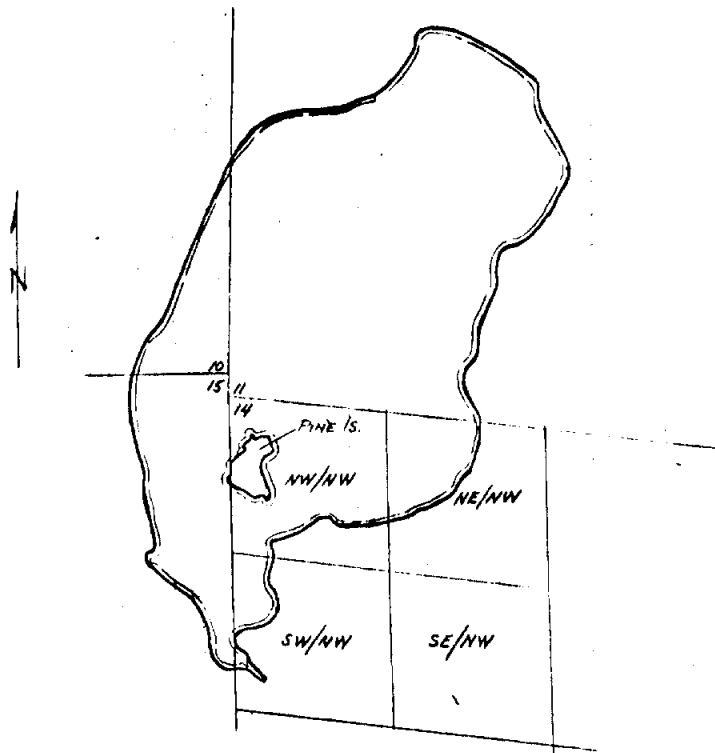

Edm 1-75

FROM AERIAL PHOTOS TAKEN IN 1972

CROOKED LAKE

ONEIDA COUNTY

SECS. 26, 27, 34, 35 T35N-R11E

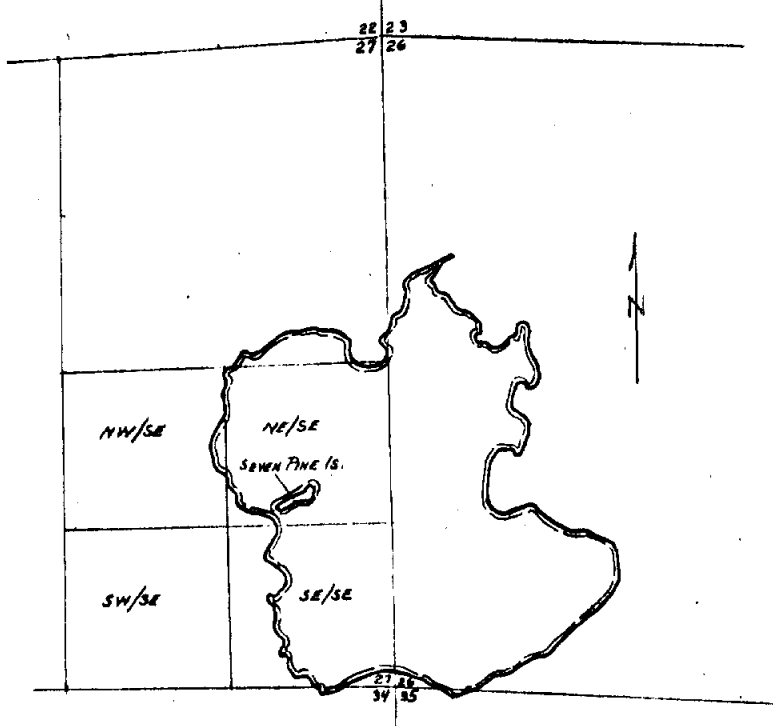

Cam 1-75

FROM AERIAL PHOTOS TAKEN IN 1972.

MAP No. 57

MARGARET (LOST) LAKE
SECS. 3, 4 T37N-R1E

ONEIDA COUNTY

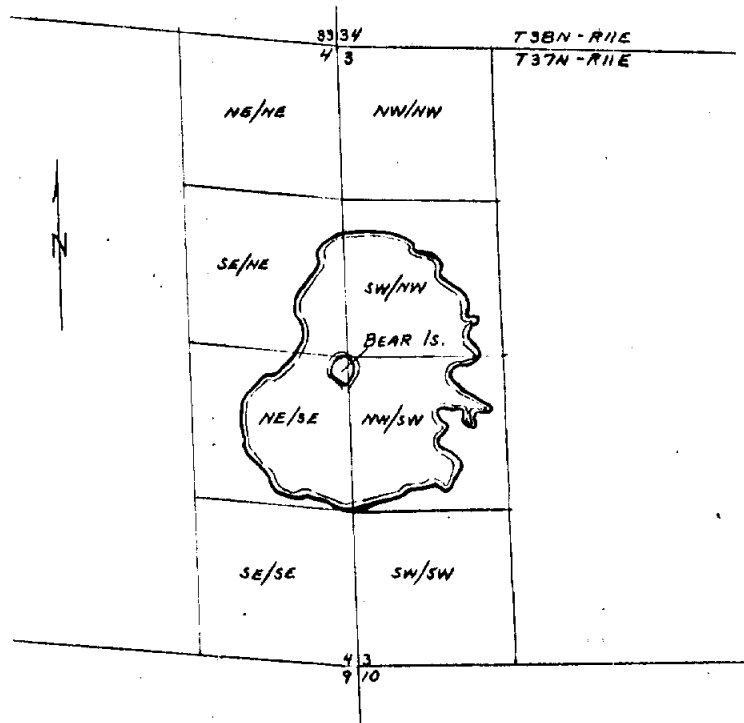

CS 111 1-75

FROM AERIAL PHOTOS TAKEN IN 1972

~~VOL 363 PAGE 64~~

MAR No. 58

GINTY LAKE

ONEIDA COUNTY

SEC. 24 T37N-R10E

SECS. 19,30 T37N-R11E

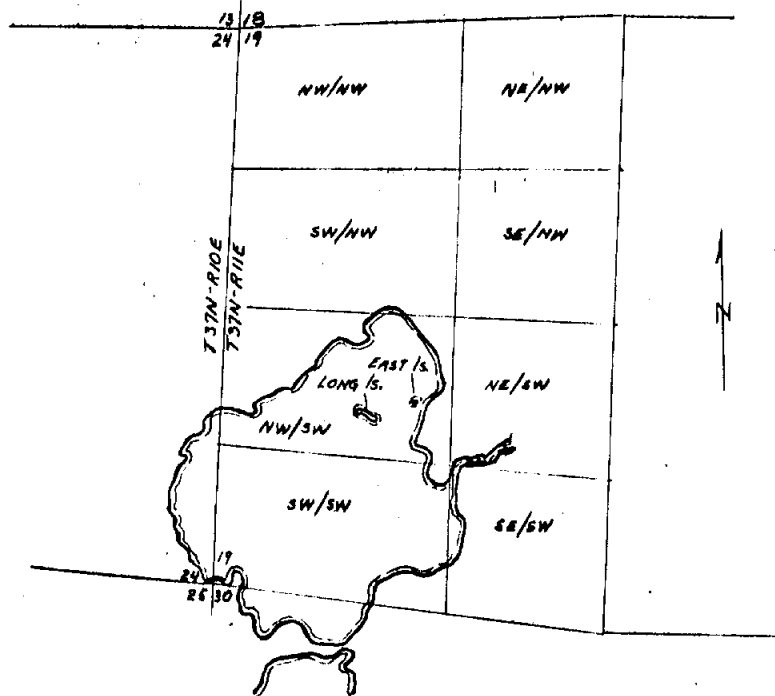

Csm 1-75

FROM AERIAL PHOTOS TAKEN IN 1972

MAP No. 59

NEPTUNE (OGEMAGA) LAKE ONEIDA COUNTY

SEC. 24 T36N-R10E
SEC. 19 T36N-R11E

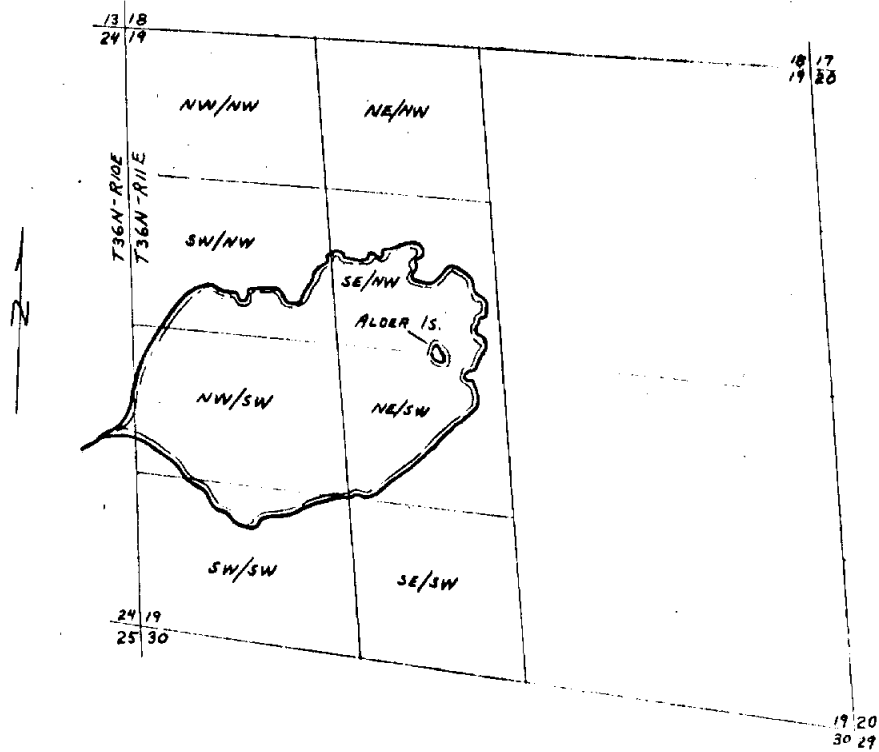

CSM 1-75

FROM AERIAL PHOTOS TAKEN IN 1972.

VOL 963 PAGE 663
MAP No. 60.

HANCOCK LAKE
SECS. 8, 9, 16, 17 T36N-R7E

ONEIDA COUNTY

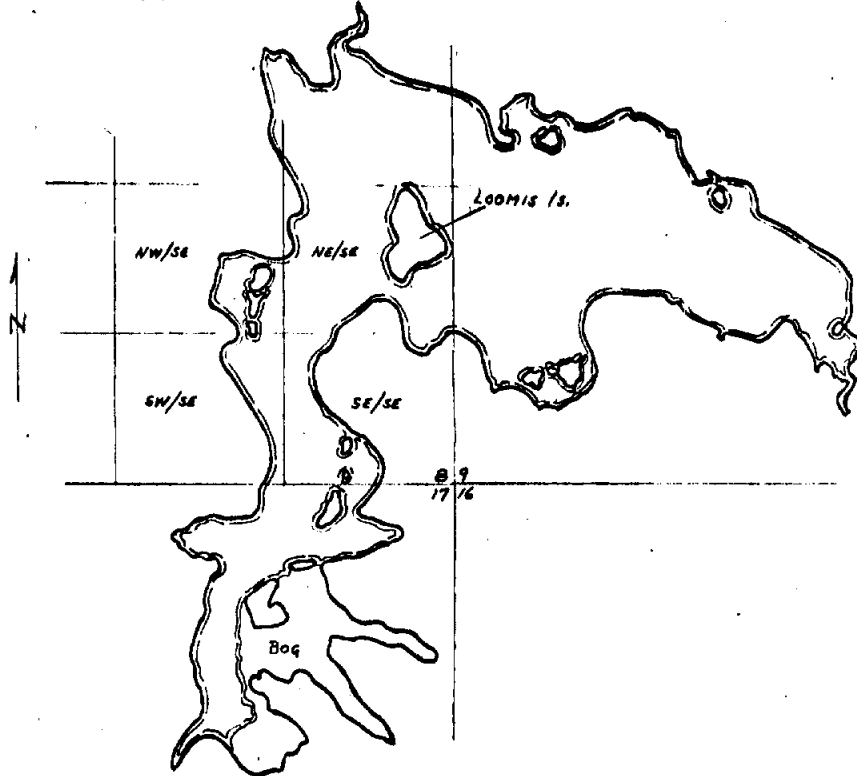

Cam 11-74

FROM AERIAL PHOTOS TAKEN IN 1972

MAP No. 62

MANSON LAKE
SECS. 32, 33 T36N-R7E

ONEIDA COUNTY

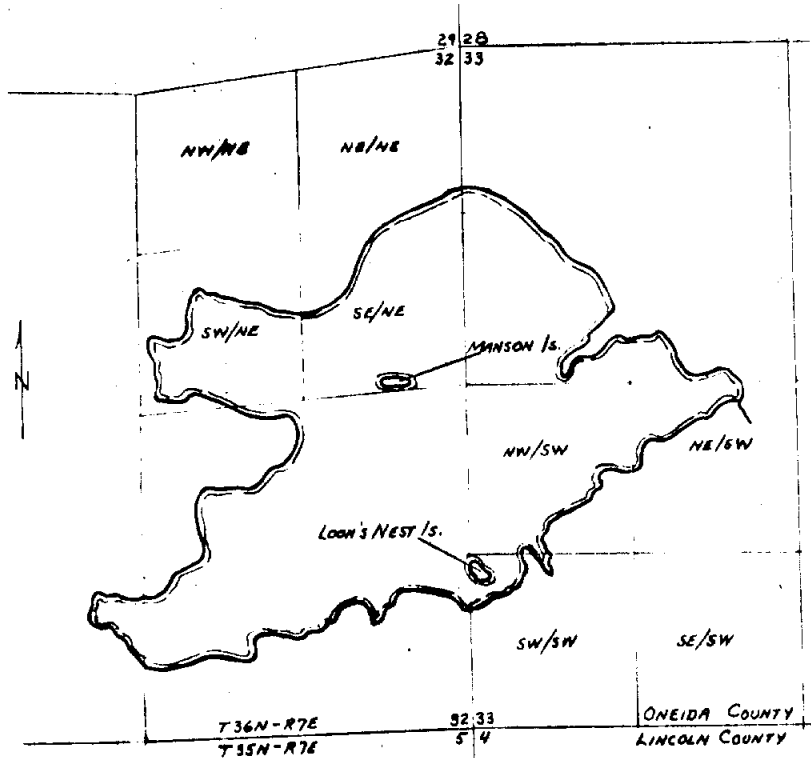

COM 11-74

FROM AERIAL PHOTOS TAKEN IN 1972

VOL 363 PAGE 665

MAP 11-74

SQUASH LAKE

WEST ONIDA COUNTY

SECS. 18, 19 T36N-R7E
T36N-R8E

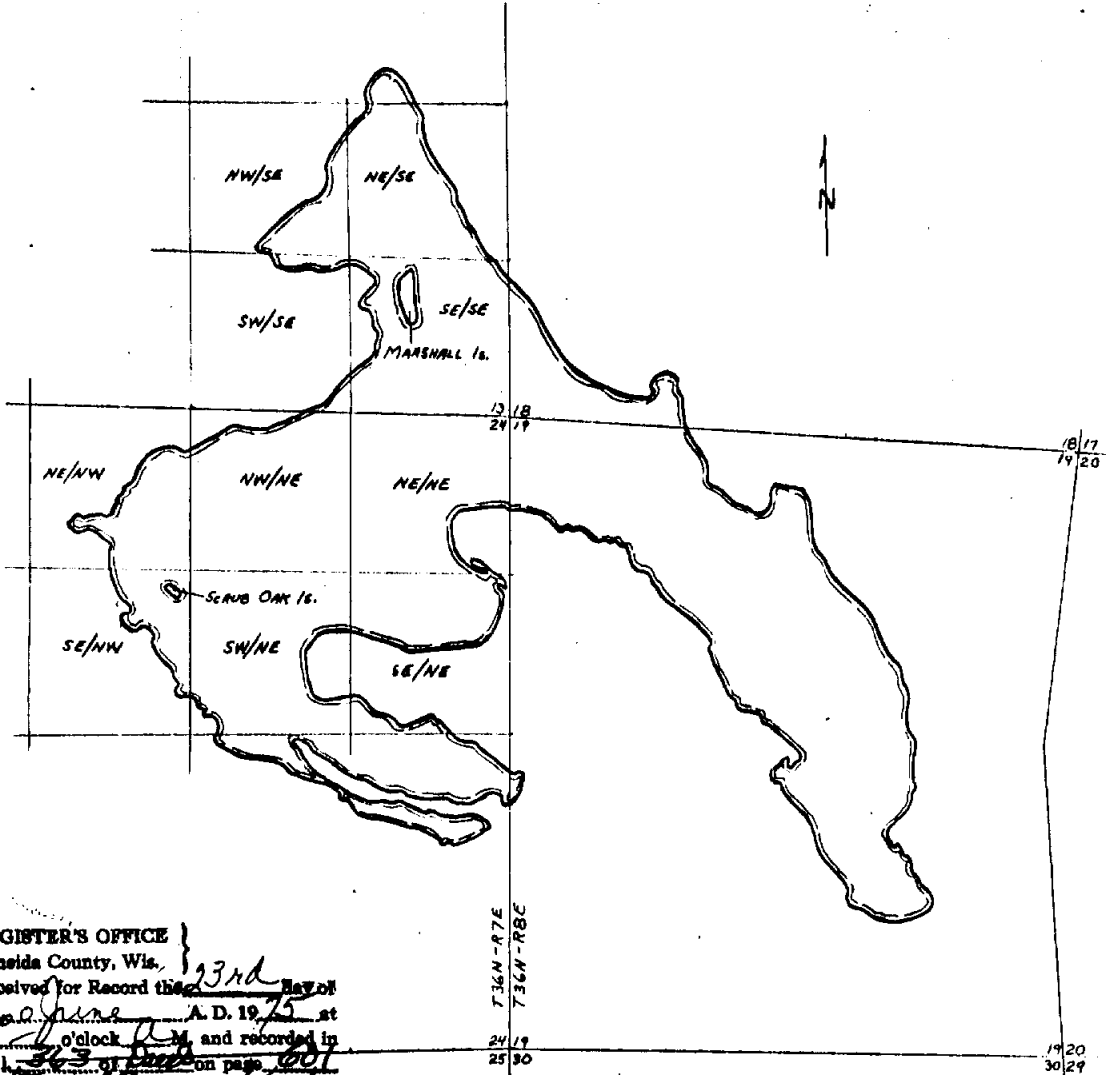

REGISTER'S OFFICE }
 Onida County, Wis. }
 Received for Record this 23rd day of
June A. D. 1975 at
11 o'clock P.M. and recorded in
 Vol. 363 of Books on page 601
Louis Berage Kuehn
 Register

Com 11-74

FROM AERIAL PHOTOS TAKEN IN 1972.

MAP No. 63