

3809100030

SURVEY LANDMARK PRESERVATION RECORD

It is the primary purpose of this record to preserve the location of any survey landmark subject to disturbance, removal or to be rendered inaccessible, as provided by Section 59.74(2), Perpetuation of Landmarks, Wisconsin Revised Statutes.

County: ONEIDA	City, Village, Town: SUGAR CAMP	Section: 15	Town: 38	Range: 09
--------------------------	---	-----------------------	--------------------	---------------------

Describe what was found, its location and origin. If known, describe if the monument found is a 1/16 corner or other subdivisional corner; a monument called for in a deed; a monument shown on a survey map or plat ect. and in what Gov't Lot, 1/4-1/4 Section or other PLSS subdivisional tract.

Show approximate location of survey landmark on this Section diagram:

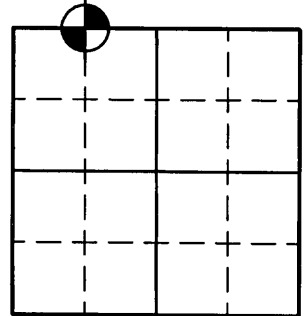

July 29, 2004 - We found a P.K. Nail approximately 5' North of the centerline of Camp Four Road at the NW Corner of the NE 1/4-NW 1/4. This is called out as a 1/16 corner with an iron pipe set or found per Plat of Survey by Norman J. Loftus dated 1/21/1975; Oneida County Land Information Map Number B-240.

August 12, 2005 - After road construction we reset a P.K. Nail at this location.

Plan view map of survey landmark location with bearing and distance ties to a minimum of four(4) described witness or reference monuments of concrete, natural stone, metal, live bearing trees or equivalent material and/or described GPS method and precision.

Scale: 1" = 50'

LEGEND

△ P.K. Nail Set

○ 3/4" x 24" Iron-rebar Set Weighing 1.50 lbs/lin. ft.

10" White Pine
(Dist. from corner to a set 60 D nail in base of tree, S28°57'33"W, 61.90')

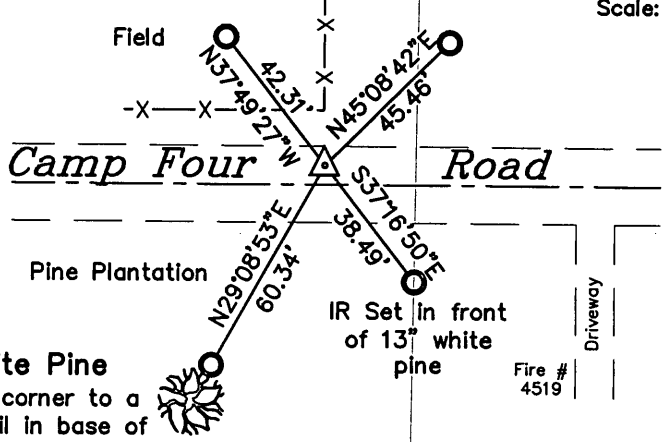

MAP # **L2392**
 DATE FILED **OCT 26 2007**
 BY **JDG**
 DESCRIPTION FILED
 ONEIDA CO. SURVEYOR'S OFFICE

PROFESSIONAL LAND SURVEYOR CERTIFICATE:

This survey landmark is being referenced for the express purpose of location preservation and is not intended as an attestation of the legal significance and/or positional accuracy thereof.

Therefore, this survey landmark location should be further evaluated and verified for any future land surveying or related usage purposes

I, Jonathan W. Dulin, hereby certify that I am duly licensed as a Professional Land Surveyor in the State of Wisconsin; that the location of this survey landmark was referenced by me under my direct supervision and/or control; and that the information shown is true and correct to the best of my knowledge and belief.

Signed: Jonathan W. Dulin Date: 10-8-2007

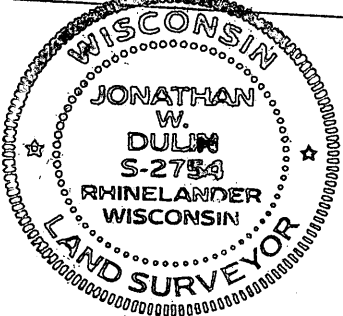

L2392

L2392

L2392

L2392