

# SURVEY LANDMARK PRESERVATION RECORD

It is the primary purpose of this record to preserve the location of any survey landmark subject to disturbance, removal or to be rendered inaccessible, as provided by Section 59.74(2), Perpetuation of Landmarks, Wisconsin Revised Statutes.

County: <b>ONEIDA</b>	City, Village, Town: <b>SCHOEPKE</b>	Section: <b>15</b>	Town: <b>35</b>	Range: <b>10</b>
--------------------------	---	-----------------------	--------------------	---------------------

Describe what was found, its location and origin. If known, describe if the monument found is a 1/16 corner or other subdivisional corner; a monument called for in a deed; a monument shown on a survey map or plat ect. and in what Gov't Lot, 1/4-1/4 Section or other PLSS subdivisional tract.

May 15, 2006 - We searched for the corner near the centerline of County Highway "Q", but found nothing. We did find a 3/4" iron pipe approximately 37.7' North of the centerline of County Highway "Q" at the approximate corner location. This corner was also marked as a computed position per Plat of Survey by Stephen J. Favorite dated 03/17/2005 - Oneida County Land Information Office Map Number A-1490.

Show approximate location of survey landmark on this Section diagram:

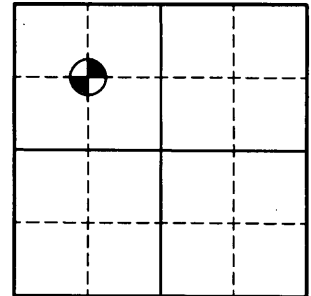

Plan view map of survey landmark location with bearing and distance ties to a minimum of four(4) described witness or reference monuments of concrete, natural stone, metal, live bearing trees or equivalent material and/or described GPS method and precision.

Scale: \_\_\_\_\_

MAP # <b>L 2413</b> DATE FILED <b>NOV 16 2007</b> BY <b>SDK</b> DESCRIPTION FILED ..... ONEIDA CO. SURVEYOR'S OFFICE
--

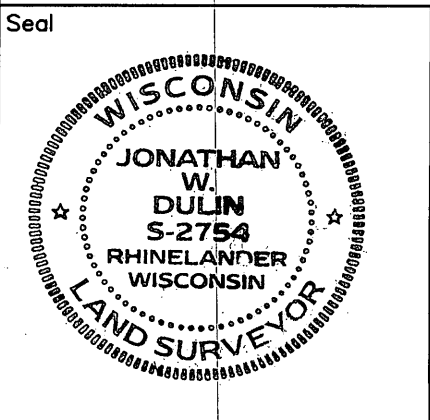

**PROFESSIONAL LAND SURVEYOR CERTIFICATE:**

This survey landmark is being referenced for the express purpose of location preservation and is not intended as an attestation of the legal significance and/or positional accuracy thereof.

Therefore, this survey landmark location should be further evaluated and verified for any future land surveying or related usage purposes

I, Jonathan W. Dulin, hereby certify that I am duly licensed as a Professional Land Surveyor in the State of Wisconsin; that the location of this survey landmark was referenced by me under my direct supervision and/or control; and that the information shown is true and correct to the best of my knowledge and belief.

Signed: Jonathan W. Dulin Date: 11/8/07

3510153030