

**MCMULLEN & ASSOCIATES, INC.**  
 "Your True North Surveyors & Soil Testers"  
 9729 Whispering Oak Court  
 Minocqua, Wisconsin 54548  
 (715) 356-3011

**ROAD DESCRIPTION**

**("Whispering Oak Court" of the Final State Plat of Oakwood Business Park)**

Located in Part of the Northeast 1/4 of the Northeast 1/4, Section 34, Township 39 North, Range 6 East, town of Minocqua, Oneida County, Wisconsin shown on said Final State Plat by McMullen & Associates, Incorporated of Minocqua, Wisconsin dated the 22nd Day of September, 2006 with a Job No. of 206002 and more particularly described as follows:

Commencing at the Northeast Section corner of said Section marked by a P.K. Nail in the intersection of Blue Lake Road and Jahnke Road; thence South 12° 33' 35" West, a distance of 564.01 feet to a 2.375" Iron Pipe on the Westerly right-of-way of U.S. Highway "51" and the Northerly right-of-way of "Whispering Oak Court", said point being the POINT OF BEGINNING.

Thence leaving said Westerly right-of-way along said northerly right-of-way of "Whispering Oak Court" the following courses:

- Thence South 89° 25' 02" West, a distance of 519.30 feet to a 1.660" Iron Pipe;
- Thence South 89° 23' 49" West, a distance of 299.99 feet to a 1.050" Iron Pipe;
- Thence South 89° 23' 17" West, a distance of 99.79 feet to a 1.660" Iron Pipe;
- Thence South 89° 43' 31" West, a distance of 10.17 feet to a 2.375" Iron Pipe;
- Thence along the arc of a curve to the left 149.94 feet, with a radius of 50.00 feet, and a long chord of which bears South 2° 28' 45" West having a distance of 99.75 feet to a 1.050" Iron Pipe;
- Thence along the arc of a curve to the left 219.64 feet, with a radius of 75.00 feet, and a long chord of which bears North 76° 23' 46" East having a distance of 149.15 feet to a 2.375" Iron Pipe;
- Thence North 89° 25' 38" East, a distance of 403.52 feet to a 1.050" Iron Pipe;
- Thence North 89° 25' 02" East, a distance of 340.74 feet to a 2.375" Iron Pipe on the Westerly right-of-way of U.S. Highway "51";
- Thence North 33° 38' 37" East along said Westerly right-of-way, a distance of 80.03 feet to the POINT OF BEGINNING.

MAP # **L 2445**  
 DATE FILED **FEB 21 2008**  
 BY *[Signature]*  
 DESCRIPTION FILED .....  
 ONEIDA CO. SURVEYOR'S OFFICE

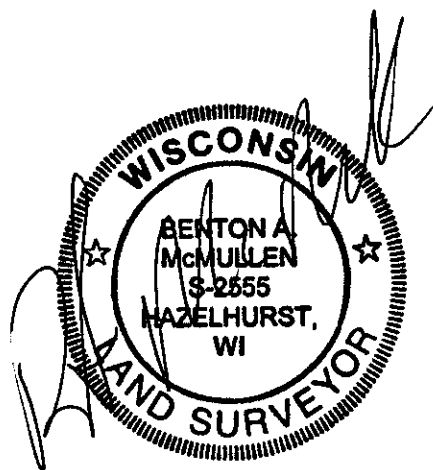

Registered Land Surveyor No. S - 2555  
 Benton A. McMullen  
 Dated the 15th Day of February, 2008