

MAP # **L 2555**  
 DATE FILED **NOV. 19 2008**  
 BY **JAB**  
 DESCRIPTION FILED  
 ONEIDA CO. SURVEYOR'S OFFICE

L 2555

KAWAGUESAGA  
LAKE

LOT 35 OF DOOLITTLE - BARDEN'S  
 KAWAGA SHORES - DIV 2  
 PART OF GOVERNMENT LOT 9  
 SECTION 15  
 TOWNSHIP 39 NORTH, RANGE 6 EAST  
 TOWN OF MINOCQUA  
 ONEIDA COUNTY, WISCONSIN

**SURVEYOR'S CERTIFICATE**

I, Benton A. McMullen, Wisconsin Registered Land Surveyor # S-2555, do hereby certify that I have surveyed and mapped the property shown hereon, and that I have complied with the applicable requirements of the Wisconsin Administrative Code Chapter A-E 7, and that this map represents a true and accurate survey of said property to the best of my knowledge and belief.

This survey was performed under the order of:  
 John Reynolds

This survey is made for the use of the present owners of the property, and also those who purchase, mortgage, or guarantee the title thereto within one year from date hereof.

**NOTE: SURVEY PERFORMED TO FLAG / MARK THE PARCEL LINES ONLY (EXISTING STRUCTURES / ROADS / WATERWAYS / ETC. NOT LOCATED OR SHOWN).**

**LEGEND**

- - 1" Iron Pipe Found
  - - 2 1/4" Iron Pipe Found
  - ⊙ - Survey Marker Nail Set (in blacktop)
  - () - Recorded as values
- (NOTE: Iron pipe diameter is outside diameter)

SCALE: 1" = 50'

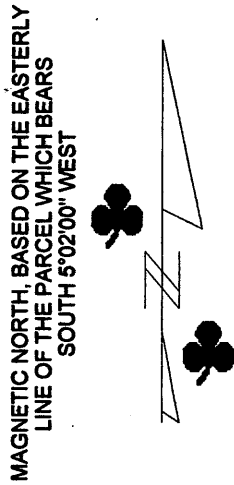

**CURVE DATA**

Curve	Delta Angle	Radius	Chord	Chord Bearing
1	16°59'53" (17°02')	218.72 (218.72')	64.65 (64.78')	S 42°50'52" W (S 41°57' W)
2	39°29'25" (39°34')	218.72 (218.72')	147.78	N 71°05'30" E

FIELD SURVEY WORK COMPLETED ON THE 29TH DAY OF JULY, 2008.

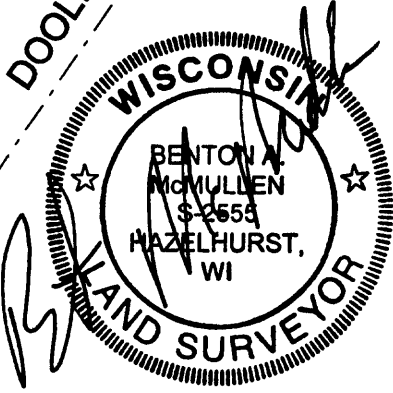

**MCMULLEN & ASSOCIATES, INCORPORATED**

♣ "Your true north surveyors and soil testers" ♣  
 9729 WHISPERING OAK COURT, MINOCQUA, WISCONSIN 54548  
 TELEPHONE # (715) 356-3011 FAX # (715) 356-1501

**"REYNOLDS SURVEY"**  
 LOT 35 OF DOOLITTLE - BARDEN'S KAWAGA SHORES - DIV 2  
 PART OF GOVERNMENT LOT 9  
 SECTION 15, TOWNSHIP 39 NORTH, RANGE 6 EAST  
 TOWN OF MINOCQUA  
 ONEIDA COUNTY, WISCONSIN

DRAFTED BY: Benton A. McMullen DATE: August 12, 2008  
 SCALE: 1" = 50' JOB # 208062

L 2555

L 2555