

SURVEY LANDMARK PRESERVATION RECORD

L 2595

It is the primary purpose of this record to preserve the location of any survey landmark subject to disturbance, removal or to be rendered inaccessible, as provided by Section 59.74(2), Perpetuation of landmarks, Wisconsin revised statutes.

County: ONEIDA	City, Village, Town CASSIAN	Section 33	Town T37N	Range R07E
--------------------------	---------------------------------------	----------------------	---------------------	----------------------

Describe survey landmark found or reset and origin if known, such as being a 1/16th corner, called for in a deed or shown on a record land survey map or plat; also note location by gov't. lot 1/4 1/4 section or other PLSS subdivisional tract.

Show approximate location of survey landmark on this section diagram.

-05/04/09- PRE-CONSTRUCTION: Kevin Bixby found P.K. Nail and witnessed as shown below.

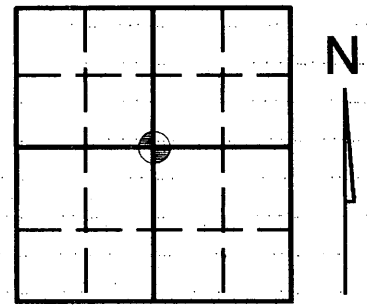

3707332020

MAP # L 2595
DATE FILED 5/27/09
BY... KH
DESCRIPTION FILED
ONEIDA CO. SURVEYOR'S OFFICE

Plan view map of survey landmark location with bearing and distance ties to a minimum of four (4) described witness or reference monuments of concrete, natural stone, metal, live bearing trees or equivalent material and/or by described GPS method and precision.

Angles and distances measured to heads of spikes with a total station.

SCALE: 1"=40'

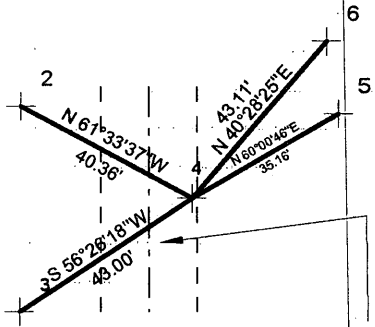

APPROXIMATE BITUMINOUS TRAVEL WAY OF HORSEHEAD LAKE ROAD

- LEGEND**
- 2- -3- SET 1" X 24" I.P. (O.D.)
 - 4- EXISTING P.K. NAIL
 - 5- HEAD OF 60D SPIKE IN 6" OAK
 - 6- HEAD OF 60D SPIKE IN 4" OAK

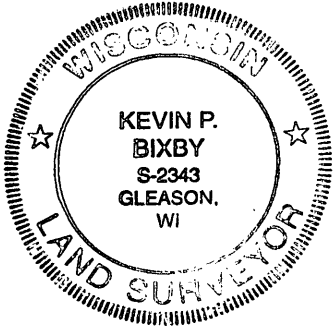

PROFESSIONAL LAND SURVEYOR CERTIFICATE

This survey landmark is being referenced for the express purpose of location preservation and is not intended as an attestation of the legal significance and/or positional accuracy thereof.

Therefore, this survey land mark location should be further evaluated and verified for any future land surveying or related usage purposes.

I, Kevin P. Bixby hereby certify that I am duly licensed as a Professional Land Surveyor in the State of Wisconsin; that the location of this survey landmark was referenced by me or under my direct supervision and/or control; and that the information shown is true and correct to the best of my knowledge and belief.

SIGNED *Kevin Bixby*

DATE 05/08/09

REVISED 10/10/02