

### SURVEY LANDMARK PRESERVATION RECORD

It is the primary purpose of this record to preserve the location of any survey landmark subject to disturbance, removal or to be rendered inaccessible, as provided by Section 59.74(2), Perpetuation of Landmarks, Wisconsin Revised Statutes.

County: <b>Oneida</b>	City, Village, Town: <b>Newbold</b>	Section: <b>8</b>	Town: <b>37 North</b>	Range: <b>8 East</b>
--------------------------	--	----------------------	--------------------------	-------------------------

Describe survey landmark found or reset and origin if known, such as being a 1/16 corner, called for in a deed or shown on record land survey map or plat, also note location by Gov't. Lot, 1/4-1/4 section or other PLSS subdivisional tract.

Show approximate location of survey landmark on this Section diagram:

1.3" dia. iron pipe shown on Survey Map No. C1310

MAP #	L2647
DATE FILED	9-18-09
BY	PLS
DESCRIPTION FILED	
ONEIDA CO. SURVEYOR'S OFFICE	

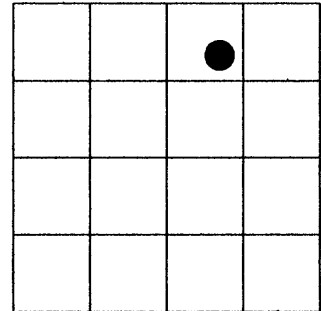

3708083313

Plan view map of survey landmark location with bearing and distance ties to a minimum of four (4) described witness or reference monuments of concrete, natural stone, metal, live bearing trees or equivalent material and/or described GPS method and precision.

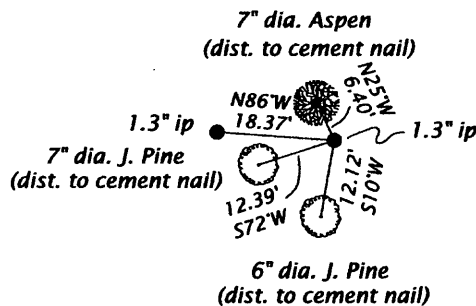

Bearings Magnetic



Scale: 1" = 30'

Pre-construction

Seal:



#### PROFESSIONAL LAND SURVEYOR CERTIFICATE:

This survey landmark is being referenced for the express purpose of location preservation and is not intended as an attestation of the legal significance and/or positional accuracy thereof.

Therefore, this survey landmark location should be further evaluated and verified for any future land surveying or related usage purposes.

I, Michael L. Oestreich, hereby certify that I am duly licensed as a Professional Land Surveyor in the State of Wisconsin; that the location of this survey landmark was referenced by me or under my direct supervision and/or control; and that the information shown is true and correct to the best of my knowledge and belief.

Signed: Michael L. Oestreich Date: 7/30/09