

# LAND PRESERVATION RECORD

IT IS THE PURPOSE OF THIS RECORD TO PRESERVE THE LOCATION OF A SURVEY OR LAND CORNER MONUMENT THAT MAY BE DISTURBED, REMOVED OR INACCESSIBLE DUE TO ROAD CONSTRUCTION OR OTHER ACTIVITY.

<b>COUNTY:</b> ONEIDA	<b>CITY, VILLAGE, TOWN:</b> TOWN OF PIEHL	<b>SECTION:</b> 29	<b>TOWN:</b> 37 NORTH	<b>RANGE:</b> 11 EAST
--------------------------	--	-----------------------	--------------------------	--------------------------

DESCRIBE WHAT WAS FOUND, IT'S LOCATION AND ORIGIN. IF KNOWN, DESCRIBE IF THE MONUMENT FOUND IS A 1/16 CORNER OR OTHER SUBDIVISIONAL CORNER; A MONUMENT CALLED FOR IN A DEED; A MONUMENT SHOWN ON A SURVEY MAPS OR PLAT, ETC., AND IN WHAT GOV'T LOT, 1/4-1/4 SECTION OR SUBDIVISION THE MONUMENT IS LOCATED.

AUGUST 27, 1999 - RECOVERY OF BY BILL ROHDE. SEE PREVIOUS MONUMENT LOCATION RECORD 1 1/2" IRON PIPE BY BILL ROHDE. SEE PREVIOUS MONUMENT LOCATION RECORD FOR RECORDED BEARINGS AND DISTANCES.

JUNE 3, 2011-RECOVERED IRON PIPE AND TIES AND SET ADDITIONAL WITNESS CORNERS AS SHOWN BELOW

APPROXIMATE LOCATION WITHIN SECTION 29

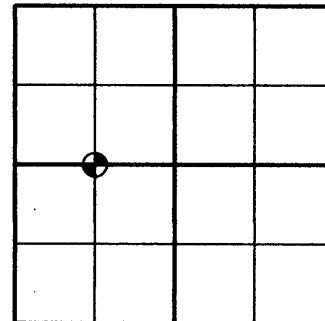

3711 29 2030  
PRE CONST TIES

MAP # **L 2767**

DATE FILED 6/14/11

BY LH

DESCRIPTION FILED .....

ONEIDA CO. SURVEYOR'S OFFICE

PLAN VIEW OF LANDMARK MONUMENT LOCATION WITH BEARING AND DISTANCE TIES TO A MINIMUM OF FOUR DESCRIBED WITNESS OR REFERENCE MONUMENTS OF CONCRETE, NATURAL STONE, METAL, LIVE BEARING TREES OR EQUIVALENT MATERIAL OR INDICATE DATUM AND COORDINATES IF TIES OUT USING GPS. INDICATE TYPE OF MONUMENT RESET.

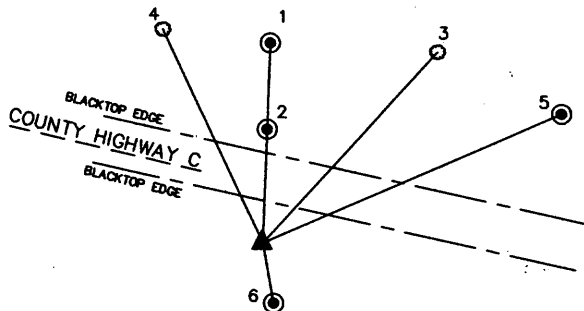

NORTH BASED ON MONUMENT RECORD BY BILL ROHDE, JANUARY 20, 2000 FROM MONUMENT TO WITNESS CORNER 1, ASSUMED TO BEAR: N 02° E

**WITNESS MONUMENT TIES:**

- 1: FOUND 1" IRON PIPE WITH STAMPED BRASS CAP, N 02° E, 105.25'
- 2: FOUND 1" IRON PIPE WITH YELLOW WITNESS CAP, N 02° E, 59.92'
- 3: BEARING TREE AS SHOWN ON MONUMENT RECORD. NOT VERIFIED
- 4: BEARING TREE AS SHOWN ON MONUMENT RECORD. NOT VERIFIED
- 5: SET 1 1/4" X 18" IRON PIPE, 1' SOUTH OF R-O-W POST, N 66°14'15" E, 169.70'
- 6: SET 1 1/4" X 18" IRON PIPE S 10°19'01" E, 32.36'

**SEAL:**

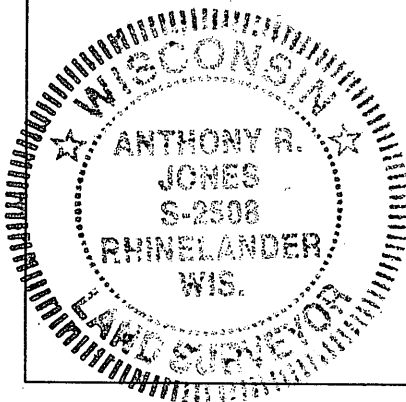

**PROFESSIONAL LAND SURVEYOR CERTIFICATE:**

THIS LAND CORNER WILL BE RESET AFTER THE RECONSTRUCTION THE ROADS AS SHOWN HEREON. THIS CORNER HAS NOT BEEN TESTED FOR ITS ACCURACY DURING THE COURSE OF THIS PRESERVATION. IT IS RECOMMENDED THAT THOSE USING THE CORNER POSITION EVALUATE AND VERIFY IT PRIOR TO USE IN A SURVEY OR OTHER USE.

I HEREBY CERTIFY THAT I AM A DULY LICENSED PROFESSIONAL LAND SURVEYOR IN THE STATE OF WISCONSIN; THAT THE LOCATION OF THIS SURVEY OR LAND CORNER WAS REFERENCED BY ME OR UNDER MY DIRECT SUPERVISION AND CONTROL AND THAT THE INFORMATION SHOWN ON THIS RECORD IS TRUE AND CORRECT TO THE BEST OF MY KNOWLEDGE AND BELIEF.

*[Signature]*  
 ANTHONY R. JONES, R.L.S. No. S-2508 6-3-11  
 \_\_\_\_\_ DATE