

L2802

E. 47°



MAP #	L2802
DATE FILED	8/22/11
BY	JH
DESCRIPTION FILED	
ONEIDA CO. SURVEYOR'S OFFICE	

Gov't. Lot 1

NE-NE

Spruce trees 60' tall by D.N.R.

Misc. storage

LP gas tank

D.N.R.

Private

Road

24'

1.55'

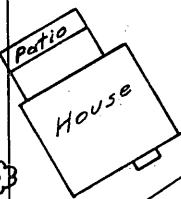

Coffen Trespass in

T 38N, R 7E, Sec. 3, Gov't. Lot 1

Oneida Co. Wis.

Scale 1 in. = 40ft.

Jan. 8, 1974

Note - Based on map by R.L. Ilg dated Sept. 1967. J.H. Coff

Choate Street

L2802

3-38-7