

LOT 2 of CSM #004046

L 2979

Part of
GOVERNMENT LOT 1

SECTION 9, TOWNSHIP 39 NORTH, RANGE 5 EAST

Town of Minocqua, Oneida County, Wisconsin

MAP # **L 2979**
 DATE FILED 8-25-14
 BY JB
 DESCRIPTION FILED
 ONEIDA CO. SURVEYOR'S OFFICE

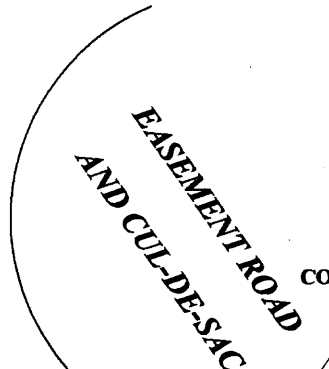
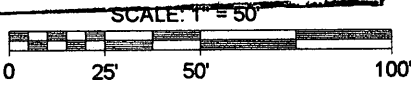

C1
 RADIUS = 60.00' (60.00')
 ARC = 32.42' (33.43')
 COORD BEARING = N 82°53'26"E (S 83°20'48"W)
 COORD LENGTH = 32.03' (33.00')

C2
 RADIUS = 60.00' (60.00')
 ARC = 32.22' (33.18')
 COORD BEARING = S 66°17'55"E (N 64°50'44"W)
 COORD LENGTH = 31.83' (32.76')

ASSUMED NORTH, BASED ON EASTERLY LOT LINE
 SHOWN HEREON WHICH BEARS SOUTH 36° 13' 13" WEST

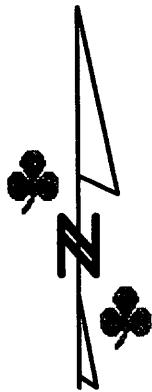

N 25°40'45"E (N 25°27'36"E)
 253.42' (253.08')

S 93°55'52"E (N 09°36'50"W)
 100.17' (100.15')

LEGEND
 ○ - 1.050" Iron Pipe Found (Outside Diameter)
 (...) - Recorded as values

- NOTES:
- 1) SURVEY PERFORMED TO MARK THE WESTERLY LINE OF THE PARCEL SHOWN HEREON.
 - 2) WATER WAY BOUNDARY / WETLAND DELINEATION MAYBE NEEDED. THE LOCATION OF THE LAKE SHORE SHOWN ON THIS SURVEY MAP IS APPROXIMATE.
 - 3) THERE WERE NO BUILDINGS ON THIS PROPERTY WHEN THE SURVEY WAS PERFORMED.

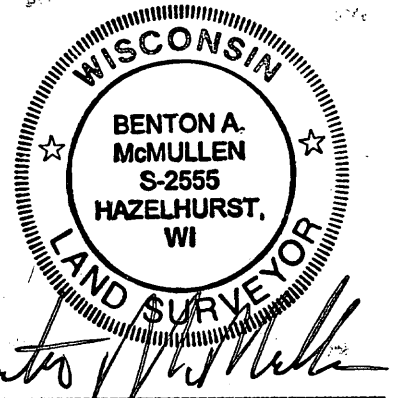

Registered Land Surveyor # S-2555

SURVEYOR'S CERTIFICATE

I, Benton A. McMullen, Wisconsin Registered Land Surveyor # S-2555, do hereby certify that I have surveyed and mapped the property shown hereon, and that I have complied with the applicable requirements of the Wisconsin Administrative Code Chapter A-E 7, and that this map represents a true and accurate survey of said property to the best of my knowledge and belief.

This survey was performed under the order of:
 MARGE NICHOLSON

This survey is made for the use of the present owners of the property, and also those who purchase, mortgage, or guarantee the title thereto within one year from date hereof.

**SQUIRREL
 LAKE**

FIELD SURVEY WORK COMPLETED ON THE
 11TH DAY OF JULY, 2014.

MCMULLEN & ASSOCIATES, INCORPORATED

♣ "Your true north surveyors and soil testers" ♣

PO BOX 51, MINOCQUA, WISCONSIN 54548
 TELEPHONE (715) 356-3011

DRAFTED BY: Benton A. McMullen

DATE: July 24, 2014

SCALE: 1" = 50'

JOB #214030

SHEET 1 OF 1

L 2979

L 2979