

MAP # **L3088**
 DATE FILED **5/12/2016**
 BY **HB**
 DESCRIPTION FILED
 ONEIDA CO. SURVEYOR'S OFFICE

QUARTER CORNER
 ONEIDA COUNTY MONUMENT
 FOUND IN PLACE

**Part of the
 NORTHWEST 1/4 OF THE SOUTHEAST 1/4
 SECTION 12, TOWNSHIP 37 NORTH, RANGE 5 EAST
 Town of Little Rice
 Oneida County, Wisconsin**

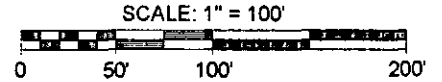
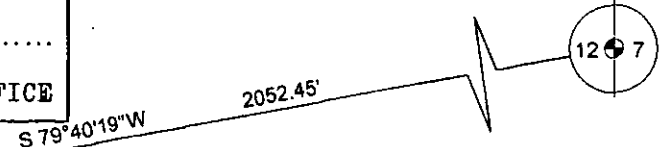

ASSUMED NORTH, BASED ON THE WEST
 LINE OF THE PARCEL SHOWN HEREON
 WHICH BEARS NORTH 0° 57' 29\"/>

LEGEND
 ○ - 1.315" Iron Pipe Found
 (...) - Recorded as values

SURVEYOR'S CERTIFICATE

I, Benton A. McMullen, Wisconsin Professional Land Surveyor # S-2555, do hereby certify that I have surveyed and mapped the property shown hereon, and that I have complied with the applicable requirements of the Wisconsin Administrative Code Chapter A-E 7, and that this map represents a true and accurate survey of said property to the best of my knowledge and belief.

This survey was performed under the order of:
 HERMAN BARTELS

MCMULLEN & ASSOCIATES, INCORPORATED

♣ "Your true north surveyors and soil testers" ♣
 PO BOX 51, MINOCQUA, WISCONSIN 54548
 TELEPHONE (715) 356-3011

DRAFTED BY: Benton A. McMullen	DATE: January 19, 2016
SCALE: 1" = 100'	JOB #215030
SHEET 1 OF 1	

N 0°56'25"E 180.16'
 (N 0°57'29"E 180.00')

N 86°34'40"E 654.87'
 (S 86°34'15"W 654.41')

EXTERIOR DESCRIPTION

Part of the Northwest 1/4 of the Southeast 1/4, Section 12, Township 37 North, Range 5 East, Town of Little Rice, Oneida County, Wisconsin as shown on a survey map by McMullen & Associates, Incorporated of Minocqua, Wisconsin dated the 19th day of January, 2016 with a job number of 215030 and previously described in document number 747818 as recorded in the Oneida County Register of Deeds office and more particularly described as follows:

Commencing at the east 1/4 corner of said section marked by an Oneida County monument; thence South 79° 40' 19" West (Assumed north based on the west line of the parcel described herein which bears North 0° 57' 29" East), a distance of 2052.45 feet to a 1.315" iron pipe near the west side of Bear Creek, said point being the POINT OF BEGINNING.

Thence meandering along said creek South 6° 46' 39" East, a distance of 340.31 feet to a 1.315" iron pipe; thence leaving said meander North 85° 10' 46" West, a distance of 700.35 feet to a 1.315" iron pipe on the easterly right-of-way of County Highway "Y"; thence along said right-of-way North 0° 57' 29" East, a distance of 240.02 feet to a 1.315" iron pipe; thence leaving said right-of-way North 86° 34' 40" East, a distance of 654.87 feet to the POINT OF BEGINNING.

Subject to any easements, restrictions, or rights of way of record or of use.

Including all those lands lying between the above described meander line and the thread of Bear Creek.

N 85°10'46"W 700.35'
 (S 85°08'12"E 700.50')

NOTES:

- 1) IRON PIPE DIAMETERS GIVEN ARE OUTSIDE DIAMETERS.
- 2) FLAGGED PARCEL LINES WITH SURVEYOR'S RIBBON ARE ONLY A REPRESENTATION OF THE PROPERTY LINE AND SHOULD NOT BE USED FOR CONSTRUCTION PURPOSES.
- 3) SURVEY PERFORMED TO FLAG / MARK THE SOUTHERLY LINE ONLY. ANY EXISTING STRUCTURES, DRIVEWAYS, WATERWAYS, ETC. WERE NOT LOCATED OR SHOWN.
- 4) IT IS NOT THE INTENT OF THIS SURVEY MAP TO SHOW ALL EASEMENTS.



Professional Land Surveyor
 # S-2555

FIELD SURVEY WORK COMPLETED ON THE
 23rd DAY OF JUNE, 2015.

COUNTY HIGHWAY "Y"