

MORTGAGE SURVEY

LOT 2, ONEIDA COUNTY CERTIFIED SURVEY MAP No. 5002, LOCATED IN THE SOUTHEAST 1/4 OF THE NORTHEAST 1/4, SECTION 23, TOWNSHIP 37 NORTH, RANGE 6 EAST, TOWN OF CASSIAN, ONEIDA COUNTY, WISCONSIN

SURVEYOR'S CERTIFICATE

I, ANTHONY R. JONES, WISCONSIN PROFESSIONAL LAND SURVEYOR No. S-2508, DO HEREBY CERTIFY THAT I HAVE MADE THIS SURVEY UNDER THE DIRECTION OF BILL GESSLER, OWNER, THAT THIS MAP, IN MY OPINION, IS A TRUE AND CORRECT REPRESENTATION OF THAT SURVEY AND THAT I HAVE COMPLIED WITH THE PROVISIONS OF CHAPTER AE-7 OF THE WISCONSIN ADMINISTRATIVE CODE.

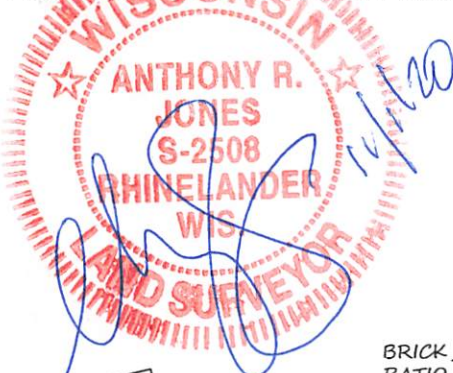

S 00°25'14" W 372.55'

N 86°12'32" W 240.03'

EAST LINE - SE/NE

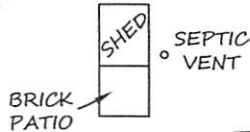

CLOTHES LINE



ORNAMENTAL FIRE HYDRANT

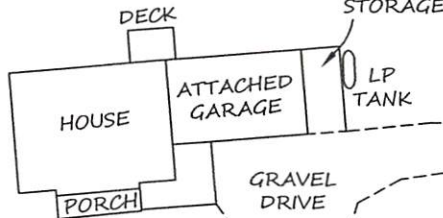

GRAVEL DRIVE

49.5'

BUCK LANE (GRAVEL ROAD)

PLANTER



N 00°25'14" E 394.37'

LOT 2
C.S.M. 5002
87,929 SQ. FT.
2.01 ACRES

LEGEND

○ FOUND 1 1/4" IRON PIPE

S 88°52'37" E 239.63'

33'

SOUTH LINE - SE/NE

33'

ROCKY RUN ROAD

33.00'

FOUND PK NAIL
E 1/4 CORNER
SEC 23-37-06
REFERENCES VERIFIED

MAP # L3254 ✓
DATE FILED 12/21/2020
BY AP
DESCRIBED BY
ONEIDA CO. SURVEYOR'S OFFICE

DRAWN BY: ARJ	DATE: 10/31/2020	William Gessler SITE: 9418 Rocky Run Rd Harshaw, WI 54529 PIN: CA 341-1
FIELD WORK COMPLETED ON:	DATE: 11/1/2020	
SCALE: 1"=50'	SHEET: 1/1	PROJECT NUMBER: 2020-102



A.R. JONES LAND SURVEYING, LLC
2788 SCHWARZ RD.
RHINELANDER, WI 54501
715.894.7231 arjsurvey@charter.net