

L3266

L3266

**Lot 22 of CSM #245, located in Government Lot 4, Section 28  
Township 39 North, Range 9 East, Town of Sugar Camp,  
Oneida County, Wisconsin**

MAP # **L 3266** ✓  
DATE FILED **6-22-2021**  
BY **JAP**  
DESCRIPTION FILED .....  
**ONEIDA CO. SURVEYOR'S OFFICE**

Bearings referenced to the Easterly R/W line  
of Marquardt Rd. previously recorded as N 03°40'00" W



Marquardt Rd.

(198.16')  
198.16'  
N 03°40'00" W  
(N 03°40'00" W)

Lot 23  
CSM #245

(S 89°33'25" E)  
S 89°40'21" E  
330.27'  
(330.25')

Lot 21  
CSM #246  
(S 03°40'00" E)  
S 03°47'35" E  
195.47'  
(195.60')

**Lot 22  
CSM #245  
1.49 acres  
64880 sq ft**

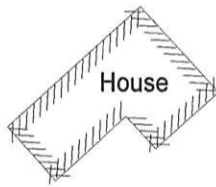

Private Rd.

(198.16')  
198.16'

(West)  
S 89°51'23" W  
330.52'  
(330.28')

Doc. #541775

66'

66' easement to Town Rd. granted in  
Vol. 588, Pg. 555 of Oneida County records

**SCALE  
1" = 60'**

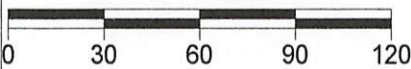

NORTH COAST SURVEYING  
1715 MELODY LANE  
RHINELANDER, WI 54501  
715-490-0892  
NORTHCOASTSURVEYING.COM

Boundary Survey for:  
**Mark and Heather  
Liebscher**

Drawing #	Date	Drafted by
2115	5/26/2021	CLO

**LEGEND**

- Set 1" X 24" Iron Pipe Weighing min. 1.13 lb./lin.ft.
- Found 1" Iron Pipe
- ⊙ Found 1.5" Iron Pipe
- ( ) Previously recorded as

I, Charles L. Oleinik, Professional Land Surveyor in the State of Wisconsin, hereby certify: that I have surveyed and mapped the parcel shown hereon; that said survey and map are correct to the best of my knowledge and belief; that I have complied with the applicable requirements of Chapter A-E 7 of Wisconsin Administrative Code in completion thereof.

Charles L. Oleinik, PLS

**5-26-21**

Date

L3266

L3266