



BORDERLAND SURVEYING, LLC

Chad A. Besaw, PLS #3029
borderlandsurveying.llc@gmail.com
715-218-2854 // Merrill, WI

Owner:
Corey & Kelsey Brandenburg
3825 Mitchell Ln.
Harshaw, WI 54529

Drawn by: CAB
Field work completed: Mar. - Apr. 2022
Project #: 1007-35-37-6E-Brandenburg
Sheet: 1 of 2

PLAT OF SURVEY

LOCATED IN GOVERNMENT LOT 11, SECTION 35, TOWNSHIP 37 NORTH, RANGE 6 EAST,
TOWN OF CASSIAN, ONEIDA COUNTY, WISCONSIN

MAP #	L3294	✓
DATE FILED:	6/17/2022	
BY:	JAP	
DESCRIPTION FILED:		✓
ONEIDA CO. SURVEYOR'S OFFICE		

Center of Section
1.75" Iron Rod Found

(N88°25'56"W 2613.58')
N88°19'16"W 2614.02'
North line G.L. 11

East 1/4 Corner
2" O.D. Iron Pipe

Survey Notes:

Purpose of survey was to mark the South property line. Said line marked with wooden lath and flagging.
Ordinary High Water Mark (O.W.H.M.) is approximate. Any land below the ordinary high water mark of a lake or navigable stream is subject to the public trust in navigable waters that is established under article IX, section 1, of the state constitution.
Bog marsh area was flooded at time of survey and determined from field survey and aerial imagery.

LEGEND

- Gov't corner found and verified as noted
- 1.25" O.D. Iron Pipe Found
- Calculated Position
- Record Information

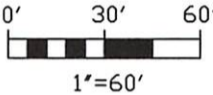

Bearings are Oneida County WISCRS
NAD83(2011) to which the East Line of
the SE 1/4 of Sec. 35, T37N, R6E
measured to bear S00°31'30"E



East
Mitchell

MITCHELL LANE

Approx. O.H.W.M.
meander line
Lake

bog marsh

bog marsh

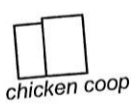

chicken coop



septic vent



garage

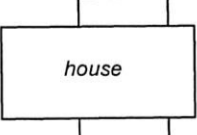

house

PARCEL -1-

81,230 +/- S.F.
1.86 +/- AC.
(area includes lands between
O.H.W.M. and meander line)



well

1" pinched I.P.
bears N78°W 3.0'

P.O.B.

2.5" axle shaft
bears S12°W 1.98'
N75°52'58"W 96.60'
(N75°14'00"W 96.60')

0.5" I.R. and 0.75" I.P.
bear S20°E 1.25'

DOC. #822776

Southeast Corner
Aluminum Capped
Monument

L3294

L3294



BORDERLAND SURVEYING, LLC

Chad A. Besaw. PLS #3029
borderlandsurveying.llc@gmail.com
715-218-2854 // Merrill, WI

Owner:
Corey & Kelsey Brandenburg
3825 Mitchell Ln.
Harshaw, WI 54529

Drawn by: CAB
Field work completed: Mar. - Apr. 2022
Project #: 1007-35-37-6E-Brandenburg
Sheet: 2 of 2

PLAT OF SURVEY

LOCATED IN GOVERNMENT LOT 11, SECTION 35, TOWNSHIP 37 NORTH, RANGE 6 EAST,
TOWN OF CASSIAN, ONEIDA COUNTY, WISCONSIN

Surveyor's Certificate:

I, Chad A. Besaw, Wisconsin Professional Land Surveyor #S-3029, hereby certify: That in full compliance with the provisions of Chapter AE-7 of the Wisconsin Administrative Code, and under the direction of Kelsey Brandenburg, I have surveyed, and mapped this plat; that such plat correctly represents all exterior boundaries of the land surveyed to the best of my knowledge and belief; and that this land is located in Government Lot 11 of Section 35, Township 37 North, Range 06 East, Town of Cassian, Oneida County, Wisconsin containing 1.86 acres, more or less, of land including those lands lying between a meander line and the ordinary high water mark as surveyed in March of 2022; being more fully described as follows:

Commencing at the East Quarter Corner of said Section 35; Thence along the East line of said Government Lot 11, S00°31'30"E for a distance of 477.69 feet to the Northerly line of the remaining lands described in Document Number 822776; Thence along said Northerly line, S81°33'26"W for a distance of 33.47 feet to the West right of way line of Mitchell Lane, being the **PLACE OF BEGINNING**;

Thence continuing along said Northerly line, S81°33'26"W for a distance of 260.62 feet;

Thence N75°52'58"W for a distance of 96.60 feet, to a meander line along the Easterly shore of East Mitchell Lake;

Thence along said meander line for the following courses:

N04°21'52"W for a distance of 141.54 feet;

N39°40'35"E for a distance of 168.49 feet;

S70°42'36"E for a distance of 27.97 feet;

S14°11'03"W for a distance of 123.89 feet;

S63°26'06"E for a distance of 42.80 feet;

N61°03'39"E for a distance of 238.68 feet;

N00°33'24"E for a distance of 210.74 feet to a line 50 feet distant from and parallel to the North line of said Government Lot 11, being the South line of lands described in Document Number 609319;

Thence along said line, S88°19'16"E for a distance of 5.36 feet, to the West right of way line of Mitchell Lane;

Thence along said West right of way line S00°32'18"E for a distance of 433.71 feet to the **PLACE OF BEGINNING**;

Said described lateral lot lines extend to the Easterly shore of East Mitchell Lake, and include all those lands lying between the meander line and the ordinary high water mark.

Together with and subject to any easements, restrictions, reservations, dedications, and rights-of-way of record.

Dated this 29th day of April, 2022

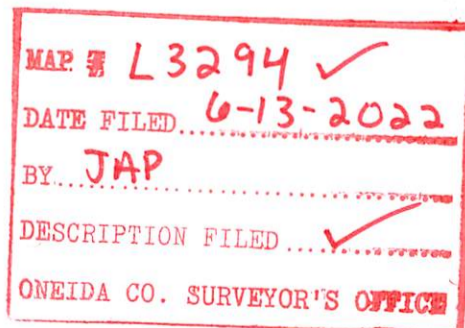

L3294

L3294