

RECORD AND CERTIFICATION OF U.S.
PUBLIC LAND SURVEY CONTROL STATION
E-D-716-72

State of Wisconsin Department of Surveying and Mapping

RECEIVED & FILED # 1413
Onondaga County Surveyor's Office
Date JUN 23 1968
By J.M.
OCS Area # Chief

District <u>7</u>	Project I. D. <u>1173-0-04</u>	Located by <u>Jack Wallin, Surveyor</u>			
Corner <u>N.W.</u>	<u>25</u> SECTION	Township <u>36 N</u>	Range (E,W) <u>6 E</u>	County <u>Onondaga</u>	
Wisconsin Coordinates CORNER	East (X) <u>2,078,544.15</u>	North (Y) <u>152,758.33</u>	Elevation (Z)	Zone <u>N.</u>	
Control Station Name	East (X)	North (Y)	Elevation (Z)	Zone	
Horizontal — <u>NORTH AMERICAN, 1927</u>		CONTROL DATUM Vertical — <u>MEAN SEA LEVEL, 1929 ADJUSTMENT</u>			
Horizontal — <u>2ND</u> Order		SURVEY CONTROL Vertical — _____ Order			

SKETCH

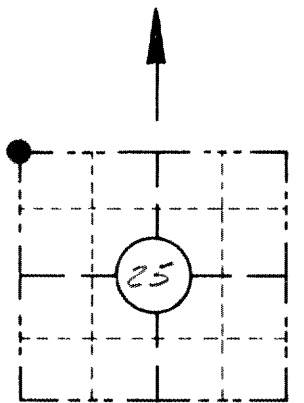

LOCATION SKETCH

(Location of landmark indicated by "X")

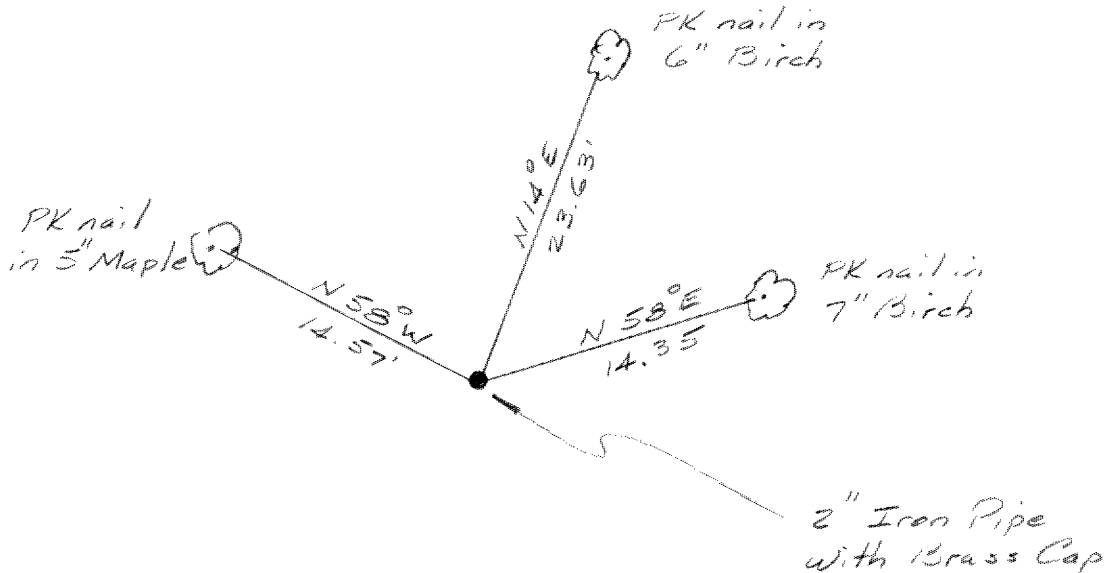

I hereby certify that on the 1 day of May 1974, that I did locate the above corner which was evidenced by a 2" Iron Pipe and Brass Cap; I further certify that to perpetuate the location of such corner I did, at the exact location thereof, ~~place a permanent marker consisting of~~ leave the 2" Iron Pipe and Brass Cap intact.; I further certify that I did establish 3 references ~~or witness monuments~~ consisting of a 5" Maple, a 6" Birch and a 7" Birch

located as shown above:

Note: All work done by Jack Wallin under the supervision of:

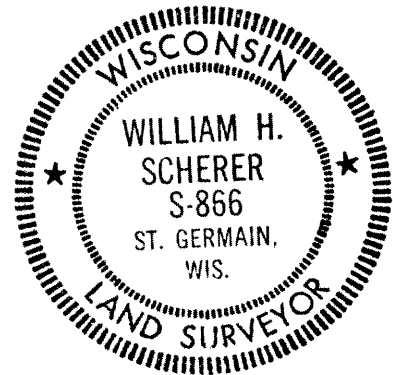

SEAL

Signature Registered Land Surveyor <u>William H. Scherer</u>	Registration No. <u>S-866</u>	Title <u>Survey Supervisor</u>
---	----------------------------------	-----------------------------------

CORNER N.W.
SECTION 25
TOWN 36 N
RANGE 6 E