

FIELD SURVEY NOTES
PRESERVATION OF LANDMARKS
 (Pursuant to Section 59.635(7) Wisconsin Statutes)

Wisconsin Department of Transportation
 D-2-107-01

RECEIVED & FILED # **L433**
 Oneida County Surveyor's Office
 Date: **JUN 27 1983**
 By: *[Signature]*
 OCS Area #... **W-X-E**...

COUNTY ONEIDA		
TOWN PELICAN		
HIGHWAY C.T.H. "CC"		
SECTION 5	TOWNSHIP 36N	RANGE 9E
TYPE OF LANDMARK R.R. SPIKE REMOVED BY CONST		

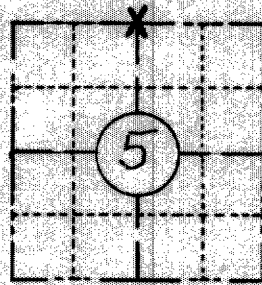

LOCATION SKETCH
 (Location of landmark indicated by "x")

This space for copy of field notes or ties to the above described landmarks

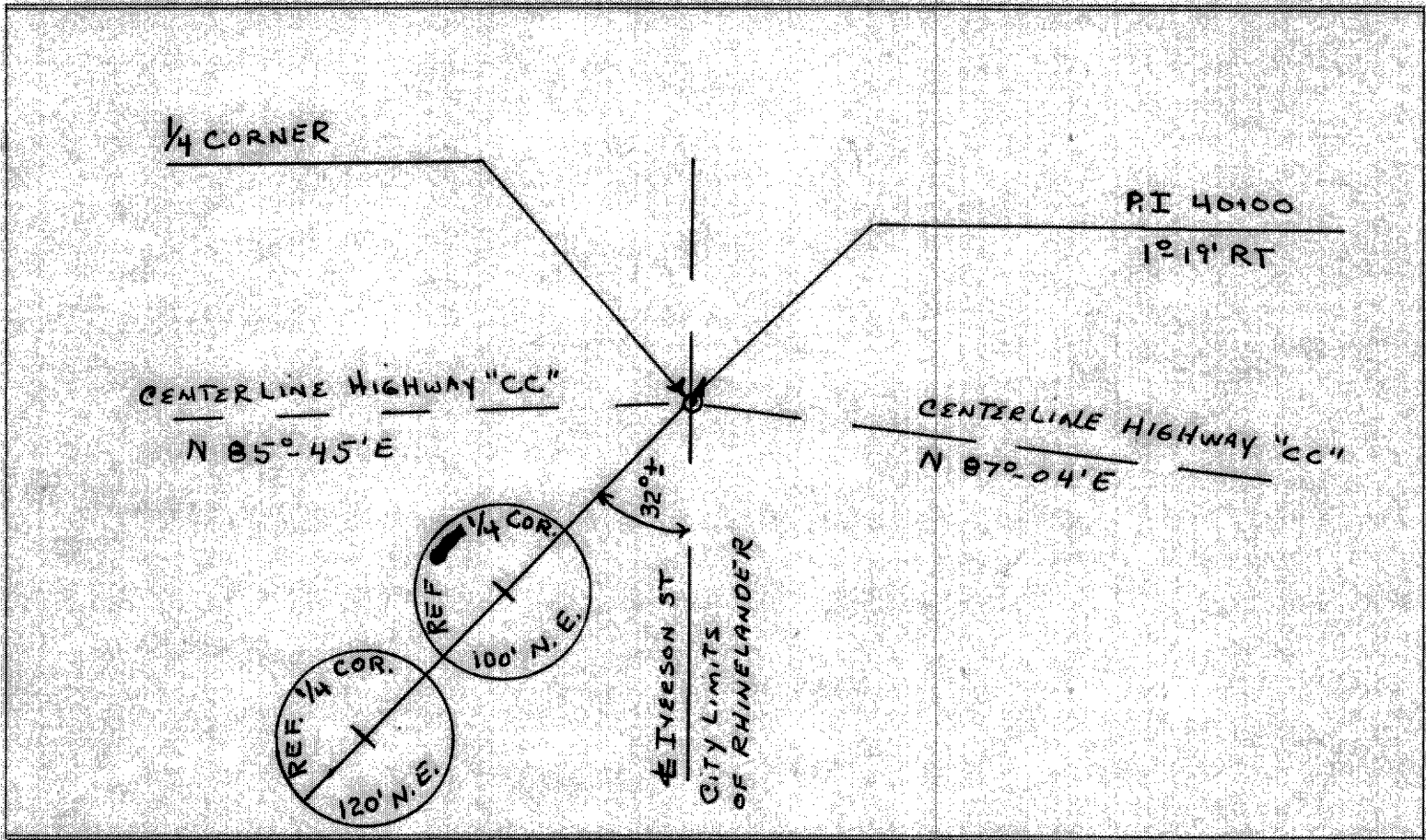

FILED UNDER PROJECT NUMBER SU0706(8) & S0706(6)		
SHC DISTRICT OFFICE NUMBER 7	CITY Rhinelande	COUNTY ONEIDA
LOCATED OR ESTABLISHED BY NAME R. Bonneville TITLE Project Engineer DATE 5-18-70		

COUNTY CLERK'S OFFICE COUNTY OF WISCONSIN } 55	
DATE RECEIVED FOR RECORD	DATE COPY SENT TO COUNTY SURVEYOR
SIGNATURE OF COUNTY CLERK	