

RECEIVED & FILED # **L45**
 Oneida County Surveyor's Office
 Date... **FEB. 1. 1 1968**
 By... **MJH**
 OCS Area #.....

CERTIFIED BOUNDARY LINE ESTABLISHMENT

Being the East Line SE 1/4 SE 1/4 Section 2, Township 38 North, Range 11 East, 4th P.M.
 County of Oneida, State of Wisconsin

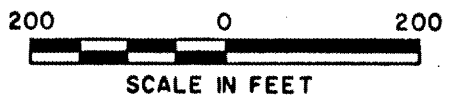

SURVEY NOTES

This survey of the east line SE 1/4 SE 1/4 of section 2, township 38 north, range 11 east, fourth principal meridian, was made by the U.S. Department of Agriculture, Forest Service.

The purpose of this survey is to locate and mark the east line SE 1/4 SE 1/4 and to locate an existing building in relation to this line.

The U.S. Government acquired title to the SE 1/4 SE 1/4 of section 2 in 1931.

LEGEND

- 1941 GLO Dependent Resurvey Monument
 - 2 inch I.D. by 5 foot long galvanized iron pipe capped with 3 inch brass tablet stamped to identify corner.
 - Line post
 - Building
- U.S.A. U.S. Government Land

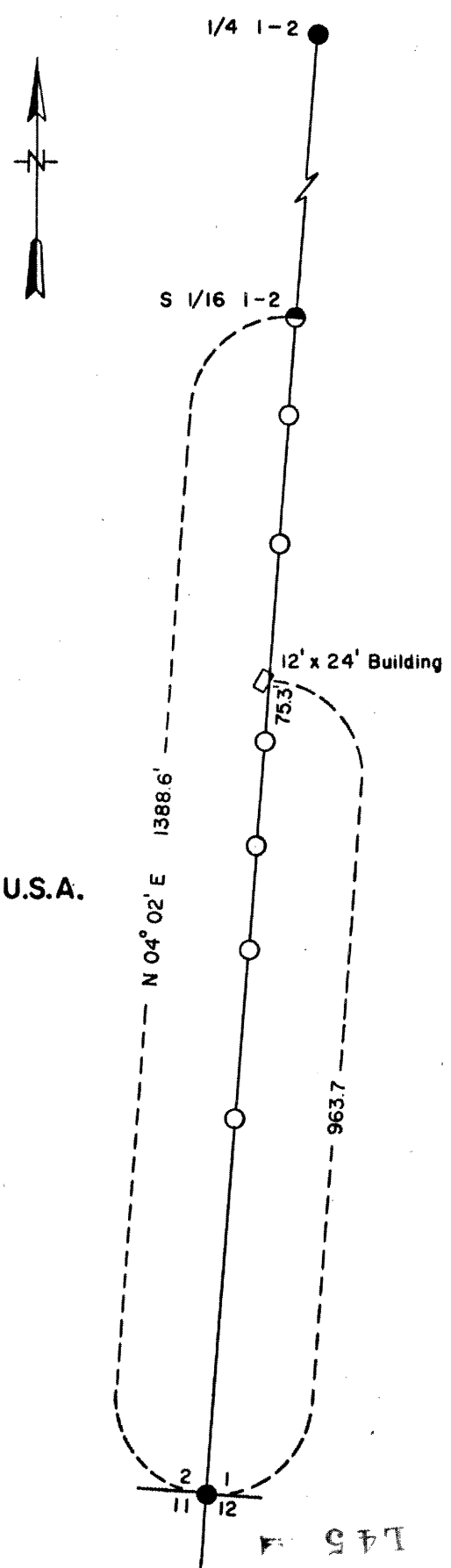

HERBERT MOORE
 County Surveyor
 Oneida County, Wisconsin
 Feb 14 1968

Memo
 Mar 14-72

288

CERTIFIED BOUNDARY LINE ESTABLISHMENT

Being the East Line SE 1/4 SE 1/4 Section 2, Township 38 North, Range 11 East, 4th P.M.
County of Oneida, State of Wisconsin

Corners Recovered

1. Section Corner to Sections 1-2-11-12.
Position marked by monument from 1941 General Land Office dependent resurvey of the east one third of this township.
2. Quarter Corner to Sections 1-2.
Position marked by monument from 1941 General Land Office dependent resurvey of the east one third of this township.

Corner Established

1. South Sixteenth Corner to Sections 1-2.
Position established at midpoint and on line between southeast corner and east quarter corner of section 2.
Corner references established:

Red pine 16"	N.34°E.	27.6 feet
Red pine 14"	N.56°E.	7.0 feet
White pine 14"	S.21°W.	40.9 feet
NW corner cabin	S.45°E.	18.0 feet
Sign post	SW	1 foot

SURVEYOR'S AFFIDAVIT

State of Wisconsin))
County of Forest) ss

I, Jean F. Resvick, land surveyor, U.S. Forest Service, and a registered land surveyor in the State of Wisconsin, hereby certify that I have surveyed and marked the east line SE 1/4 SE 1/4 section 2, township 38 north, range 11 east, fourth principal meridian, State of Wisconsin.

The plat map and the survey notes are a correct representation of the corners recovered and established, section line marked, and building location in relation to the section line.



Jean F. Resvick

Land Surveyor, U.S. Forest Service
RLS State of Wisconsin
Certificate S-802