

FIELD SURVEY NOTES
PRESERVATION OF LANDMARKS
 (Pursuant to Section 59.635(7) Wisconsin Statutes)

State Highway **L 460**
 RECEIVED BY **FILED** Wisconsin
 Form E-D-707-85
 Oneida County Surveyor's Office
 Date **JUN 27 1968**
 By **M**
 OCS Area #

COUNTY Oneida		
TOWN Monico		
HIGHWAY USH 45		
SECTION 4 + 9	TOWNSHIP 36 N	RANGE 11 E
TYPE OF LANDMARK 1/4 Cor. 5q'd Wood Post		

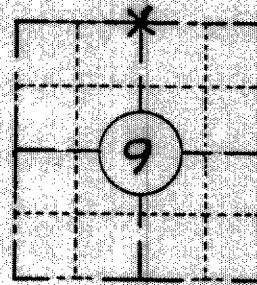

LOCATION SKETCH
 (Location of landmark indicated by "x")

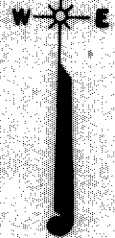

This space for copy of field notes or ties to the above described landmarks

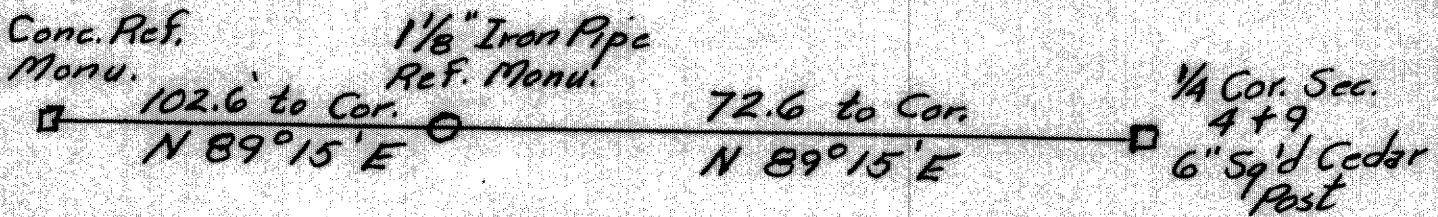

FILED UNDER PROJECT NUMBER T09-2(43)			COUNTY CLERK'S OFFICE COUNTY OF ONEIDA WISCONSIN } 55	
SHC DISTRICT OFFICE NUMBER 7	CITY Rhineland	COUNTY Oneida	DATE RECEIVED FOR RECORD 2-17-69	DATE COPY SENT TO COUNTY SURVEYOR 2-17-69
LOCATED OR ESTABLISHED BY NAME H.J. Ohm			SIGNATURE OF COUNTY CLERK J.B. Usage	
TITLE Proj. Engr. DATE 7-10-68				