

000 10-39-11 Jan 12-1916

Station 19-

39-11

D.A.

By Vaughn

Springfield, Mo

Over the Co. Survey

Vaughn's Note

19-39-11

4564

Sec. 19-39-11  
 By. D. H. Vaughn  
 County Surveyor  
 Canada County

1/12/16

825	21
59	
14	81
4	12
68	63

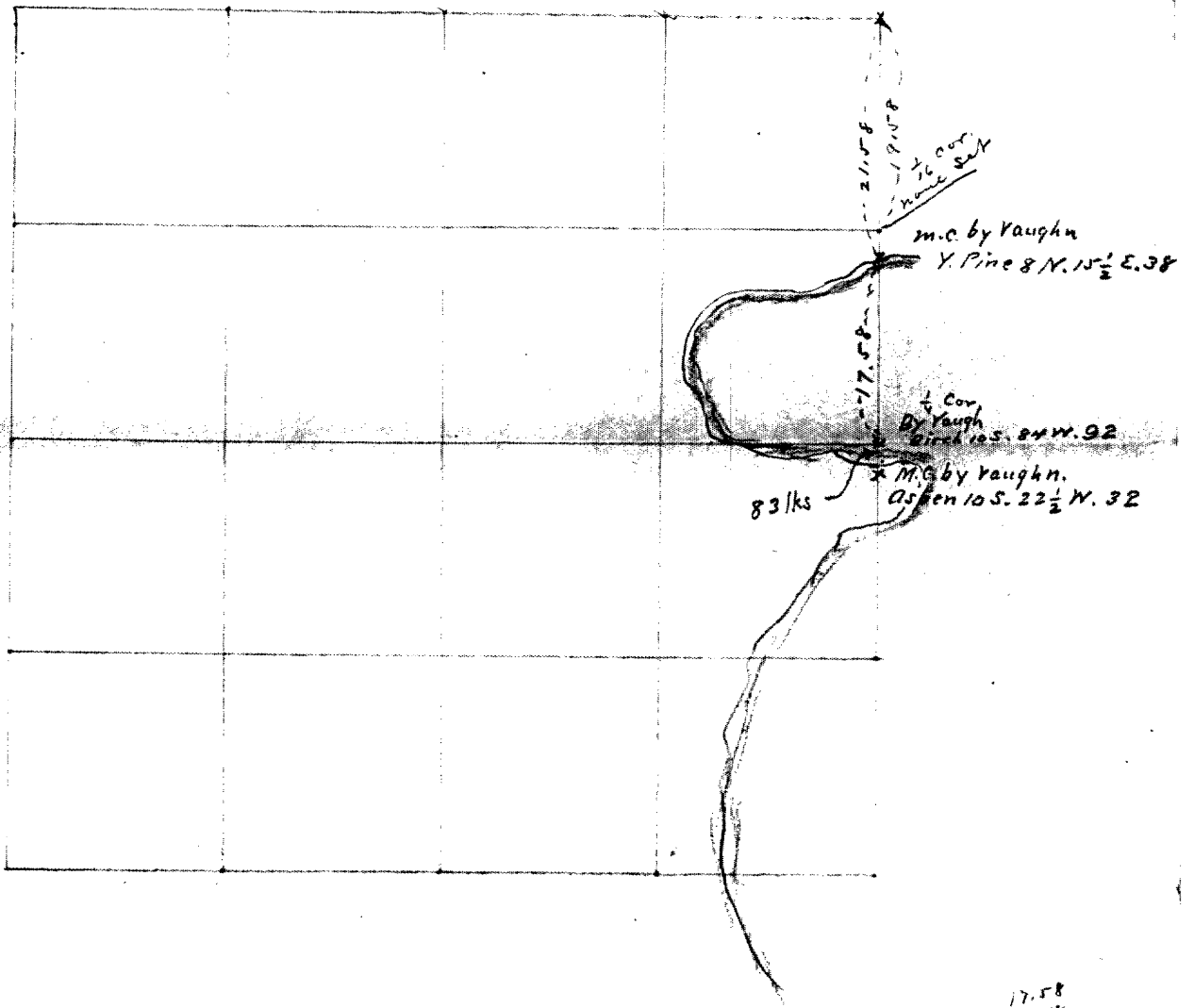

17	58
26	58
37	63
54	64

4564-1

4564-1

RECEIVED & FILED #.....
On of County Surveyor's Office
<b>Aug 27 1887</b>
Date.....
By.....
CCS Area #.....

HANDLES LAND ON SMALL COMMISSION

LAND LOOKED AFTER FOR NON-RESIDENTS

D. H. VAUGHAN

County Surveyor, Oneida County

LUMBER INSPECTOR, 17TH DISTRICT WISCONSIN

Mr J P Hendry  
Clean water Lake Wis

RHINELANDER, WIS. Nov 23 1916

Dear Sir - Am sending <sup>copy</sup> my map for Sec 19, 39, 11.  
 Did not do any work in 20 & 4 on the line between 1930  
 as given in the map. There is a W. Pine stump on west  
 side of Lake marked for M.C. but it is not. The "Goat" feed  
 pole for two Bunch. which originally stood 44 rods north of  
 this stump.

Truly yours

D H Vaughan

Send me \$1.00 for notes. It took me over two hours to copy them

D H V

See 19-39-11 E Jan 12-1916

South from corner to 17-18-19 & 20

Chains

Var 4° E

2156

fell 78 lks east of meander corner.  
found the oak B.T. Set M.C. on ice 40 lks  
from shore of lake and made new bearings

{ S. Pine } 8 N 15 1/2 E 38

3999

Over Lake to Meander corner

found stump of original B.T. Set M.C.  
on ice { Ashen } 10 S 22 1/2 W 32.

Found distance between meander  
corners 78 links short proportioned  
shortage and set 1/4 Post on ice 83 lks  
north of me. { Birch } 10 S 84 W 92.

East from West 1/4 Post Var 5° West  
on road.

9611

fell 85 lks South of 1/4 P on ice

North from South 1/4 Post on ice which  
I set by proportional measurement, no bearings

1970

leave lake

Var 4° E

6437

fell 77 1/2 W of 1/4 N 1/4 P original bearings  
corrected Var 1° 35' E

Course of E & W 4 1/2 West.

Set center of section at intersection of  
corrected 1/4 lines nothing for bearings  
Post sets on north side of road about 2,00  
links East of Chen Swamp Post 4x4 inches  
and is of Oak

Over

Distance from center to N 1/4 Post 33.23

" " " S " " 21.14

" " " E " " 43.77

" " " W " " 52.34

Chain

250

5746

East from SW corner Var 4° E

leave plow

to lake set m.c original bearings given

{ 00K 10 S 53 1/2 W 11 1/2

Found an error between corner on m.c of 8.81. Govt. distance is 4265 my distance is 5146 proportioned errorum & set 1/8 Post 3407 East of SW corner and 1739 West of m.c.

Set 1/8 Post West of center by Proportional measurement at 3051 East of West 1/4 Post

{ fence Post S 16 W 58

{ " " S 11 1/2 E 60

North from W 1/8 Post on South line Var 5° E 4015 full 3 links East of 1/8 P

Set 1/16 Post in center of SW 1/4

{ W Pine 10 N 38 W 17 1/4

East from 1/16 Post in SW 1/4 Var 4 1/2 W

2463 full 43 South of 1/8 P on N.E South of center of section. Corrected line met to shore of lake & set m.c. Bines 12315 W 12.

N. from SW corner Var 3 1/2 E

10.00

4021

leave plow

full 75 3/4 W of corner in road east of school house