

D. H. VAUGHAN  
COUNTY SURVEYOR, ONEIDA COUNTY

LUMBER INSPECTOR, 17TH, DISTRICT WISCONSIN

RHINELANDER, WIS. Dec. 7<sup>th</sup> 1912

J. A. Milendy  
Shawano wis

Dear Sir

Have just returned 16.37.13-E.

I am enclosing copy of Govt. filed of Sec. 27.35-10 as requested. I have not done any work in this section. Last May the Chairman of the Town asked me to come and plat a cemetery in this section, but I was very busy and sent my son to do the work. I have talked with my son in regard to this work and find the deed given by your man Schaeneck calls for 208 feet square in the NE corner of NW. SW. Mr Schaeneck had measured out this piece and the town had cleared it ready for platting. My son told them it would be necessary to run the  $\frac{1}{4}$  lines and establish the  $\frac{1}{8}$  P. West of center. This they did and found the land which they had prepared was not the land deeded to the town.

There is a road which was supposed to be on the E+W  $\frac{1}{4}$  line, but my son tells me it north of the  $\frac{1}{4}$  line quite a little. After my son had run the  $\frac{1}{4}$  lines he set the center of the section but Mr Keeler

# D. H. VAUGHAN

## COUNTY SURVEYOR, ONEIDA COUNTY

LUMBER INSPECTOR, 17TH. DISTRICT WISCONSIN

RHINELANDER, WIS. .... 191...

2

(the chairman) had him drive the post level or little below the surface, and requested <sup>him</sup> not mark up any bearing and the same thing happened at the 1/8 P. west of the center. It seems the line runs through Mr Schoeneck's field and he is not getting <sup>all</sup> the land he had fenced in. The town has fenced it. They gave Mr Schoeneck notice to mow his fence, which he refused to do and I am told the town mowed it for him. I think this gives you an idea of what the trouble is.

Mr Schoeneck's deed of NW SW reserves 50 links on north ~~side~~ side for road. Mr Keeler the chairman owns SW NW and his deed calls for a reservation of two rods wide on south side. The records show the road is on the 1/4 line, and it is not there. The deed given by Mr Schoeneck to the <sup>town</sup> calls for land lying south of the road. In other words they are to have 208 feet square ~~exclusion~~ exclusion of road so the 1/8 P my son set would be 50 links north of cemetery grounds which are fenced in and which I have promised to plat in the spring trusting the information given will be of service to you. I am truly yours

D H Vaughan

Entomol. Socia.

Nov. 17. 1912

Mr. F. G. Mendenby

Dear Sir

I wrote to you a week ago  
and asking you whether you  
could do some surveying for  
me. and how much you  
would charge to run two miles  
of line. I have the two quarter

lines to run. Lynn Neighbour  
surveyed same last summer  
for the Town but as I am  
not satisfied with his work  
and want a new survey  
made of same.

I was advised by Mr. Doan  
from Antigo to call on you  
as he thought you could help

me out.

I have the 2.50. quarter of the 8.50  
quarter in Dec. 27. Tomorrow 3.50 R. 10.50

I have no field notes of same

I wished you would let me

know when you could come

hoping to hear from you soon

Yours.

Adolph Schanck

P.S. have not had an answer  
from you as yet

8.27-35-10

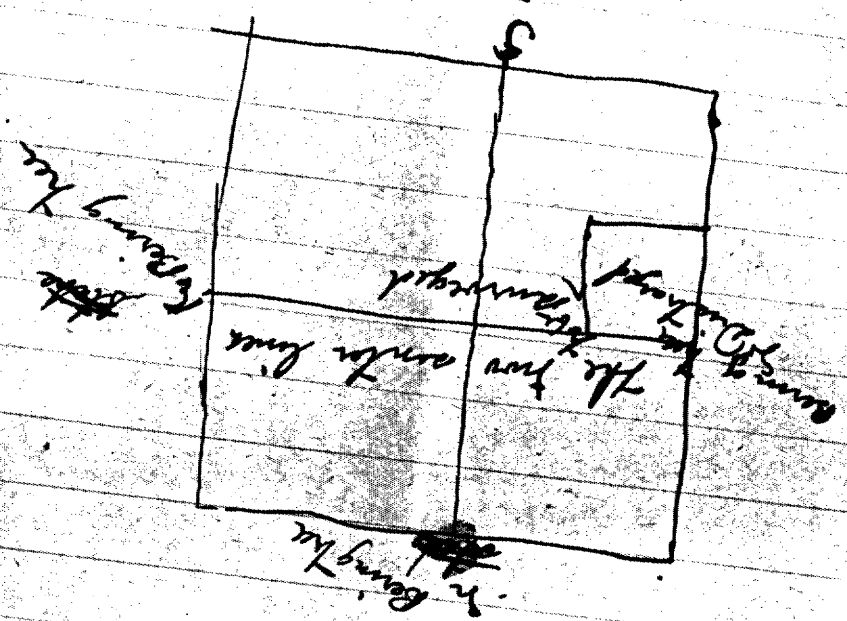

Anteserial signs  
Nov 26<sup>th</sup> 1912

Mr J. A. Sweeney  
Skowano Wis.

Dear Sir  
Your letter of the 20<sup>th</sup> received  
and am willing to have you  
come up and run the two  
quarter lines.

I think you will not have  
much trouble with quarter  
poles as the old Boring Boring  
trees are there yet. That is  
three of them and the other  
Boring stump was destroyed  
a year ago last summer  
but some roots are still there  
there was no other Surveyor  
that run these lines that I  
now of.

The reason that I am in  
doubt of Lynn Planghens  
Survey is this. That he did not  
set any stakes of any kind  
showing me where I am at  
and a note that some of his  
work has been changed in this  
country.

Please let me know when  
you could come up  
and bring Field Notes of same

Yours  
Adolph Schrock

if you come from the South  
it would be best for you  
to go to Pelican, and take the  
train that leaves Pelican at  
6 o'clock A.M. to Bratt Jet  
and change for Enterprise  
and if you come from the  
South, you ~~can~~ go to Bratt  
Jet, and step in to the  
train leaving for Enterprise  
that is if you come on  
the train leaving Pelican at  
6 o'clock A.M.  
Please let me know when  
you are coming, and how  
you can arrange it in  
getting there.  
Yours Truly  
Edw. H. Schoenly

Enterprise, Wis. Dec 16-1912  
M. J. G. Snelandy

Shawano, Wis.

Dear Sir:-

Yours of the 4<sup>th</sup> of Dec received  
will be ready for you any  
time you can come up.  
If you let me know in  
time when you are  
coming, will meet you  
at Pelican, if you can  
not make connection for  
Enterprise, the train leaves  
at Bratt Jet. 6.14 A.M. and  
gets to Enterprise 6.55 A.M.  
if you can arrange it at  
6 to make this train,

Enterprise Wis.

Nov. 11, 1912

Mr. J. A. Bulerdy

Dear Sir

I am in doubt with a quarter line that Lynn Vaughan run out for the Town of Enterprise and same running along the north side of my land for Highway purposes.

I would like to have a new survey made of same I own the north west quarter of the South west quarter Town 35 Range 10 Sec 27.

of which I would like to have the 1/2 line surveyed ~~to~~ north + south and East + West. I would like to know what it would cost me to run out to a mile for your work. I have no Field notes.

I was advised by B. F. Doer to call on you and have the lines run out by you. Please let me know when you can come and how much it would cost me.

Yours

Adolph Schneck

HANDLES LAND ON SMALL COMMISSION

LAND LOOKED AFTER FOR NON RESIDENTS

D H VAUGHAN

County Surveyor, Oneida County

LUMBER INSPECTOR 17TH DISTRICT WISCONSIN

RHINELANDER WIS DEC. 15<sup>th</sup> 1912

J A Milendy  
Shawano wis

Dear Sir

Enclosed you will find field notes for west line of 27. 35-10 which I omitted when I sent you the other notes. I am sorry to have caused you any inconvenience. I am usually very careful and do not understand why I was so careless.

Truly yours

D. H. Vaughan



Copy of Govt" field notes of SEC 27-35-10 E  
 Sub-division of 35-10-E was made by James Nowlan  
 commenced Sept" 22 finished Oct" 2 - 1865

claim North between 34 & 35 Var 7° E  
 4000 Set 1/4 SEC { Sugar 12 N 35 W 15 Lks  
 8000 " Post corners 26.27.34.35 { WPine 14 N 25 W 10 Lks  
 { Birch 12 N 22 E 22 "

North between 26 & 27 Var 7° E

3250 Enter Swamp  
 4000 SET 1/4 SEC { Birch 8 S 20 E 15 Lks  
 { Hem 8 N 15 W 20 " { WPine 20 S 25 W 14 Lks  
 6450 Intersect Pelican Lake and Set M.C. { " 15 S 76 E 15 "

North bet" 33 & 34 Var 7° E

4000 SET 1/4 SEC { Lind 16 N 15 E 25 Lks  
 { Birch 10 N 37 W 30 "  
 5400 Enter Swamp

7700 Leave "

8000 cor= to 27.28.33.34 { Sugar 18 N 45 W 25 Lks } This corner is in  
 { Hem 24 N 31 E 40 " } Road. I drove an  
 iron pipe on bolt for corner. the bearings are gone now  
 but the stumps were there when I set corner. Mr Keeler  
 can show you about where the iron monument is.  
 I have set all the monuments on this line including  
 1/8 Posts.

East Random between 27 & 34 Var 7° E

7940 7940 fell 24 North of Post. West corner  
 { Hem 20 S 62 W 10 Lks  
 3970 SET 1/4 SEC { Birch 18 N 24 E 20 "  
 7940 SEC" cor=

two lines  
 East Random bet 22 & 27 Var 7° E

4000 SET 1/4 Post. { Birch 20 S 20 E 15 Lks  
 " 15 N 36 W 35 "  
 5370 Intersect Pelican Lake & Set M.C. { Birch 8 S 20 W 10 Lks  
 " 7 N 33 W 5 "

RECEIVED & FILED AS 6.7.  
 Of the County Surveyor's Office  
 MAR 2 - 1987  
 By m p  
 OCS Area #

Dec. 28<sup>th</sup> 1912

See. 27 T. 35 N. R9E 10E  
For West 1/4 Cor found  
Steel nail 1 inch in diam  
West of Orig B.T. S 10 E 15.  
N.W. Drig. B.T. blown out  
of Road

3977 1/4 ~~Section~~ Center 1/4 by  
Van Vanghan

at 1990 E. of W 1/4 S leave  
from Beaver Road in piece of  
Post by Van Vanghan 2 rods  
N. of corner of center.

E. from W 1/4 S vac.

77.56 1/3 ~~Section~~ E 1/4 S  
for which set an 8' pin  
in middle of corner  
Star corner

Orig B.T. S 20 E 15

Strip of vein, Hen B.T.  
N 15 W 11 1/2 set Cedar

Settes 3 Rods N + S.  
Herman with marker Chn.

Van Housa

Collect Schumaker  
Gustaf Schumaker } NY  
Gustaf Selznick

Point of intersection of 4 lines  
2 1/4 Rods E of center by

by Van Vanghan - planted  
stone marker x along side  
of Decayed maple stump  
about 20" in diam  
Dec. 29 - 1912

Temporary Center on E + W 1/4 line  
39.77 1/4 E of W 1/4 S  
Yac of E + W 1/4 line at N 1/4 S. 20 E

S. from Temp. C 1/4 S vac. 30 1/4 E  
3777 1/2 vac 10 1/4 E of 8 1/4 S

From S 1/4 S found Original  
bearing surface, Orig B.T. 20  
B.T. N. 24 E 28 1/2 Strip of

Orig. Hen B.T. S 62 W 10 1/2  
Drove Cedar Post 3 x 3 x 4 1/2

in place of being stone  
and placed stone  
near Post Dec 29 - 1912

W. on . . . . .  
+ E. 80.000  
37.775

W. on . . . . .  
+ E. 42.225

W. on . . . . .  
+ E. 6 1/2 rods E.

X Stone for N 1/4 S.  
N 1/4 E 7 N 33 1/2 E. 42 Rods 1/3 1/4 E  
Orig S. E. B.T. same of heavy plain  
Orig NW Ranch blown over

46. / 4.3300  
396  
370  
338  
400  
396

00 21  
38.  
10 8  
63  
00 798

10.25  
6.576

80. / 16.81  
168  
87  
80  
16  
8820

420  
840  
8820

10.25  
8.82

Center 1/4 S 1.43 1/2 E

10.25  
7.98  
2.27

1954 Lewis notes for 27-35-10E

7760

East from W 1/4 P. Var 3 1/2 E  
file 430 N of 1/4 P

8000

South from N 1/4 P. Var 30 E  
file 42 west of S 1/4 P

1954