

SEC. 7 T. 39 N. R. 2 E. V.

① N<sup>1</sup>/<sub>4</sub> NE<sup>1</sup>/<sub>4</sub>

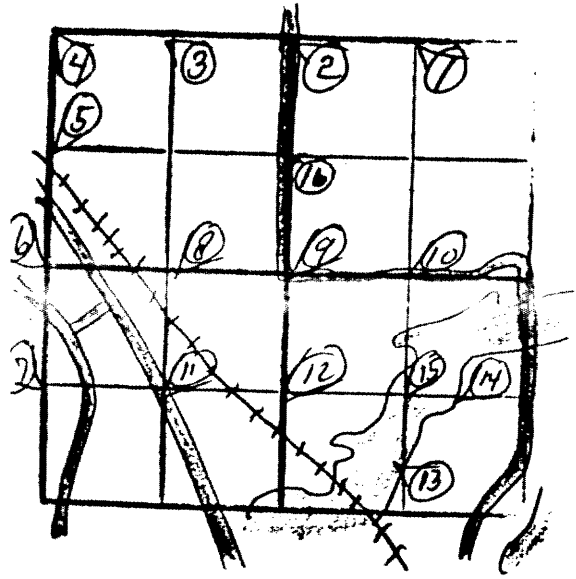

② N<sup>1</sup>/<sub>4</sub> Sec 7 O.B.T. Pind (alt.) 8" - S29°E - 27 (Don 12/9/07)  
 NEW BTA PN 14" N30°W 76.0 FT; ~~75 8"~~  
~~S 46°E 42.8 FT.~~ (S.O.H. 9-19-75)  
 OR 24" <sup>(6")</sup> N45°E 68.1 FT. (FACE IS SHUT)

See corner file

L 9574

③ N<sup>1</sup>/<sub>4</sub> NW<sup>1</sup>/<sub>4</sub>

RECEIVED & FILED	L 9574
Oneida County Surveyor's Office	
Date	APR 22 1988
By	
OCS Area #	

② NW Cor. Sec 7

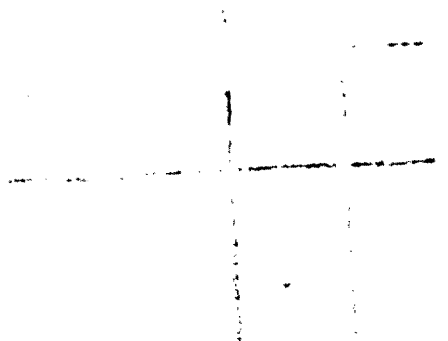

⑤ W<sup>1</sup>/<sub>4</sub> NW<sup>1</sup>/<sub>4</sub>

⑥ W<sup>1</sup>/<sub>4</sub> Sec 7 Found both O.B.T. New B.T. PN (off.) 12" S 16° E - 0.415 ch.; PN (off.) 14" N 7° W - 0.585 ch. (Dorr 12/9/07) Corner pres. by Howalke & Cameron. B.T. present are P-J 14" S 79° E - 0.583 ch.; P-J 16" S 54° E - 0.750 ch. New B.T. Oak 8" S 2° W - 0.423 ch. (Dg 9/70)  
See corner file

⑦ W<sup>1</sup>/<sub>4</sub> SW<sup>1</sup>/<sub>4</sub> an iron pipe by Bill Cameron (Dg 9/70)  
found 2" ip. + B.T. P-J 6" N 22° W 20.85', B-W 12" S 12° E 17.20'  
Seymour 3-9-82

Sec 7-39-7

⑧ N<sup>1</sup>/<sub>4</sub> SW<sup>1</sup>/<sub>4</sub> at 17.653 end of W<sup>1</sup>/<sub>4</sub> end 19.824 west of Ctr. Sec 7. 2 1/2" IP.  
Painted red. PJ 6" - N59°E - 0.421 ch.; PJ 6" - S53°E - 0.744 ch. (Jlg 9/70)

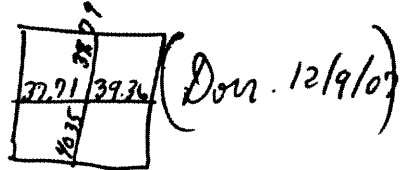
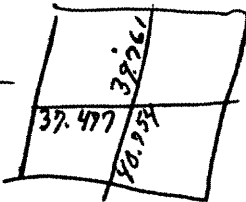
⑨ Ctr. Sec 7  (Don. 12/9/07) -  2 1/4" IP. PN 10" - N61°W - 0.398 ch.; PN 14" - S76°W - 1.211 ch. (Jlg 9/70)

⑩ N<sup>1</sup>/<sub>4</sub> SE<sup>1</sup>/<sub>4</sub> PN 12" - N72°W - 0.555 ch.; PN (off.) 11" - N59°E - 0.370 ch. (Don 12/9/07)

RECEIVED & FILED  
Orovida County Surveyor's Office  
APR 22 1988  
8881 22 AM  
By: [Signature]  
Date: [Signature]  
OCS Area #:

SW<sup>1</sup>/<sub>4</sub> 1" IP. Painted red. OR 10" - S62°E - 0.433 ch.; PW 11" - 53°W - 0.613 ch. (Jlg 9/70)

⑫ W<sup>1</sup>/<sub>4</sub> SE<sup>1</sup>/<sub>4</sub>

19.895	20.3
	20.397

a 1<sup>1</sup>/<sub>4</sub>" I.P. B.T. ground PW 12" - N38°W -  
0.275 ch.; New B.T. PN 10" - S55°W - 0.518 ch. (Jg 9/30)

⑬ Meander Cr. - East <sup>1</sup>/<sub>8</sub> line - south of water. at 2.25 north of <sup>1</sup>/<sub>8</sub> Cr.  
set M.C. Rem. 12" - S59°E - 0.145 ch. (Dorr 12/09/07)

⑭ Meander Cr. - S <sup>1</sup>/<sub>8</sub> line - East of water at 7.00 west of <sup>1</sup>/<sub>8</sub> Cr. set M.C.  
Rem. 12" - S27°E - 0.263 ch. (Dorr 12/09/07)

⑮ Cr. SE<sup>1</sup>/<sub>4</sub> set long pole in a hole cut through ice. (Dorr 12/09/07)