

SEC. 19 T. 38 N. R. 7 W.

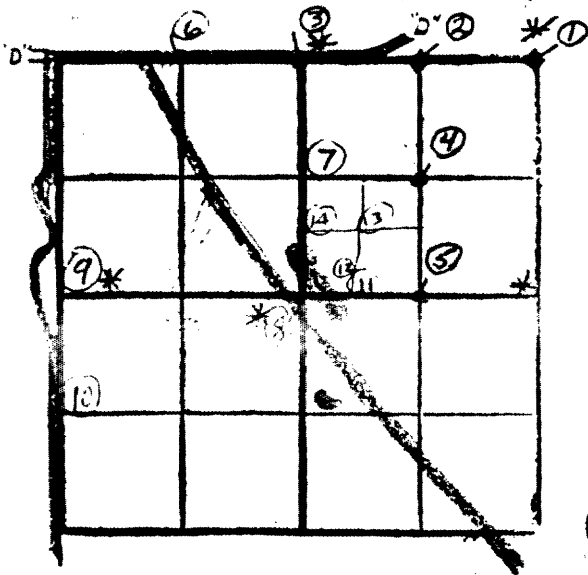

RECEIVED & FILED # 1810
 Onondaga County Surveyor's Office
 Date April 22, 1988
 By J. H.
 DCS Area # B.T.'s - Bw 8" N18W 34;

① NE Corner - I.P. Area # B.T.'s - Bw 8" N18W 34;
 Pn stb. 20" N27E 64. (M. Burgy Nat. Cont. Corp.)
 Found 1 1/2" i.p., Bw is fallen over, Pine stp N32°E 41-90',
 New BT^s PN 4" N 8°E 13.72', PN 4" S75°E 27.60', PW 4" S16°E 37.45'
 (12/81 Seymour, Vissers)

② E 1/16 on N line 20.03 ch. E of NE corner.
 I.P. B.T.'s - A 8" N31E 8; Pn stb. 18" N13W 25.
 (M. Burgy Nat. Cont. Corp.) Burgy's cor was
 set in error. Reset with a 1 1/4" i.p. (pulled Burgy pipe out) New BT^s
 Pine stp S27°W 6.84', PW 3" S24°E 6.12', PW 3" S81°W 12.00 to ctr
 (12/81 Seymour + Vissers)

③ N 1/4 W.P. + I.P. 25' N of corner
 Used this pipe to set DNR 2" brass cap (25' S in solar bearing) monument is approx 50' north of E
 BT^s made BW 11" N52°W 15.50', PW 20" N30°E 54.28', PW 16" N69°E 42.38' (12/81 Seymour, Vissers)

④ Corner of NE 1/4 3/4" I.P. B.T.'s - A 5" S 80E 2; A 6" S40W 7. (Berndt, 1956)
 Berndt i.p. is set in error. Reset using 1 1/4" i.p. BT^s Asp 10" S14°W 17.35' (to ctr),
 PW 3" S1°W 36.37', PW 3" N78°E 11.57' (Seymour, Vissers 12/81)

⑤ CE 1/16 At 20.03 ch West of E 1/4, set 3/4" I.P. B.T.'s OR 12" N38E 65.54
 Pw N34W .57 ch. (Berndt, 1956) Berndt i.p. was set in error. Reset using 1 1/4" i.p.
 BT^s OR 12" S63°W 17.23', MH 12" N15°W 7.78', OR 16" N46°E 42.83' (twin), PW 5" N36°W 34.86' (dead)
 (12/81 Seymour, Vissers)

1810

(6) N¹/₄ NW¹/₄ - Found 4" sq wood post marked $\frac{1}{8}$ 25' south

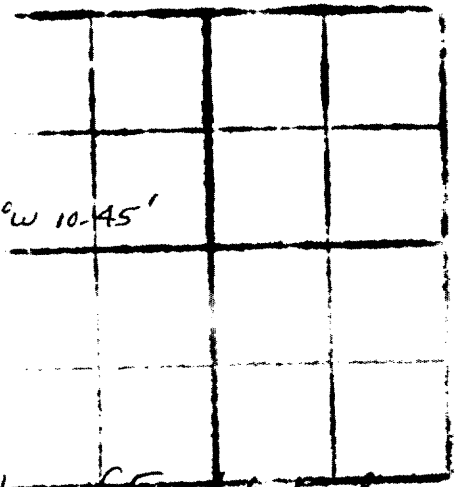

(7) CN¹/₁₆ set 1¹/₄" i.p. 100' \pm east of field edge BT^s BW 4" N 45° W 10.45'
BW 12" S 29° W 45.85' (12/81 Seymour, Vißers)

(8) C¹/₄ 19 set 2" i.p. DNR brass cap on westerly edge blacktop of Fawn Lake Road.
BT^s PW 10" N 8° E 64.11', PW 8" N 72° E 53.53', OR 10" S 13° E 57.40'
(12/81 Seymour, Vißers)

(9) W¹/₄ 19 found Oneida Co. capped 2" Alum. pipe. BT^s Asp 16" N 49° E 10.45', PN 7"
S 28° W 14.60', monument approx 20' east of corner (12/81 Seymour, Vißers)

(10) S¹/₄ set 1¹/₄" i.p. 100' east of field edge BT^s BW 4" N 45° W 10.45'
BW 12" S 29° W 45.85' (12/81 Seymour, Vißers)

(11) W.C. on E/W¹/₄ line east of pond, set 1¹/₄" i.p. BT^s PW 12" S 72° E 24.53', PW 14" N 50° E
13.50', (12/81 Seymour, Vißers)

(12) W.C. north of pond on $\frac{1}{64}$ line, set 1¹/₄" i.p. BT^s BW 7" S 18° E 8.63', BW 7" N 86° E 24.97'
(12/81 Seymour, Vißers)

(13) SW-NE $\frac{1}{64}$ set 1¹/₄" i.p. BT^s BW 24" S 6° E 40.50', PW 4" S 88° E 8.55' (12/81 Seymour, Vißers)

(14) C-S-N $\frac{1}{64}$ set 1¹/₄" i.p. BT^s MR 4" (twin) N 60° W 38.46', CH 6" N 74° E 29.36' (12/81 Seymour, Vißers)

SEC. 19 T. 38 N. R. 7 W.

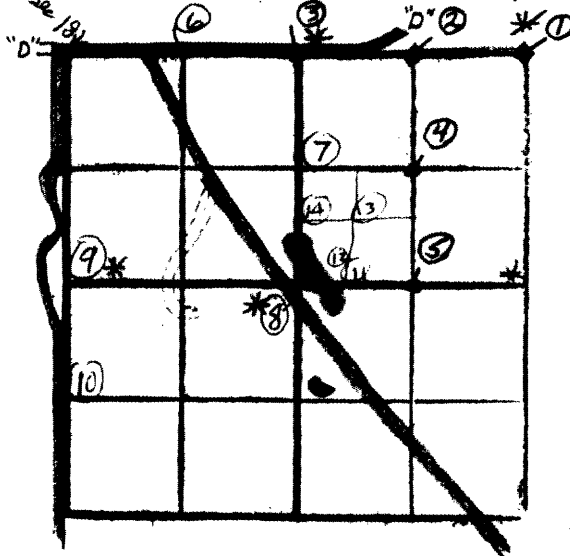

① NE corner - I.P. B.T.'s - 8w 8" N18W 34';
 Pn stb. 20" N27E 64. (M. Burgy Nat. Cont. Corp.)
 Found 1 1/2" i.p., BW is fallen over, Pine stp N32°E 41-90',
 New BT's PN 4" N 8°E 18-72', PN 4" S 75°E 27-60', PW 4" S 11°W 38.45'
 (12/81 Seymour, Vissers)

② E 1/16 on N line 20.03 ch. E of NE corner.
 I.P. B.T.'s - A 8" N31E 8; Pn stb. 18" N13W 25.
 (M. Burgy Nat. Cont. Corp.) Burgy's cor was
 set in error. Reset with a 1 1/4" i.p. (pulled Burgy pipe out) New BT's
 Pine stp S 27°W 6.84', PW 3" S 24°E 6-12', PW 3" S 81°W 12.00 to ctr
 (12/81 Seymour + Vissers)

③ N 1/4 W.P. + I.P. 25' N of corner
 Used this pipe to set DNR 2" brass cap (25's br i.p. solar bearing) monument is approx 50' north E
 BT's made BW 11" N 52°W 15.50', PW 20" N 30°E 54.28', PW 16" N 69°E 42.38' (12/81 Seymour, Vissers)
 (this may or may not be right)

④ Center of NE 1/4 3/4" I.P. B.T.'s - A 5" S 80°E 2; A 6" S 40°W 7. (Berndt, 1956)
 Berndt i.p. is set in error. Reset using 1 1/4" i.p. BT's Asp 10" S 14°W 17.35' (to ctr),
 PW 3" S 1°W 36.37', PW 3" N 78°E 11.57' (Seymour, Vissers 12/81)

⑤ CE 1/16 At 20.03 ch West of E 1/4, set 3/4" I.P. B.T.'s 0-12" N 38°E .65 ch
 Pw N 34°W .57 ch. (Berndt, 1956) Berndt i.p. was set in error. Reset using 1 1/4" i.p.
 BT's OR 12" S 63°W 17.23', MH 12" N 15°W 7.78', OR 16" N 46°E 42.83' (twin), Pw 5" N 36°W 34.86' (dead)
 (12/81 Seymour, Vissers)

(12/81 Seymour, Vissers) BT's OR 12" S 63°W 17.23', MH 12" N 15°W 7.78', OR 16" N 46°E 42.83' (twin), Pw 5" N 36°W 34.86' (dead) (12/81 Seymour, Vissers)

⑥ N¹/₄ NW¹/₄ - Found 4" sq wood post marked $\frac{1}{8}$ 25' south
(prob. is wrong)

3 N E S W 036

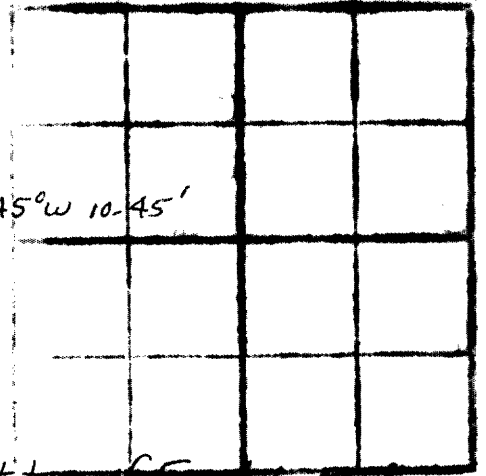

⑦ CN¹/₁₆ set 1¹/₄" i.p. 100' ± east of field edge BT^S BW 4" N 45° W 10.45'
BW 12" S 29° W 45.85' (12/81 Seymour, Vißers)

⑧ C¹/₄ 19 set 2" i.p. DNR brass cap on westerly edge black top of Fawn Lake Road.
BT^S PW 10" N 8° E 64.11', PW 8" N 72° E 53.53', OR 10" S 13° E 57.40'
(12/81 Seymour, Vißers)

⑨ W¹/₄ 19 Found Oneida Co. capped 2" Alum. pipe. BT^S Asp 10" N 49° E 10.95', PN 7"
S 28° W 14.60', mon. is approx 250' east of Lakewood Rd, (12/81 Seymour, Vißers)

⑩ S¹/₁₆ set 1¹/₄" i.p., $\frac{1}{2}$ ' west of E Lakewood Rd., BT^S BW 10" N 68° E 49.67', BW 11"
S 42° E 56.25' (12/81 Seymour, Vißers)

⑪ W.C. on E/W¹/₄ line east of pond, set 1¹/₄" i.p. BT^S PW 12" S 72° E 24.53', PW 14" N 50° E
13.50', (12/81 Seymour, Vißers)

⑫ W.C. north of pond on $\frac{1}{64}$ line, set 1¹/₄" i.p. BT^S BW 7" S 18° E 8.63', BW 7" N 86° E 24.97'
(12/81 Seymour, Vißers)

⑬ SW-NE $\frac{1}{64}$ set 1¹/₄" i.p. BT^S BW 24" S 6° E 40.50', PW 4" S 88° E 8.55' (12/81 Seymour, Vißers)
(hook) on NE corner of 2nd (hook) on SW corner of 3rd OR 14" N 45° E 10.45' BT^S BW 12" S 29° W 45.85' (12/81 Seymour, Vißers)

⑭ C-S-N $\frac{1}{64}$ set 1¹/₄" i.p. BT^S MR 4" (twix) N 60° W 38.46', CH 6" N 74° E 29.36' (12/81 Seymour, Vißers)