

1933

SURVEY FOR STANLEY CIESLEWICZ

IN THE NE 1/4 - NE 1/4 SECTION 36, T. 37 N., R. 8 E., ONEIDA COUNTY, WISCONSIN.

1933

SEC.	35
COR.	25
25	36

S. 87° 18' W. 590.0'

1370' TO SEC. COR.

2" I.P. CORNER

S. 0° 30' W. 125.0'

1" X 3/4" I.P.

SURVEYED FOR TRANSFER
TITLE FOR 9-11-79
AREA = 3.0 ACRES

S. 76° 58' E. 638.6'

638.6'

12.2'

INT. TO OLD WELL POINT

N. 6° 06' W. 298.5'

MILE CREEK FLOWAGE

POWER POLE

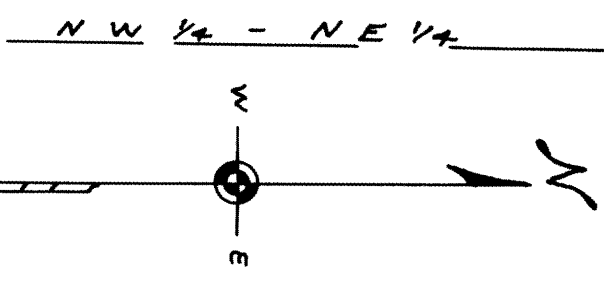

O.I.P. = IRON PIPE

DATED: 9-12-79

By: *Mr. Poelke*
WIS. # 5-140

RECEIVED & FILED # **1933**
 Oneida County Surveyor's Office
 Date: **JUL 0 1 1989**
 By: *MAP*
 OCS Area #

1933