

DEPARTMENTAL CORRESPONDENCE

To: Mr. S. A. Koszarski - Division No. 7

Attention: Mr. C. C. Miles

From: Mr. Frank Chare

Subject: Town Plats

Date: June 25, 1942

In checking over the county plates of Gwilda County, we find that we cannot find the original plate for the Town of Sebald. It was returned to the County Clerk's office and either it was not returned or it has been altered or corrected. We are attaching herewith a blueprint of the Town plate for reference. If you are able to find the original plate, please send your file copy. Any rough drawing will be sufficient for us to correct our plate.

We also note that in Title County the next tier of sections of the Arbor Vitae were transferred to the Town of St. Dennis. However a change in township boundaries is noted we should tie up with the Secretary of State's office, and have the original title transferred to the correct township. It is possible that the interest in that office resulted in this change. Would it be possible for you to send us a copy of the legal proceedings of the county board making this change?

PC:BA

State Highway Commission
RECEIVED
JUN 24 1942
RHINELANDER, WIS.

Mr. Gary
McLaren, Rls.
Town Place

C. C. Miles
Bristolender, Rls.
June 27, 1942

Complying with your request of June 25th, we have corrected the name printed on the copy of Republic which you sent to this office. It now agrees with the corrected plate of 25th. We are returning this plate herewith.

We have written to the County Clerk of Vilas County for a copy of the last proceedings of the Vilas County Board. For the better understanding of the Board's action in transferring the last lot of securities to the Town of the Town of St. Francois we may be able to forward this information to you within a day or two.

Aust. Division Engineer

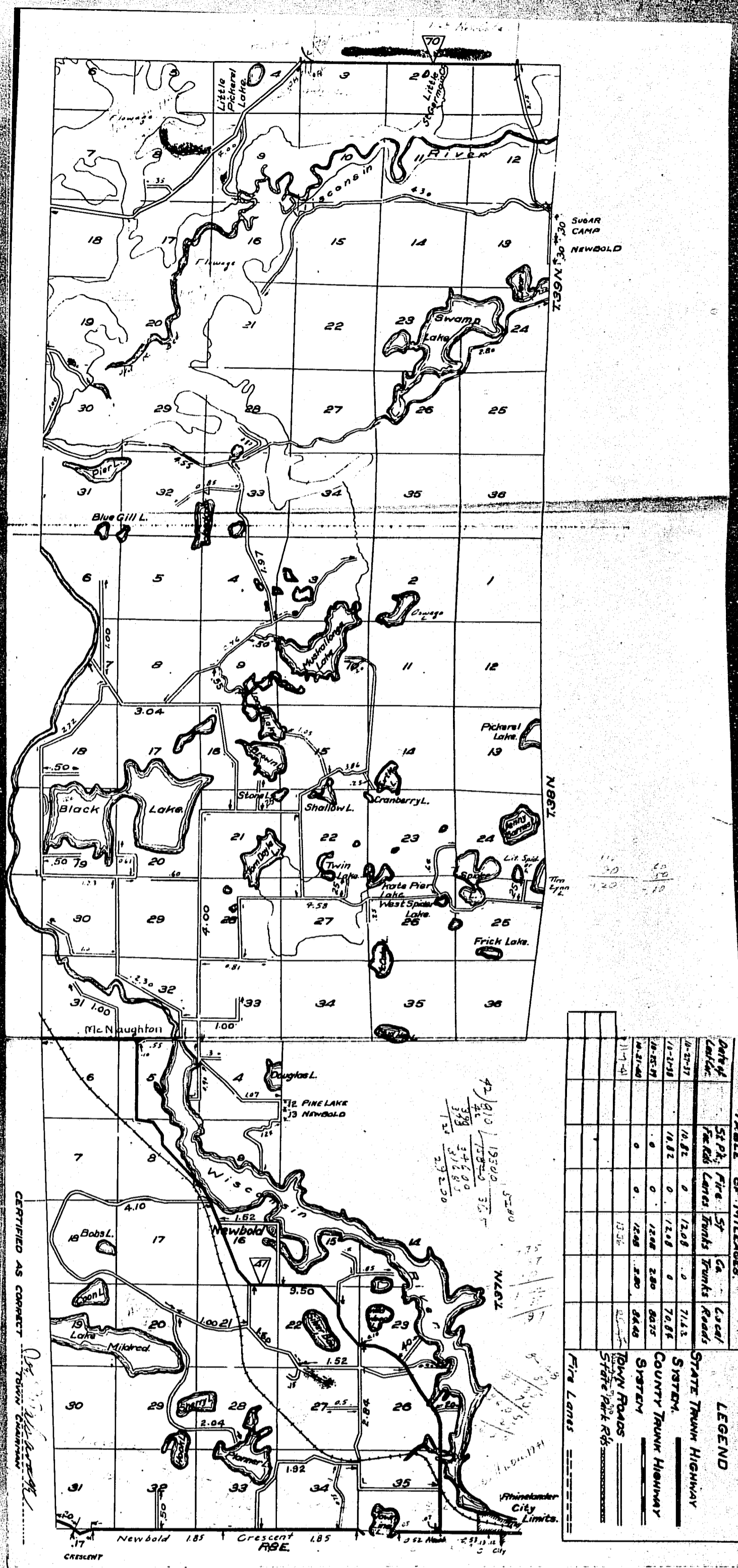

TABLE OF MILES.							LEGEND
Date of Location	S.P. Feet	Pipe Lanes	Feet Trunk	A. Trunk	Local Trunk	Local Roads	
4-22-27	14.82	0	12.68	0	71.82		
4-22-28	14.82	0	12.68	0	71.82		
4-23-27	0	0	12.68	2.80	69.12		
4-23-28	0	0	12.68	2.80	69.12		
11-7-28			12.35				
				</			

TOWN PLAT RECORD - WISCONSIN HIGHWAY COMMISSION.
TOWN OF NEWBOLD COUNTY OF ONEIDA.

CCM:K
B-6-Town of
Newbold