

STATE HIGHWAY COMM. OF WISCONSIN  
TOWN PLAT RECORD

Town	County					Sym-bols	
	MONICO	ONEIDA	ONEIDA	ONEIDA	ONEIDA		
Date of Last Corr.	Fed. For. Dev. Rds.	State Park Rds.	State Fire Lane	State Trunks	County Trunks	Local Roads	
12-15-54			3.84	16.26		19.09	Sch. 1
10-10-53			3.84	16.04	0.80	19.21	Cem. 1
9-21-50			3.84	16.30		19.23	Tower 1
10-29-51			3.84	16.30		19.23	Gate 1
12-3-52			3.84	16.26		19.23	
9-23-53			3.84	16.26		19.09	

Certified as Correct By Town Chairman: Marion J. White

S.T.H.  
-80 +.70  
-42 +.30  
-1.22 +1.00  
-1.22 +1.00

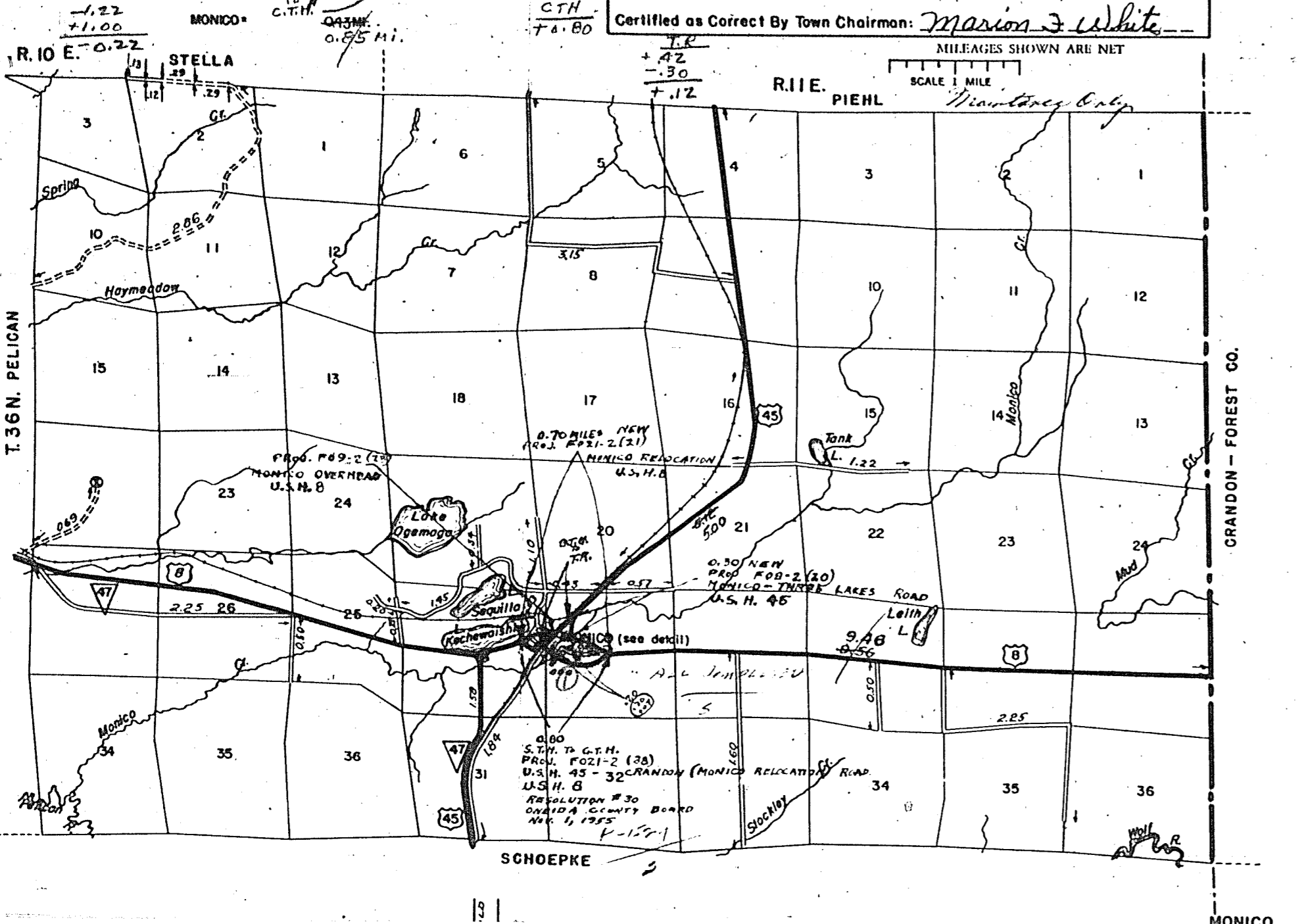

STATE HIGHWAY COMMISSION OF WISCONSIN  
TOWN PLAT RECORD

Town of NEWBOLD	County of ONEIDA					Sym-bols	
	MONICO	ONEIDA	ONEIDA	ONEIDA	ONEIDA		
Date of Last Corr.	Fed. For. Dev. Rds.	State Park Rds.	State Fire Lane	State Trunks	County Trunks	Local Roads	
10-19-51				11.10	14.56	85.59	
12-8-52				11.10	14.56	83.68	
9-25-53				11.10	16.98	86.15	
12-14-54				11.10	16.98	85.35	
9-25-53				11.10	16.98	85.35	
9-17-47				13.23	12.43	82.98	
11-24-49				11.10	14.56	81.68	
11-15-49				11.10	14.56	85.08	
10-31-50				11.10	14.56	85.08	

—LEGEND—  
State Trunk Highway Sys  
County Trunk Highway Sys  
Local Roads  
Fed. Forest Dev. Roads  
State Park Roads  
State Fire Lanes

Certified as Correct  
Earl Johnson  
Town Chairman

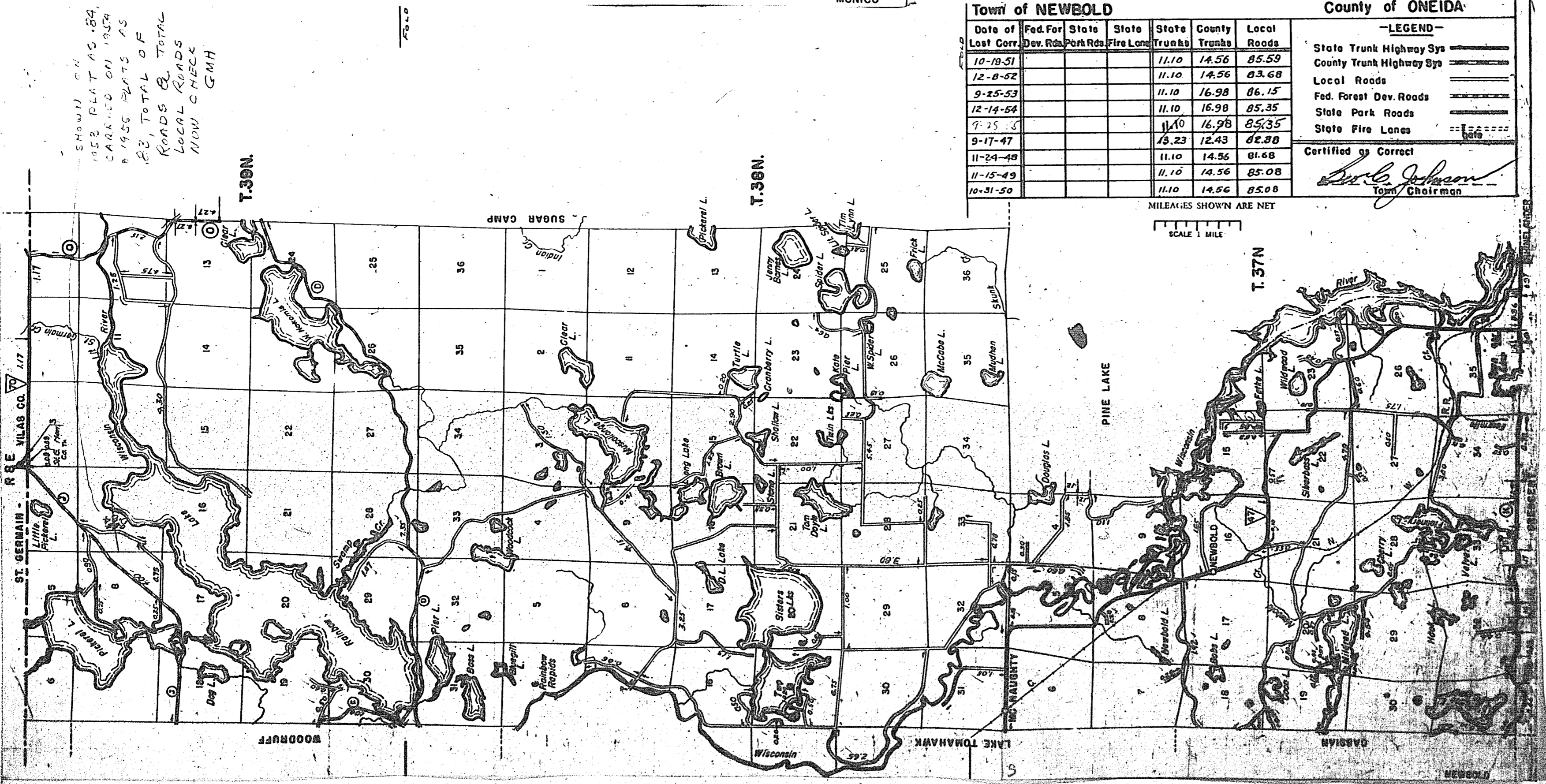

SHOWS ALL  
1952 PLAT AS 64  
CARRIED ON 1954  
1950 PLAT AS  
83, TOTAL OF  
ROADS & TOTAL  
LOCAL ROADS  
NOW CHECK  
GMH

all roads on plat are public roads and have been maintained by the town of Nokomis 11-20

STATE HIGHWAY COMM. OF WISCONSIN  
TOWN PLAT RECORD

Town	County					Sym-bols	
	NOKOMIS	ONEIDA	ONEIDA	ONEIDA	ONEIDA		
Date of Last Corr.	Fed. For. Dev. Rds.	State Park Rds.	State Fire Lane	State Trunks	County Trunks	Local Roads	
12-20-54				6.61	7.23	43.77	Sch. 1
10-23-53				6.61	7.23	43.68	Cem. 1
10-10-50				6.71	7.23	42.85	Tower 1
10-18-51				6.71	7.23	42.95	Gate 1
11-13-52				6.61	7.23	43.20	
9-24-53				6.61	7.23	43.75	

Certified as Correct By Town Chairman: George White

