

STATE HIGHWAY COMM. OF WISCONSIN  
TOWN PLAT RECORD

Town	MONICO	County	ONEIDA				
Date of Last Corr.	Fed. For. Dev. Rds.	State Park Rds.	State Fire Lane	State Trunks	County Trunks	Local Roads	Sym-bols
12-15-54			3.84	16.26		13.09	Sch. 1
10-20-55			3.84	16.04	0.00	19.21	Cem. ②
10-2-56			3.84	16.04	0.00	19.21	Tower ①
10-29-51			3.84	16.30		18.23	Gate ③
12-3-52			3.84	16.26		19.23	
9-23-59			3.84	16.26		19.09	

Certified as Correct By Town Chairman: *Marion White*

MILEAGES SHOWN ARE NET  
SCALE 1 MILE

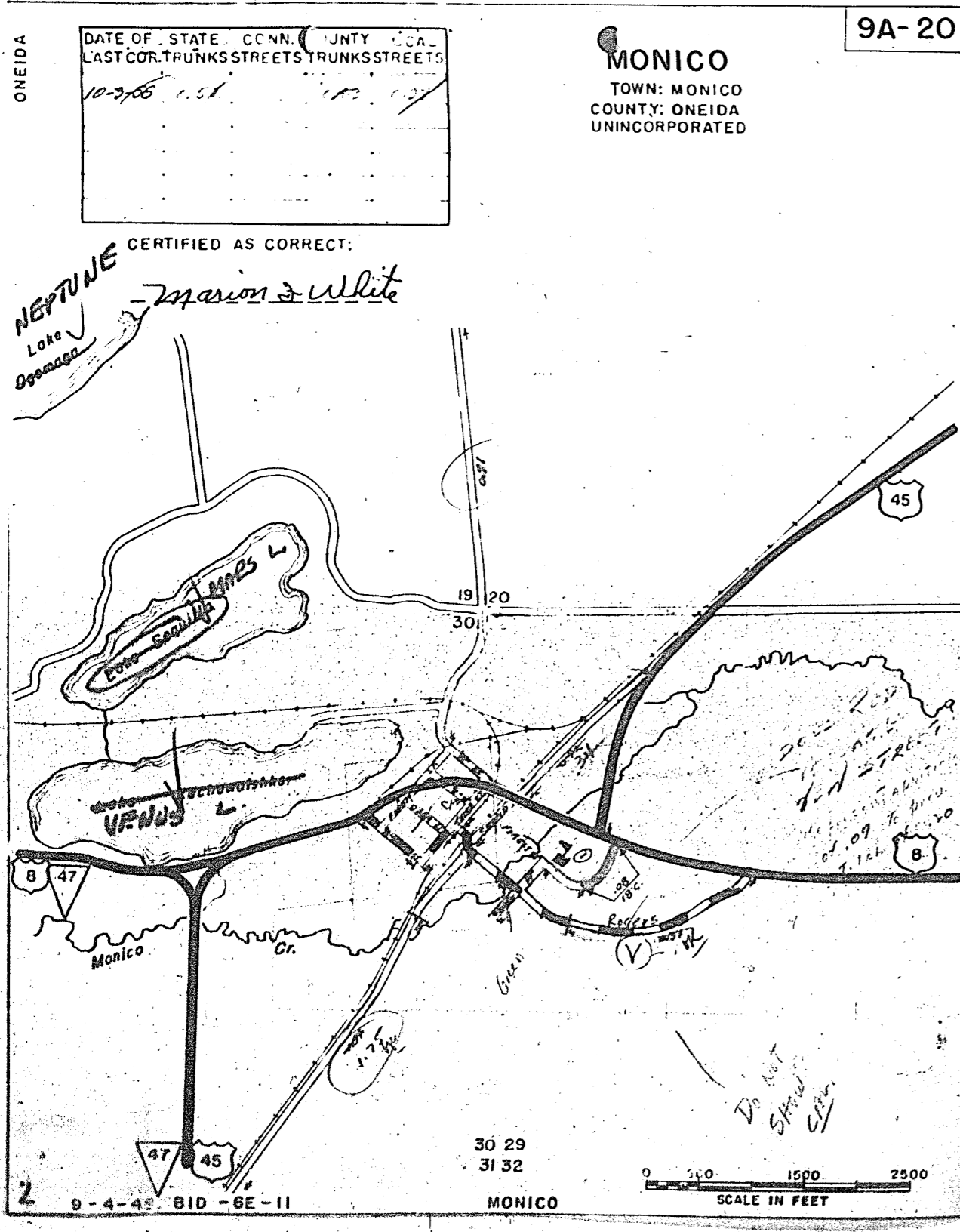
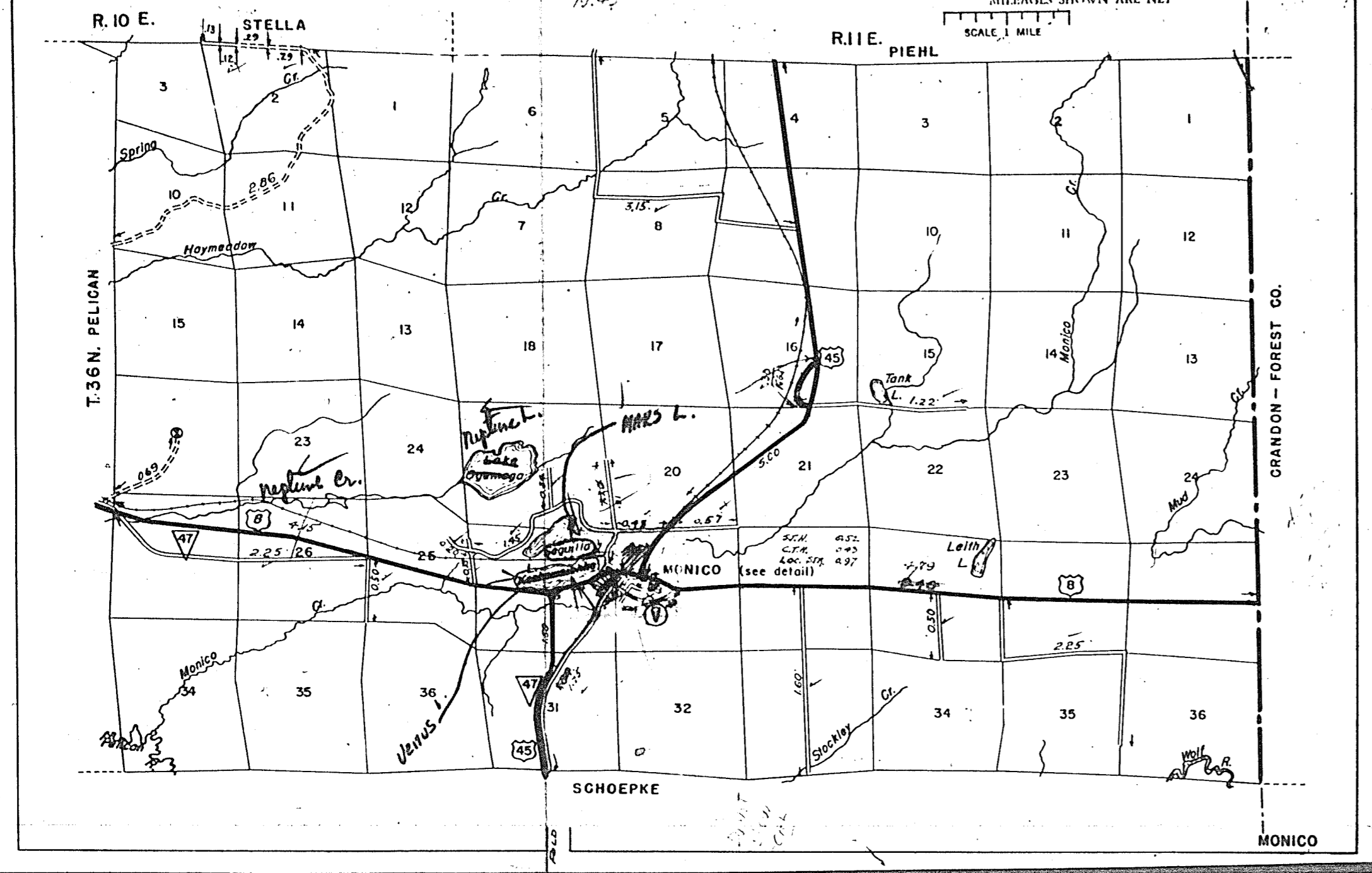

Village of Monico County Oneida

Name of Street	Gross Length	Inter. Quitted	Foot Deduct.	Net Length	State Trunk	Conn. Street	County Trunk	Local Street
Green St.	677	1	60	617			1110	617
Rogers St.	1110			1110			152	733
Second St.	885			733			512	568
Third St.	1080			1080			450	
4th St.	450			450				450
Dorr St.	450	1	110	310				310
5th St.	450			450				450
6th St.	450			450				450
Fourth St.	1000	2	270	810				810
Forest St.	756			756				756
Forest St. Ext.	403			403				403
U.S.H. 8	2716			2716	2716			
TOTAL FEET	2716'			2716'	2254'		5,097'	
TOTAL MILES	0.52'			0.52'	0.43'		0.97'	

CERTIFIED AS CORRECT

Village Clerk

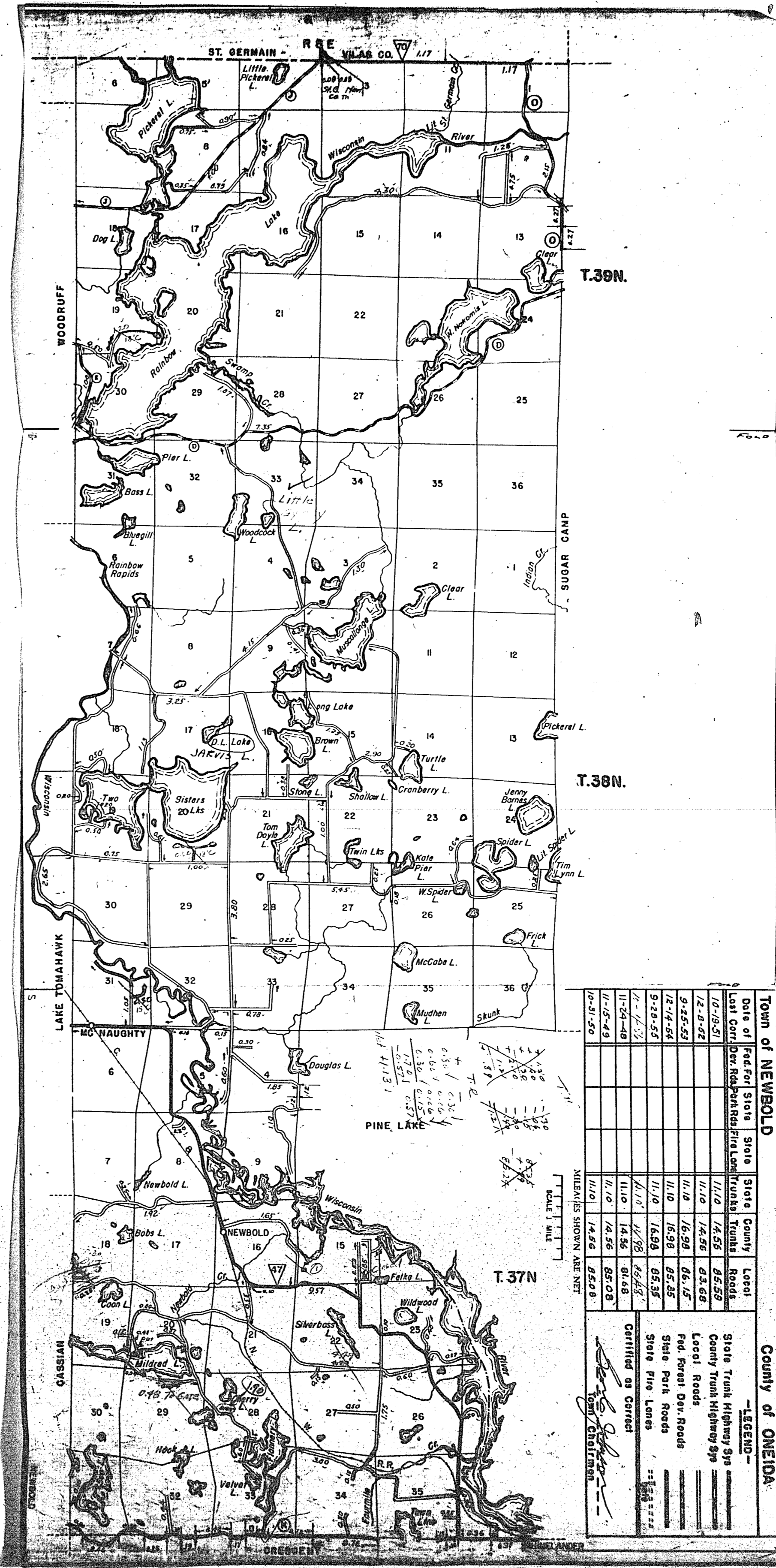

Town of NEWBOLD

Date of Last Corr.	Fed. For. Dev. Rds.	State Park Rds.	State Fire Lane	State Trunks	County Trunks	Local Roads
10-19-51			11.0	14.55		85.59
12-8-52			11.0	14.55		85.59
9-25-53			11.0	16.99		85.55
12-12-54			11.0	16.99		85.55
9-28-55			11.0	16.99		85.55
11-17-56			11.0	14.55		85.55
11-24-58			11.0	14.55		85.55
10-31-59			11.0	14.55		85.55

STATE HIGHWAY COMMISSION OF WISCONSIN  
TOWN PLAT RECORD

County of ONEIDA