

STATE HIGHWAY COMM. OF WISCONSIN  
TOWN PLAT RECORD

Town	County PELICAN				County ONEIDA				Local Roads	Sym-bols
	Date of Last Corr.	Fed. For. Dev. Rds.	State Park Rds.	State Fire Lane	State Trunks	County Trunks	Local Roads			
	12-17-54			0.68	9.83	10.35	66.52	Sch. 1		
	12-6-55			0.68	9.83	10.35	66.52	Cem. 11		
	10-8-56			0.68	9.83	10.14	66.30	Tower 12		
	10-1-57			0.10	9.83	10.05	67.99	Gate 13		
	10-3-52			0.68	9.83	10.35	66.52			
	9-23-53			0.68	9.83	10.35	66.52			

Certified as Correct By Town Chairman: *Louis F. Feller*

*Q.A.U. SHALL ABANDON SUB-DIVISION PLOTS FOR AREAS IN SEC. 5, 7 & 11, S.D.S.*

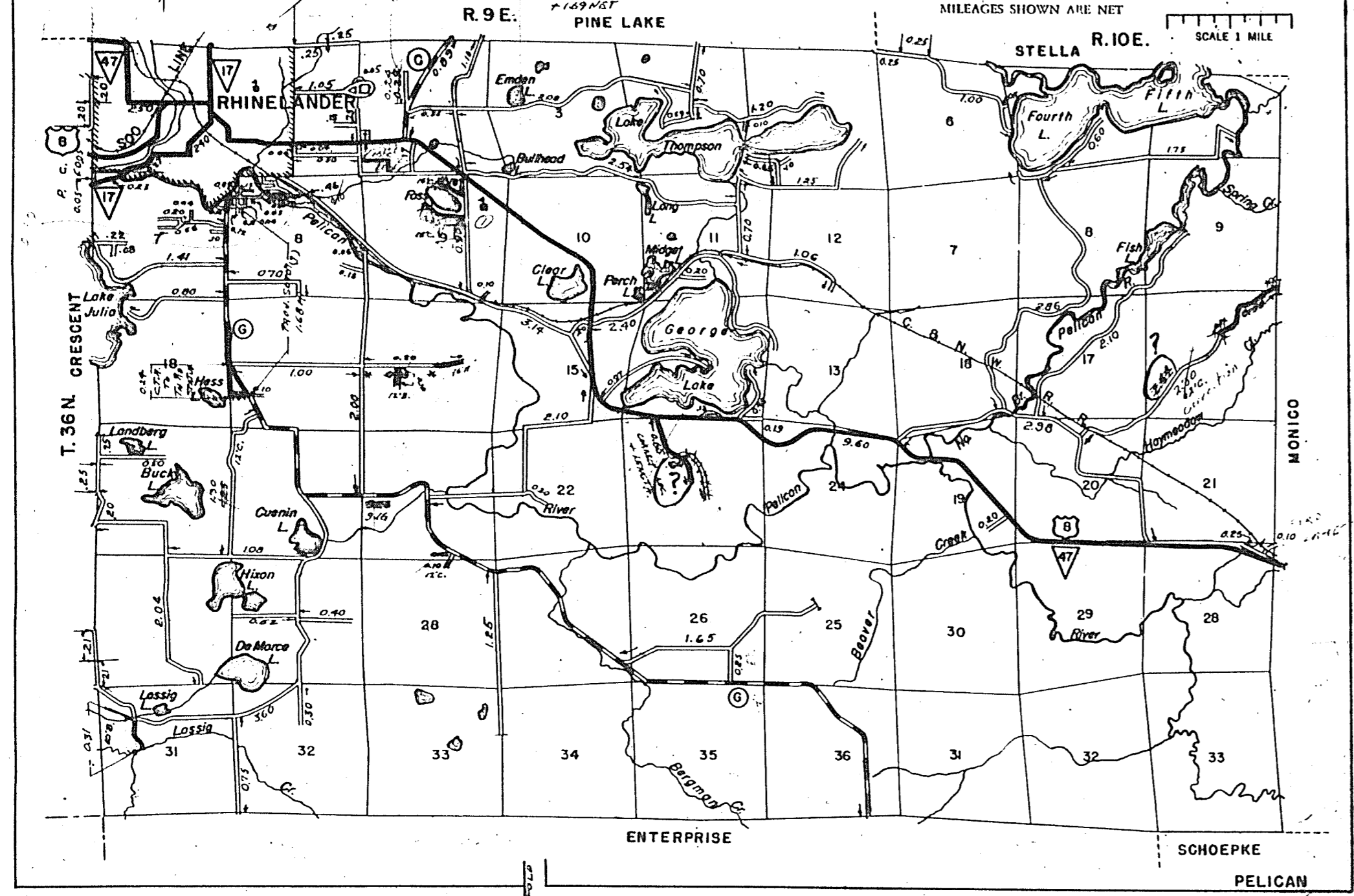

STATE HIGHWAY COMM. OF WISCONSIN  
TOWN PLAT RECORD

Town	County PIEHL				County ONEIDA				Local Roads	Sym-bols
	Date of Last Corr.	Fed. For. Dev. Rds.	State Park Rds.	State Fire Lane	State Trunks	County Trunks	Local Roads			
	12-15-54				6.55	2.05	13.01	Sch. 1		
	9-29-55				6.55	2.05	13.01	Cem. 11		
	9-8-56				6.55	2.05	13.01	Tower 12		
	8-28-57				6.55	2.05	13.01	Gate 13		
	10-3-52				6.55	2.05	13.01			
	9-23-53				6.55	2.05	13.01			

Certified as Correct By Town Chairman: *John H. Hopkins*

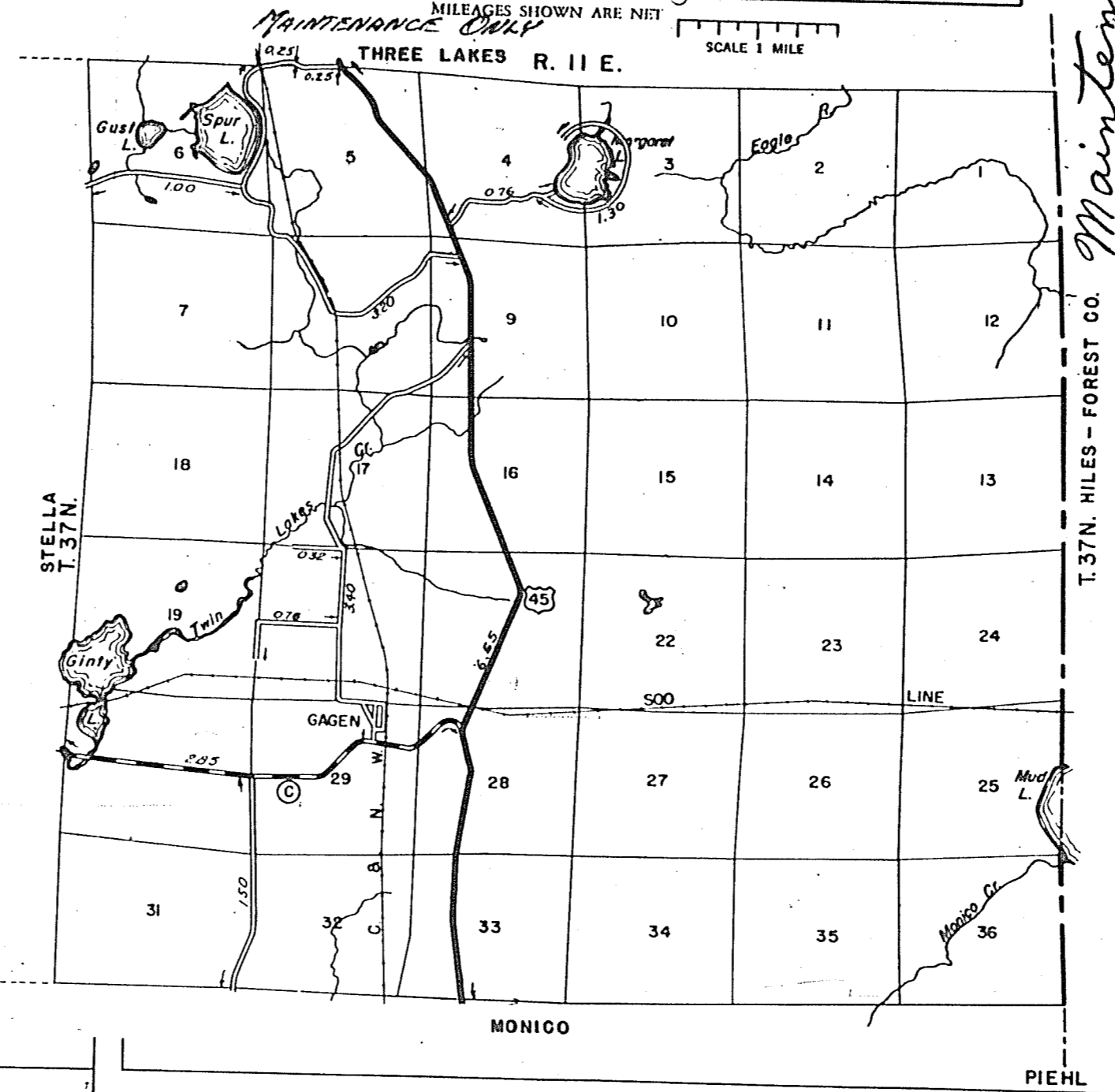
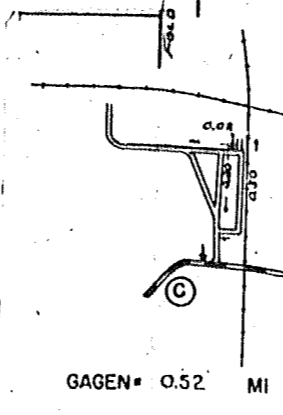

*Maintenance Only*

STATE HIGHWAY COMM. OF WISCONSIN  
TOWN PLAT RECORD

Town	County PINE LAKE				County ONEIDA				Local Roads	Sym-bols
	Date of Last Corr.	Fed. For. Dev. Rds.	State Park Rds.	State Fire Lane	State Trunks	County Trunks	Local Roads			
	12-15-54				6.51	6.32	54.45	Sch. 1		
	12-9-55				6.51	6.32	55.05	Cem. 11		
	11-30-56				6.51	6.44	56.13	Tower 12		
	9-3-57				6.51	6.44	56.13	Gate 13		
	12-5-52				6.33	4.25	55.35			
	9-23-54				6.51	4.25	55.71			

Certified as Correct By Town Chairman: *Tom B. Buntline*

