

STATE HIGHWAY COMM. OF WISCONSIN  
TOWN PLAT RECORD

Date of Last Corr.	Town - LAKE TOMAHAWK				County - ONEIDA (43-005)		
	State Fire Lane	State Trunks	County Trunks	Local Roads	Symbols	State Park Roads	
1-1-58	3.76	7.43	7.27	48.51	Sch. 1	1.00	
1-1-59	3.76	7.43	7.39	46.76	Cem. 1	1.00	
1-1-60	3.76	7.43	7.39	46.82	Tower 1	0.53	
1-1-61	3.74	7.29	7.27	48.97			

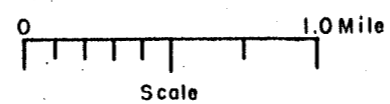

46.82-0.50-46.82  
Certified as Correct By Town Chairman: *H.E. Coffey*

Plan No. 72411

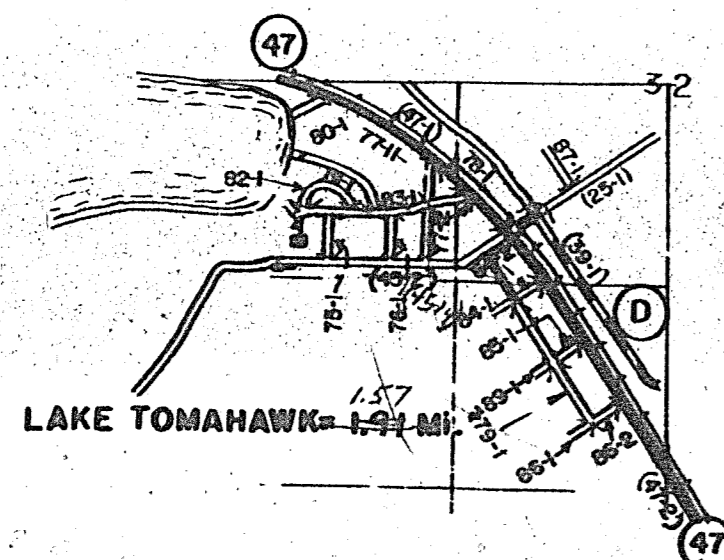
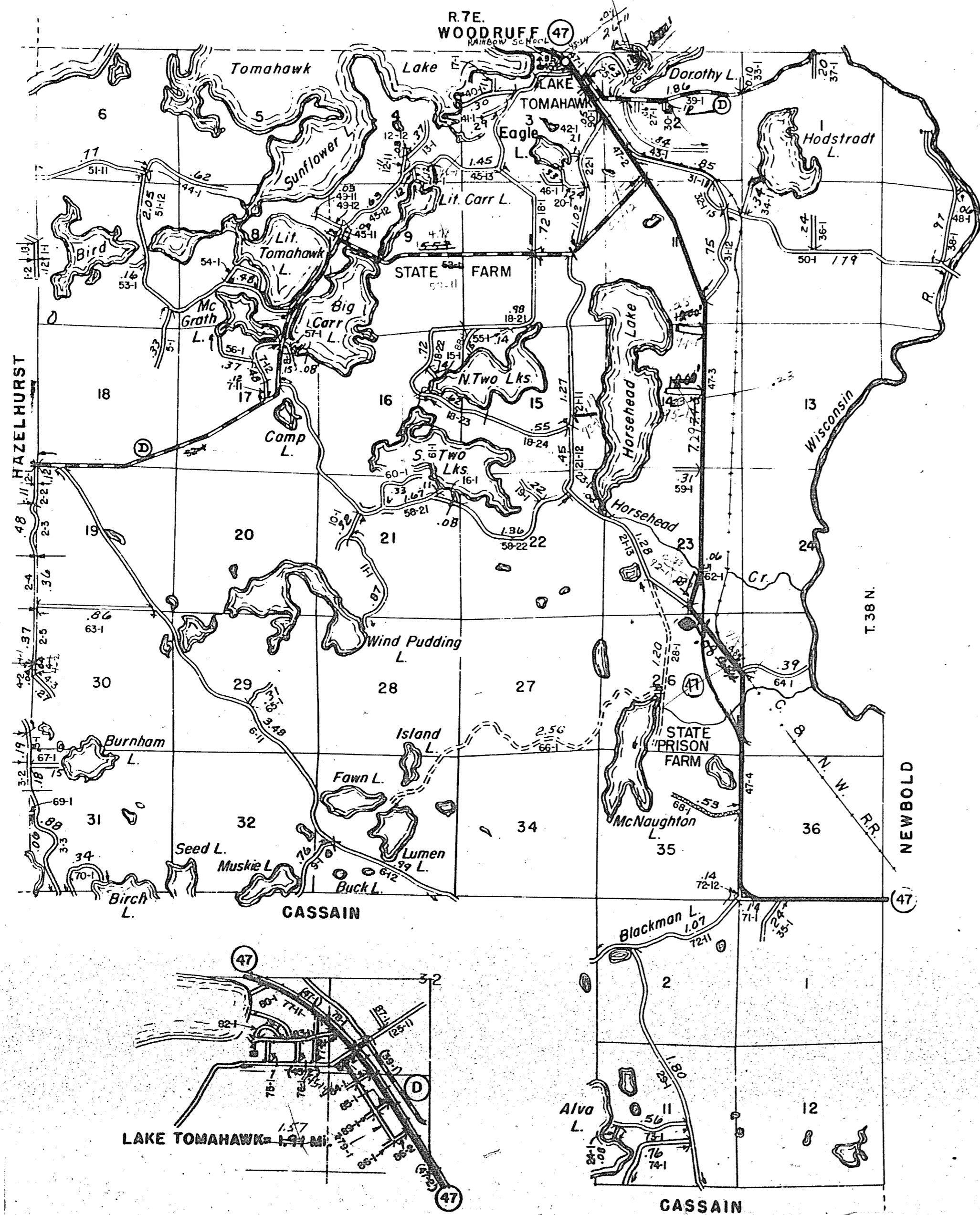

The last assigned road number is 90.71-12-76 LAKE TOMAHAWK

State Highway Commission of Wisconsin  
RURAL PLATED AREA - LOCAL ROAD STREET LIST  
County - Oneida (43-005)

Sheet 1 of 1  
Date 7-26-60  
Plat No. 5-20

Road No.	Street Name	Gross Length		Intersections		Net Length (Feet)
		Mils.	Feet	No.	Pl. Plat.	
75-1						
76-1		0.06				
77-11		0.06				
77-12		0.07				
78-1		0.07				
79-1		0.21				
80-1		0.39				
81-1		0.07				
82-1		0.09				
83-1		0.06				
84-1		0.27				
84-2		0.04				
85-1		0.03				
86-1		0.03				
86-2		0.02				
87-1		0.02				
89-1		0.05				
90-1		0.02				
Totals		1.57		11		

Certified as Correct: *H.E. Coffey* Pay Miles 1.46