

STATE HIGHWAY COMM. OF WISCONSIN
TOWN PLAT RECORD

Town - PINE LAKE		County - ONEIDA (43-014)		
Date of Last Corr.	State Trunks	County Trunks	Local Roads	Symbols
1-1-58	6.51	6.44	56.13	Sch. 4
1-1-59	6.51	6.48	53.68	Cem. II
1-1-60	6.50	6.48	53.44	
1-1-61	6.38	5.88	55.12	
1-1-62	6.33	5.68	53.08	

Gross Mileage: 66.14
 Deduction for Intersections: 0.44
 Net Pay Mileage: 65.70

Gross Mileage: 257.08
 Deduction for Intersections: 21.40
 Net Pay Mileage: 235.68

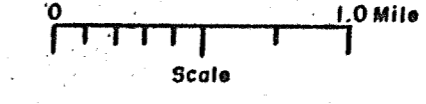

Certified as Correct By Town Chairman: *David J. Steadley*

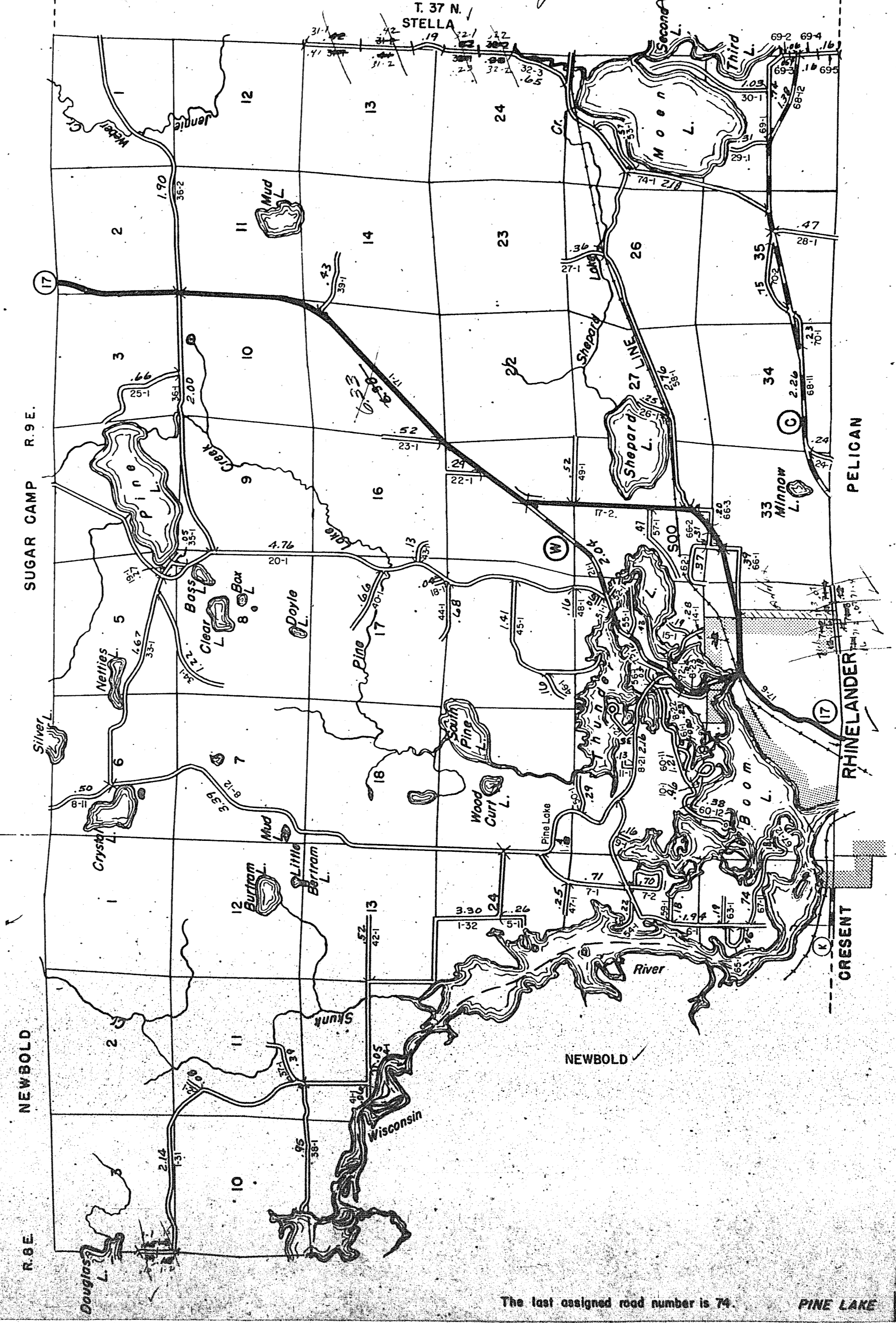

The last assigned road number is 74. PINE LAKE

STATE HIGHWAY COMM. OF WISCONSIN
TOWN PLAT RECORD

Town - PIEHL		County - ONEIDA (43-013)		
Date of Last Corr.	State Trunks	County Trunks	Local Roads	Symbols
1-1-58	6.55	2.85	13.01	Sch. 4
1-1-59	6.55	2.79	11.54	Cem. II
1-1-60	6.55	2.79	11.55	
1-1-61	6.55	2.79	11.55	
1-1-62	6.55	2.79	11.55	

Gross Mileage: 11.55
 Deduction for Intersections: 0.08
 Net Pay Mileage: 11.47

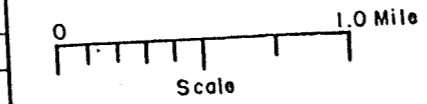

Certified as Correct By Town Chairman: *John Harkins*

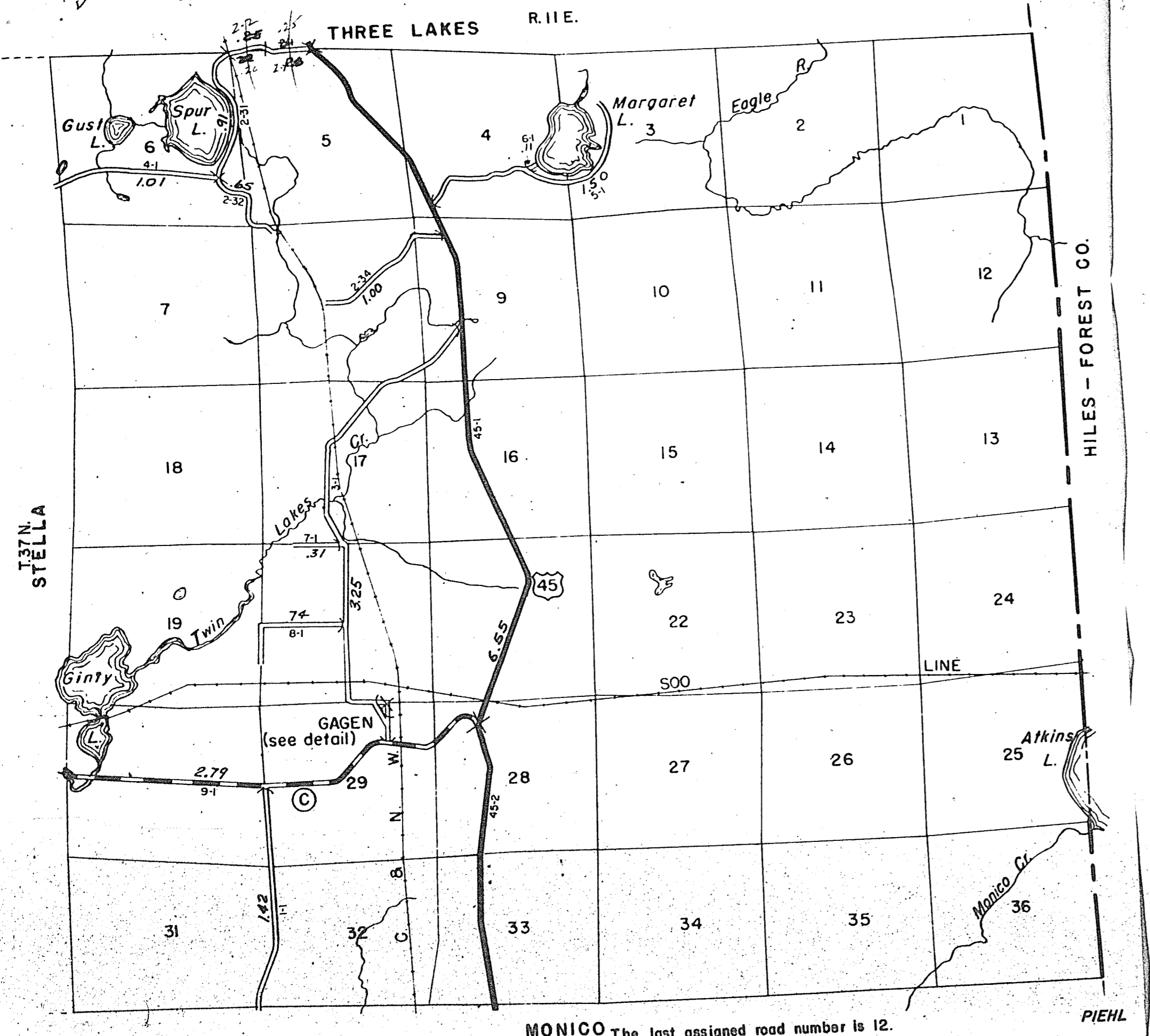

MONICO The last assigned road number is 12.