

STATE HIGHWAY COMM. OF WISCONSIN
TOWN PLAT RECORD

RETURN THIS PLAT

5-20

Town-LAKE TOMAHAWK				County ONEIDA (43-005A)			
Date of Last Corr.	State Fire Lane	State Trunks	County Local Roads	Symbols	State Park Roads		
1-1-64	—	7.47	7.47	Sch. 4	1.00		
1-1-59	3.76	7.43	7.39	Cem. 11	1.00		
1-1-60	3.76	7.43	7.39				
1-1-61	3.76	7.29	7.39				
1-1-62	3.76	7.29	7.39				
1-1-63	—	7.47	7.41				

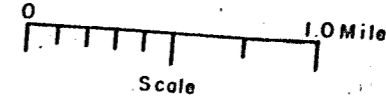

Gross Mileage 48.77
Deduction for Intersections 0.53
Net Pay Mileage 48.24

Certified as Correct By Town Chairman *Raymond F. Dean*

Town Hazelhurst
Community (43-004B)
County Oneida

Date 1963
Plat No. 4A-20

Road No.	Street Name	Gross Length		Intersections		Net Length (Feet)
		Miles	Feet	No.	El. Dist.	
25-2	Onaida	0.31				
25-3	Onaida	0.05				
25-41	Onaida	0.05				
25-12	Onaida	0.03				
34-1	Church Street	0.36				
35-1	Leigh Rd.	0.29				
36-1	Hinocqua Rd.	0.10				
37-11	Lakoview Street	0.35				
37-12	Lakoview Street	0.05				
38-1	Raid Street	0.06				
39-11	Curtis	0.06				
39-12	Curtis	0.04				
40-1	Yawkey	0.13				
40-2	Yawkey	0.16				
Totals		2.074				

Certified as Correct *Raymond F. Dean* Pay Miles

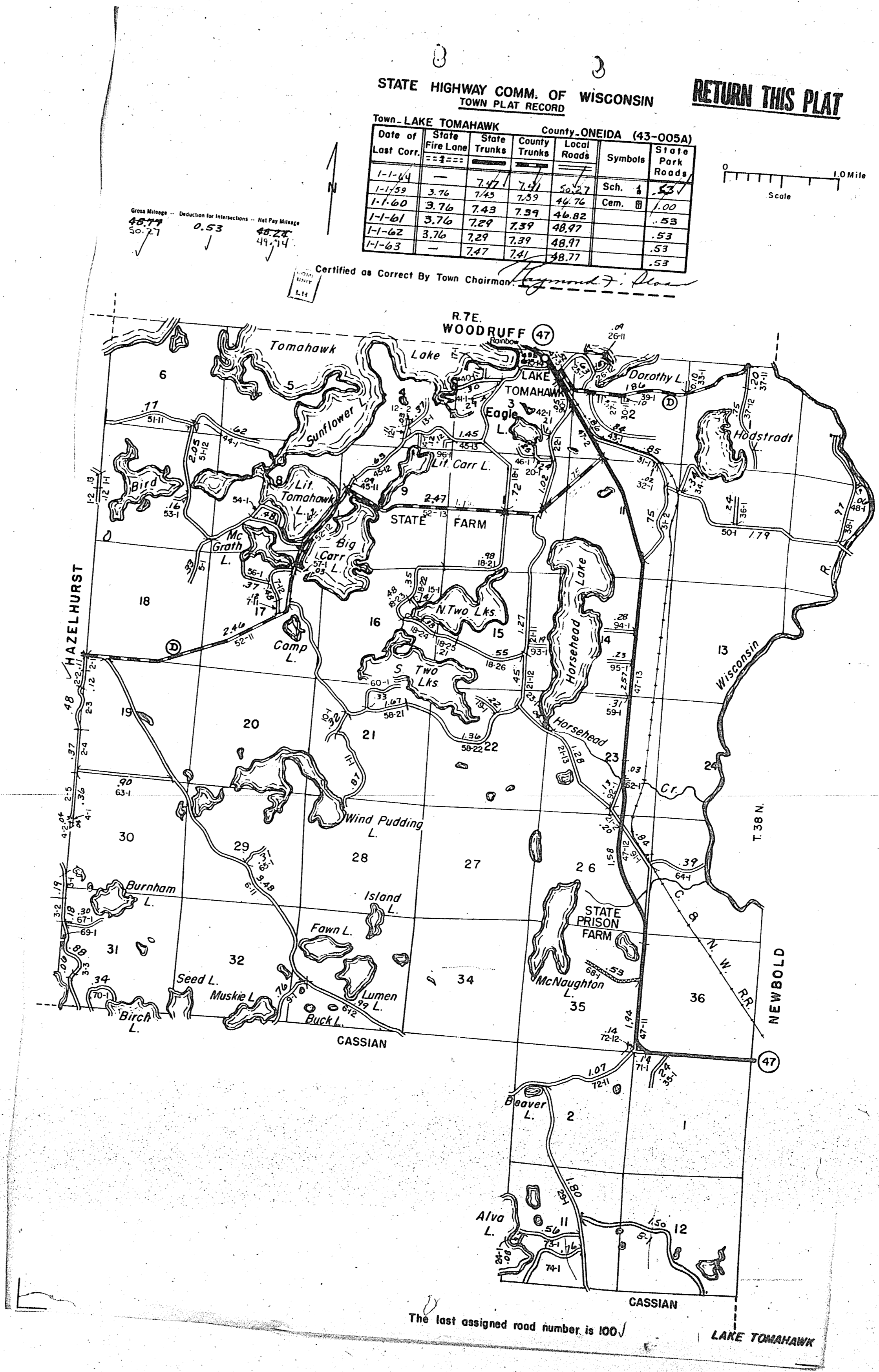

The last assigned road number is 100.

LAKE TOMAHAWK