

STATE HIGHWAY COMM. OF WISCONSIN

Town NEWBOLD County ONEIDA (43-010)

RETURN THIS PLAT

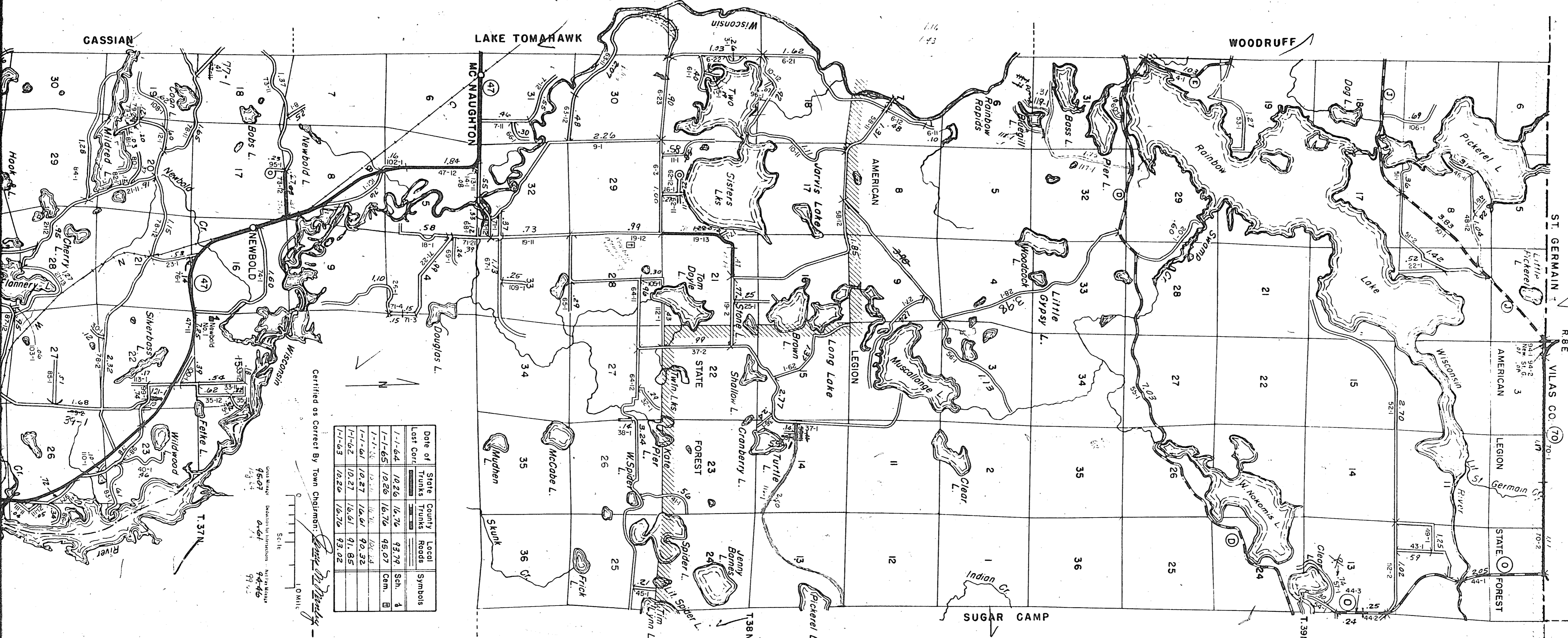

Date of Last Corr.	State Trunks	County Trunks	Local Roads	Local Symbols
1-1-64	10,226	16,776	73,779	Sch. A
1-1-65	10,226	16,776	95,077	Com. B
1-1-66	10,226	16,776	100,324	
1-1-67	10,227	16,861	90,332	
1-1-68	10,226	16,776	93,022	

Certified as Correct By Town Chairman: *[Signature]*

Scale: 1" = 10 Miles
9507 2-61 9446 99-2