

STATE HIGHWAY COMM. OF WISCONSIN
TOWN PLAT RECORD

RETURN THIS PLAT

Town - LAKE TOMAHAWK			County - ONEIDA (43-005A)			
Date of Last Corr.	State Fire Lane	State Trunks	County Trunks	Local Roads	Symbols	State Park Roads
1-1-64	=====	=====	=====	=====	Sch. 1	.53
1-1-65					Cem. B	.53
1-1-66						.53
1-1-67						.53
1-1-62						.53
1-1-63						.53

Gross Mileage .. Deduction for Intersections .. Net Pay Mileage
 51.24 .54 50.70
 51.77 .55 51.22

Certified as Correct By Town Chairman: *James D. Blaine* 9/17/66

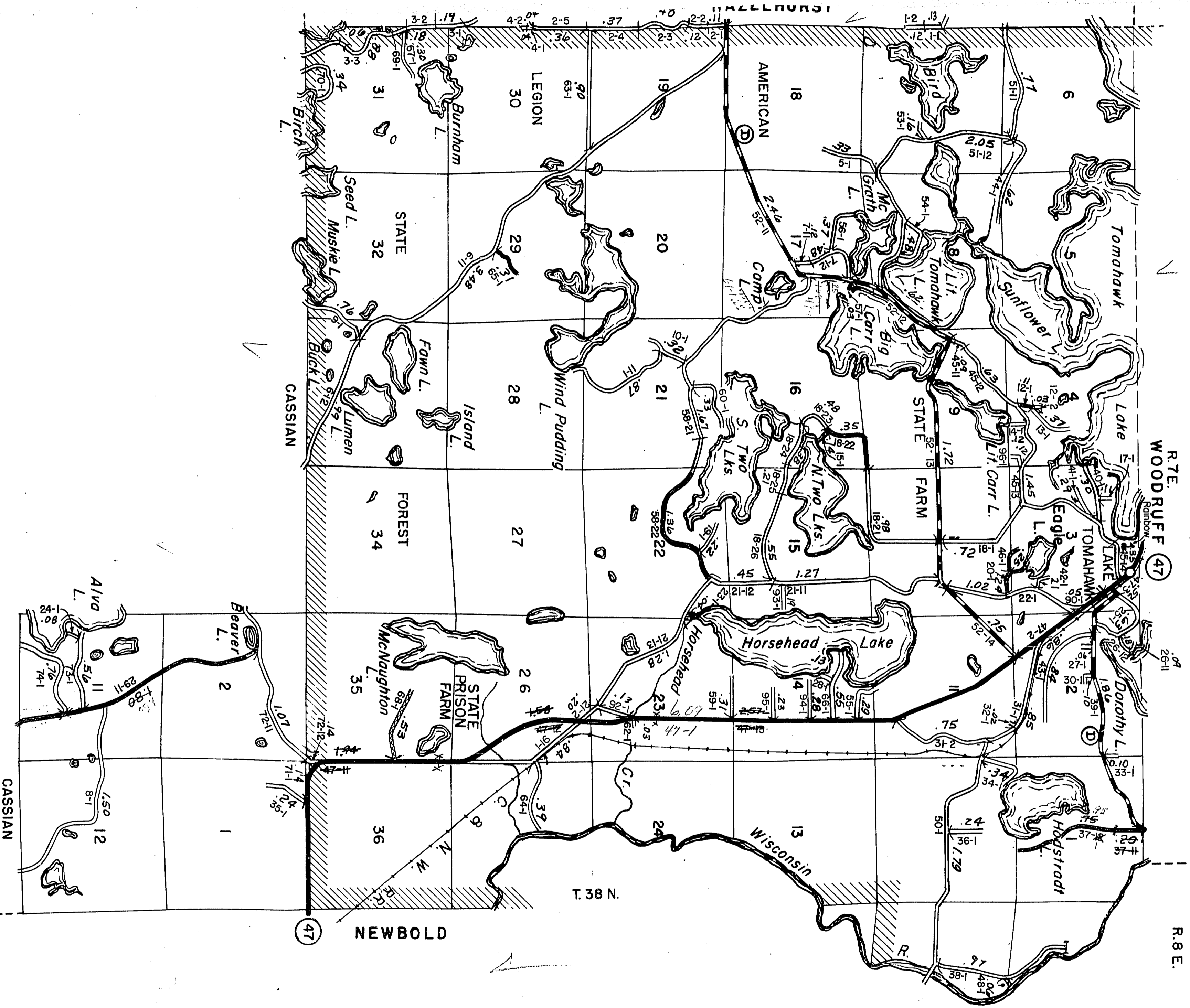

The last assigned road number is 100