

RETURN THIS PLAT

STATE HIGHWAY COMM. OF WISCONSIN
TOWN PLAT RECORD

Town - PINE LAKE County - ONEIDA (43-014)

Date of Last Cert.	State Trunks	County Trunks	Local Roads	Symbols
1-1-64	6.24	5.56	56.40	Sch. 1
1-1-65	6.24	5.56	56.40	Cem. 1
1-1-66	6.24	5.56	56.98	
1-1-67	6.24	5.56	56.98	
1-1-68	6.33	5.68	55.08	
1-1-69	6.51	5.56	55.83	

Gross Mileage - Deduction for Intersections - Net Pay Mileage
56.98 43 56.55

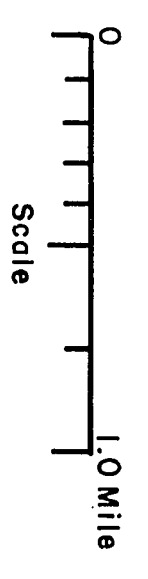

Certified as Correct By Town Chairmen: *Ed McMillan*

T 37 N
S 17 W

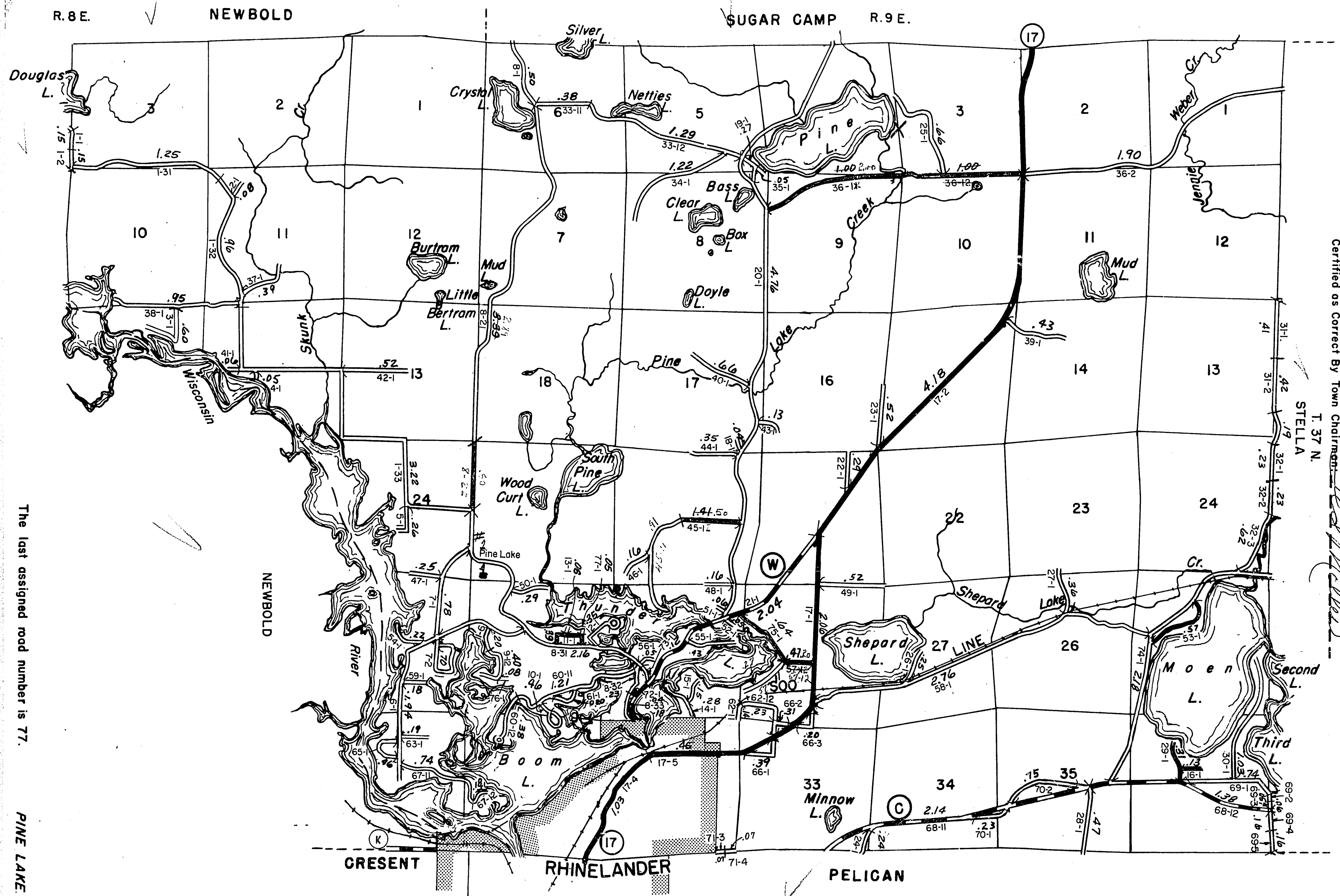

R. 8 E. NEWBOLD

SUGAR CAMP R. 9 E.

CRESENT RHINELANDER PELICAN

The last assigned road number is 77.

PINE LAKE